

## **CONDITIONS OF USE FOR THIS PDF**

The images contained within this PDF may be used for private study, scholarship, and research only. They may not be published in print, posted on the internet, or exhibited. They may not be donated, sold, or otherwise transferred to another individual or repository without the written permission of The Museum of Modern Art Archives.

When publication is intended, publication-quality images must be obtained from SCALA Group, the Museum's agent for licensing and distribution of images to outside publishers and researchers.

If you wish to quote any of this material in a publication, an application for permission to publish must be submitted to the MoMA Archives. This stipulation also applies to dissertations and theses. All references to materials should cite the archival collection and folder, and acknowledge "The Museum of Modern Art Archives, New York."

Whether publishing an image or quoting text, you are responsible for obtaining any consents or permissions which may be necessary in connection with any use of the archival materials, including, without limitation, any necessary authorizations from the copyright holder thereof or from any individual depicted therein.

In requesting and accepting this reproduction, you are agreeing to indemnify and hold harmless The Museum of Modern Art, its agents and employees against all claims, demands, costs and expenses incurred by copyright infringement or any other legal or regulatory cause of action arising from the use of this material.

### **NOTICE: WARNING CONCERNING COPYRIGHT RESTRICTIONS**

The copyright law of the United States (Title 17, United States Code) governs the making of photocopies or other reproductions of copyrighted material. Under certain conditions specified in the law, libraries and archives are authorized to furnish a photocopy or other reproduction. One of these specified conditions is that the photocopy or reproduction is not to be "used for any purpose other than private study, scholarship, or research." If a user makes a request for, or later uses, a photocopy or reproduction for purposes in excess of "fair use," that user may be liable for copyright infringement.

FOR STUDY PURPOSES ONLY. NOT FOR REPRODUCTION.

The Museum of Modern Art Archives, NY	Collection:	Series.Folder:
	RDH	VIII.50

Damage - Do Not Film

THE MUSEUM OF MODERN ART

Miss C —

Eddie has just rec'd our  
proj. order on Indian show boxes.

Says \$8000 will cover no  
more than material alone!!

Also our figure of 8 boxes is  
not sufficient as he has  
started on the idea of making

4 boxes to hold records alone!

Jim asked him to hold up the  
mural boxes as that seems  
like a big no. for them to me.

Plywood, screws, etc. he  
says increases cost of  
boxes.

MM

FOR STUDY PURPOSES ONLY. NOT FOR REPRODUCTION.

The Museum of Modern Art Archives, NY	Collection:	Series.Folder:
	RDH	VIII.50

Damage - Do Not File

THE MUSEUM OF MODERN ART

Miss C

To:

From:

Eddie, after I told him your \$1500<sup>00</sup> bid on the Indian type, has figured out his own estimate:

Material — \$141.00

Labor — 125.00

\$266.00

According to him, this is cutting the partitions & trays in type down to a minimum.

MW

He figures the spural type alone as \$55<sup>00</sup>, not including labor.

FOR STUDY PURPOSES ONLY. NOT FOR REPRODUCTION.

The Museum of Modern Art Archives, NY	Collection:	Series.Folder:
	RDH	VIII.50

DAMAGE - Do Not Film

THE MUSEUM OF MODERN ART

To:

From:

$\frac{3}{8}$ " plywood -  
7¢ sq. ft. (4' x 8')  
[~~\$~~69.00 per 1000 sq. ft.]

$\frac{1}{4}$ " plywood -  
6¢ sq. ft. (1 good side)  
7¢ sq. ft. (2 good sides)

Regular Boards for boxes -

1' x 6" plywood = 3¢

1' x 4" " =  $2\frac{3}{4}$ ¢

FOR STUDY PURPOSES ONLY. NOT FOR REPRODUCTION.

The Museum of Modern Art Archives, NY	Collection:	Series.Folder:
	RDH	VIII.50

# THE MUSEUM OF MODERN ART

Date May 27, 1941

To: MISS DUDLEY  
Miss Dudley  
From: MISS COURTER

Re: INDIAN REPAIRS FOR TOUR

Dear Dad:

Whom do we write to about the broken toe on the Kachina doll? The Indian Arts and Crafts Board, I know, but I suppose someone besides René d'Harnoncourt could advise us about its replacement.

Natural History or some other Museum to use as part of a study collection. Keep it as is until we have word from you. We are terribly

Also will you let me know if we could offer the cast of the crocodile head which you have made for the South Seas Show to the Natural History Museum. Milwaukee Public Museum and queried the

above also. Have asked if Milwaukee would like to have Cleveland to make the repair or if they would prefer to have the piece returned and make the repair themselves. Also suggested that they notify their insurers, as they preferred to maintain their own insurance. When reply is received from Milwaukee, we will notify Cleveland of decision.

*Elaine*

FOR STUDY PURPOSES ONLY. NOT FOR REPRODUCTION.

The Museum of Modern Art Archives, NY	Collection:	Series.Folder:
	RDH	VIII.50

*Damage - Do Not Film*

# THE MUSEUM OF MODERN ART

*VP*

Date May 12, 1947

cc: Circulating Exhibitions

To: Mr. d'Harnoncourt

Re: \_\_\_\_\_

From: Miss Dudley

The following damage and circumstances surrounding it have been reported to us by the Cleveland Museum of Art, where the Indian exhibition has just closed:

Dear Rene:

When the Circulating Exhibitions Department assembly room was moved from the mezzanine, the following were turned over to this department:

Cast of Gorget, woodpecker pattern (illustrated in Indian Art of the U.S. page 85)

Cast of Pipe, Monitor (similar to one illustrated in Indian Art of the U.S., page 65)

Will you please let me know if we should offer these to Natural History or some other Museum to use as part of a study collection.

Also will you let me know if we could offer the cast of the crocodile head which you have made for the South Seas Show to the Natural History Museum.

*[Faint, mostly illegible text at the bottom of the page, likely bleed-through from the reverse side.]*

*Ulin*

FOR STUDY PURPOSES ONLY. NOT FOR REPRODUCTION.

The Museum of Modern Art Archives, NY	Collection:	Series.Folder:
	RDH	VIII.50

# THE MUSEUM OF MODERN ART

Date Feb. 16, 1942

To: Miss Dudley

Re: Indian exhibition damage

From: Miss Courter

The following damage and circumstances surrounding it have been reported to us by The Cleveland Museum of Art, where the Indian exhibition has just closed:

"Tragedy occurred yesterday morning when the Indian show was being dismantled, and we have all been very much disturbed. In removing the pipe - your number 40.5072a (Milwaukee 31491a) - from the wall, the end - that is the pipe part itself - which is loose as you probably remember, fell and broke. This belongs to the Milwaukee Public Museum and you can identify it in our photograph 41C 19676.

"It can be repaired, but it has upset us considerably. It broke into four pieces, and there are two chips which we have wrapped up with them. The parts fit together - the breaks are straight - and the chips can be fitted in. One of our most careful workers in the Superintendent's department removed it from the wall. I have never known him to be careless, and it must have slipped even though it had been wired to the stem. I have held this out of the shipment and shall keep it as is until we have word from you. We are terribly sorry and cannot tell you how much we regret having had anything happen to any of the pieces while here."

We have reported this damage to the Milwaukee Public Museum and quoted the above also. Have asked if Milwaukee would like to have Cleveland to make the repair or if they would prefer to have the piece returned and make the repair themselves. Also suggested that they notify their insurers, as they preferred to maintain their own insurance. When reply is received from Milwaukee, we will notify Cleveland of decision.

To: Miss Dudley  
 From: K. Goodruff

The Cleveland Museum has asked us to show them the original. They say they may have had it and ask for time to do so. I am not sure of the original.

*Ellis*

THE MUSEUM OF MODERN ART

Date: Feb. 9, 1942

Re: Indian exhibit

FOR STUDY PURPOSES ONLY. NOT FOR REPRODUCTION.

The Museum of Modern Art Archives, NY	Collection:	Series.Folder:
	RDH	VIII.50

# THE MUSEUM OF MODERN ART

Date Feb. 5, 1942

To: Miss Smith

Re: Indian catalogs

From: M. Woodruff

The Cleveland Museum has informed us that 64 Indian catalogs were sent along to them from the Lyman Allyn Museum, New London, Conn., with the Indian show. They say they may have need of a few of these New London catalogs and asked if it was o.k. for them to do so. We have said it was all right, but to let us know how many of the original 64 they do use, for your records.

*M. Woodruff*

to mark one doll 41.225a and the other 41.225b. I hope this is alright.

In the accompanying box is an elk's tooth, which the New London exhibit/or reports to us came off when the exhibition was unpacked there and was put away for safe keeping, and not found until recently. Mrs. Lyman says that it came from one of the Indian masks. Probably you would prefer to keep it until the show is returned here.

*M. Woodruff*  
 OF MODERN ART

Date Feb. 5, 1942  
 Re: Indian cat.

*Handwritten notes:*  
 Cleveland; Obj. starts in glass box, etc. mounted and sprayed and painted with white soiled and worn like leather etc. on Feb. 9th by person with special delivery. Could you arrange for the show to arrive, in order that they be ready for it. No later than the show is held in the. Thank you.

FOR STUDY PURPOSES ONLY. NOT FOR REPRODUCTION.

The Museum of Modern Art Archives, NY	Collection:	Series.Folder:
	RDH	VIII.50

# THE MUSEUM OF MODERN ART

Date Feb. 5, 1942

To: Miss Dudley

Re: Indian Traveling Exhibition

From: M. Woodruff

February 5, 1942

The Hohokam pottery jar, #40.5231, was broken in transit from New London, Conn. to Cleveland, O. (chiefly along old breaks which had been patched). Miss Courter notified the lender, the Los Angeles County Museum, of this damage, also sending a photograph of the jar in its present state. Mr. McKinney requests that we withdraw the jar from our show and send back to him for repair.

We are, therefore, notifying Cleveland to pack the jar very carefully without disturbing too greatly the damaged section, and ship it Railway Express Prepaid to Mr. McKinney at the Los Angeles County Museum. We have ourselves already reported the damage to Rathbone.

Cleveland also reported to us that their were 8 Kachina dolls rather than 7 in the show, there being 2 with the number 41.225. After Cleveland sent us a sketch of the extra doll, Miss Allen checked and found that there are actually 2 dolls with the number 41.225, one intended to sit upon the shoulders of the other. To eliminate this confusion among other exhibitors, we have asked Cleveland to mark one doll 41.225a and the other 41.225b. I hope this is alright.

In the accompanying box is an elk's tooth, which the New London exhibit/or reports to us came off when the exhibition was unpacked there and was put away for safe keeping, and not found until recently. Mrs. Lyman says that it came from one of the Indian masks. Probably you would prefer to keep it until the show is returned here.

*M. Woodruff*

OF MODERN ART

Date Feb. 5, 1942

Re: Indian Exhibition

*[Faint, mostly illegible text, possibly bleed-through from the reverse side of the page]*

FOR STUDY PURPOSES ONLY. NOT FOR REPRODUCTION.

The Museum of Modern Art Archives, NY	Collection:	Series.Folder:
	RDH	VIII . 50

# THE MUSEUM OF MODERN ART

Date Feb. 4, 1942

To: Mr. Baxter

Re: Indian Exh.

From: M. Woodruff

The Indian show is at present in Cleveland, O., where it closes Feb. 8th. We wish to have the labels in this show mounted and sprayed and supplied with corner eyelets, as the present cellophane is soiled and worn. Miss Courter has asked Cleveland to return the labels to us on Feb. 9th by parcel post special delivery, so that they should be here on the 11th. Could you arrange for the shops to handle these immediately upon their arrival, in order that they be ready for us to ship on to the next exhibitor by the 16th? There are about 125 labels in all. The project order for the job is #1380. Thank you.

*M. Woodruff*

as Mr. Finley has anxious to know what should be done with the photographs.

Very sincerely,

Mrs. Charles de Young Elkus  
154 - 21st Avenue  
San Francisco, Calif.

EC:ljs

THE MUSEUM OF MODERN ART

To: Mrs. Charles de Young Elkus  
From: M. Woodruff

on Feb. 4, 1942, Mrs. Elkus will come to the Museum to see the photographs of the Indian show. She will bring with her a photograph of the Indian show in Cleveland, Ohio, which she will give to the Museum. She will also bring with her a photograph of the Indian show in Cleveland, Ohio, which she will give to the Museum. She will also bring with her a photograph of the Indian show in Cleveland, Ohio, which she will give to the Museum.

Very sincerely,  
M. Woodruff  
Feb 4 1942

FOR STUDY PURPOSES ONLY. NOT FOR REPRODUCTION.

The Museum of Modern Art Archives, NY	Collection:	Series.Folder:
	RDH	VIII.50

Indian  
Heiders

Yellow

Elkus

EXHIBITION OF INDIAN ART OF THE UNITED STATES: in catalog

February 2, 1942

THE MUSEUM OF MODERN ART

Dear Mrs. Elkus:

The National Gallery of Art has just written us that they were unable to schedule their Indian exhibition as they had hoped, in January and February. I wonder if you have other plans for the watercolor or whether you would let us include it again in the traveling Indian exhibition. Our show is scheduled to open at the Joslyn Memorial Museum, Omaha, Nebraska, on February 18th. I am sure the National Gallery will be glad to ship the painting there to join the rest of the exhibition.

I shall appreciate it if you would write me at your earliest convenience, as Mr. Finley has anxious to know what should be done with the watercolor.

Very sincerely,

Mrs. Charles de Young Elkus  
154 - 21st Avenue  
San Francisco, Calif.

EC:ljs

To: Frank  
From: jls

... will see to the  
... shipping to  
... of the above  
... colors  
... photograph of the  
... photograph of  
... photograph of  
... and Milwaukee

Very sincerely,  
L.H.N.H.  
L.H.N.H.  
L.H.N.H.  
L.H.N.H.

FOR STUDY PURPOSES ONLY. NOT FOR REPRODUCTION.

The Museum of Modern Art Archives, NY	Collection:	Series.Folder:
	RDH	VIII.50

# THE MUSEUM OF MODERN ART

Date Sept. 30, 1941

To: Frank Quinn

Re: Indian loans to Worcester

From: Miss Woodruff

photographs

On Oct. 3rd (Friday), Budworth will come to the Museum to pick up several articles they are shipping to Worcester for the Indian show there:

Cast of the Adena Man  
 2 Large Oklahoma pipes - casts  
 Enlarged photograph of the Adena Man  
 Strip depicting Hohokam figures  
 Enlarged photograph of deer head

We will ship the Hopi murals and Milwaukee House Mask ourselves.

- 41-570 Page 100 - fig. 51 - rima basket.
- 41-180 Page 144 - Cheyenne parfleche. ✓
- 40-5152 Page 151 - Calumet or Medicine Pipe ✓
- 40-5192 Page 152 - Ribbonwork cloak. ✓
- 41-147 Page 154 - Birch bark box. - Fig. 69 - AMNH - 291744 ✓
- 40-5158 Page 157 - Wooden mask, Iroquois. (40.5153) 291710 - AMNH. ✓
- 41-140 Page 158 - Birch Bark box, Cree. (41.146) 291744 (CWC-1-P-AMNH)
- 41-511 Page 165 - Wooden Figure, Salish (41.511) - F.M. N.H.M. - 291491-13. (10/1965)
- 41-759 Page 167 - "The Bear Mother" - AMNH - 291570-39 ✓
- 41-513 Page 169 - Wooden Mask, Haida. ✓
- 40-5207 Page 170 - Wooden Mask, Haida. Rev. ✓
- 41-508 Page 172 - Wooden Mask, Kwakiutl. AMNH - 291513-36 ✓
- 41-298 Page 173 - Wooden mask, Tsimshian - Rev. ✓
- 41-540 Page 180 - Horn dish. ✓
- 40-5208 Page 183 - Wooden Rattle. - Rev. ✓
- 40-5090 Page 187 - Wooden mask, Southwestern Alaska - Heje - 22588
- 40-5092 Page 191 - Wooden Mask, Southwestern Alaska (40.5092) - 22567
- 41-442 Page 199 - Eskimo ivory toy, bear.
- Page 201 - Navaho silverwork from Arizona and New Mexico
- 41-776 Page 207 - Seminole cotton patchwork from Florida - after-skiing suit. Kesting 105
- 41-312 Page 208 - "The Delight Makers", gouache by Fred Kabotie. - Rev

41-580

41-439 - Seal Mask - P. 189

40-5095 - Mask - P. 188

40-5097 - Mask - P. 192

40-5088 - Mask - P. 192

FOR STUDY PURPOSES ONLY. NOT FOR REPRODUCTION.

The Museum of Modern Art Archives, NY	Collection:	Series.Folder:
	RDH	VIII.50

# THE MUSEUM OF MODERN ART

REPRODUCTION OF INDIAN ART OF THE UNITED STATES: in catalog

Date Aug. 18, 1941

To: Miss Hearn

Re: Indian Art of the U.S.

From: Miss Woodruff

photographs

Attached is a list of objects in the Indian show which are reproduced in the catalog and which we are using in our circulating show. ~~XXXXXX~~ We will be wanting a good many of these for re-sale in conjunction with our traveling show. Therefore, would you find out how many of these are available here at the museum and, if necessary, order about 2 each of those which have to be obtained from other institutions. Please let me know where duplicates of the various photographs may be obtained. We will have to have a good many of these photographs by the middle of September. Thank you.

- Page 104 - Pottery bowl, Washoe Culture, New Mexico  
Page 105 - Pottery bowl.  
Page 111 - Haral painting, ~~40.5153~~  
Page 112 - ~~40.5153~~  
Page 128 - Dune Mask - Auni  
Page 130 - 2 war gods, Auni  
Page 135 - Apache basket.
- 41-398 Page 138 - Fig. 51 - Pima basket.  
41-160 Page 144 - Cheyenne parfleche.  
40-5152 Page 151 - Calumet or Medicine Pipe  
40-5192 Page 152 - Ribbonwork cloak.  
41-147 Page 154 - Birch bark box. - Fig. 69 - AMNH - 291744  
40-5153 Page 157 - Wooden mask, Iroquois. (40.5153) 291710 - AMNH.  
41-146 Page 158 - Birch Bark box, Cree. (41.146) 291744 (CWC-1-P-AMNH)  
41-511 Page 165 - Wooden Figure, Salish (41.511) - A.M. N.H.M. - 291491-13. (10/1946)  
41-759 Page 167 - "The Bear Mother" - AMNH - 291570-39  
41-513 Page 169 - Wooden Mask, Haida.  
40-5207 Page 170 - Wooden Mask, Haida. Rev.  
41-508 Page 172 - Wooden Mask, Kwakiutl. AMNH - 291513-36  
41-298 Page 173 - Wooden mask, Tsimshian - Ru  
41-540 Page 180 - Horn dish.  
40-5208 Page 183 - Wooden Rattle. - Rev.  
40-5090 Page 187 - Wooden mask, Southwestern Alaska - Heye - 22588  
40-5042 Page 191 - Wooden Mask, Southwestern Alaska (40.5092) - 22567  
41-442 Page 199 - Eskimo ivory toy, bear.  
Page 201 - Navaho silverwork from Arizona and New Mexico  
41-776 Page 207 - Seminole cotton patchwork from Florida - after-skiing suit. Kerting 105  
41-312 Page 208 - "The Delight Makers", gouache by Fred Kabotie. - Rev

41-580

40-509 - SEAL MADE - P. 189

40-5095 - MASK - P. 188

40-5097 - MASK - P. 192

40-5088 - P. 192

FOR STUDY PURPOSES ONLY. NOT FOR REPRODUCTION.

The Museum of Modern Art Archives, NY	Collection:	Series.Folder:
	RDH	VIII.50

REPRODUCTIONS OF INDIAN ART OF THE UNITED STATES; in catalog

- 41.440 Page 12 - Fig. 2 - Seneca mask. (41.440) ✓  
 40.492 Page 23 - Kiva mural ✓  
 41.497 Page 25 - Pictograph ✓  
 41.108 Page 26 - Acoma pottery jar (41.108) ✓  
 40.4497 Page 32 - Mohave pottery bottle (40.4497) ✓  
 40.5206 Page 43 - Wooden mask, Eskimo (40.5206) ✓  
 41.309 Page 56 - Stone totem pole. (41.309) ✓ ✓  
 40.5107 Page 58 - Ivory drum handle (40.5107) ✓  
 41.248 Page 65 - Stone Pipe from Virginia - ✓ - ?  
 41.244 Page 66 - Banner stone ✓  
 41.245 Page 67 - Bird stones *Bottom one = Heye - 22281; p82 = 20815*  
 41.682 Page 68 - Bird stone pipe from Tremper Mound - AMNH - 291262  
 41.683 Page 69 - Stone pipe from Tremper Mound ✓  
 41.682 Page 72 - Stone pipe from Adena Mound - A.M. of Nat. H. - 291283 - 38 ✓  
 41.259-260 Page 82 & 83 - Shell gorgets (2). p. 83 = 22266 ✓  
 40.5198 Page 97 - Burden Basket (Fig. 25) ✓  
 41.165 Page 103 - Shell ornament - frog design. ✓  
 41.469 Page 104 - Pottery bowl, Mimbres Culture, New Mexico ✓  
 41.5201 Page 108 - Pottery bowl. ✓  
 40.4922 Page 111 - Mural painting. *Heysen - 113*  
 40.4921 Page 112 - " " *Heysen - 107*  
 41.71 Page 129 - Dance Mask - Zuni ✓  
 1. Page 130 - War gods, Zuni - *One only*  
 40.513 Page 136 - Apache basket. ✓  
 41.398 Page 138 - Fig. 51 - Pima basket. ✓  
 41.180 Page 144 - Cheyenne parfleche. ✓  
 40.5152 Page 151 - Calumet or Medicine Pipe ✓  
 40.5192 Page 152 - Ribbonwork cloak. ✓  
 41.147 Page 154 - Birch bark box. - Fig. 69 - AMNH - 291744 ✓  
 40.5453 Page 157 - Wooden mask, Iroquois. (40.5153) 291710 - AMNH. ✓  
 41.146 Page 158 - Birch Bark box, Cree. (41.146) 291744 (CWC - 1 - P - AMNH)  
 41.54 Page 165 - Wooden Figure, Salish (41.511) - A.M. Nat. H. - 291491 - 13. (10/1916)  
 41.759 Page 167 - "The Bear Mother" - AMNH - 291570 - 39 ✓  
 41.513 Page 169 - Wooden Mask, Haida. ✓  
 40.5207 Page 170 - Wooden Mask, Haida. *Rev.* ✓  
 41.508 Page 172 - Wooden Mask, Kwakiutl. AMNH - 291513 - 36 ✓  
 41.298 Page 173 - Wooden mask, Tsimshian - *Rev.* ✓  
 41.540 Page 180 - Horn dish. ✓  
 40.5208 Page 183 - Wooden Rattle. - *Rev.* ✓  
 40.5090 Page 187 - Wooden mask, Southwestern Alaska - *Heysen* - 22588  
 40.5042 Page 191 - Wooden Mask, Southwestern Alaska (40.5092) - 22567  
 41.442 Page 199 - Eskimo ivory toy, bear.  
 Page 201 - Navaho silverwork from Arizona and New Mexico  
 41.776 Page 207 - Seminole cotton patchwork from Florida - after-skiing suit. *Heysen 105*  
 41.312 Page 208 - "The Delight Makers", gouache by Fred Kabotie. - *Rev.*

41.580

41.459 - MAKE - P. 189

40.5095 - MAKE - P. 188

40.5099 - MAKE - P. 192

40.5088 - MAKE - P. 192

FOR STUDY PURPOSES ONLY. NOT FOR REPRODUCTION.

The Museum of Modern Art Archives, NY	Collection:	Series.Folder:
	RDH	VIII.50

(6 Photos)

(6)

Indian art

Instal (4)

Indian works (2)

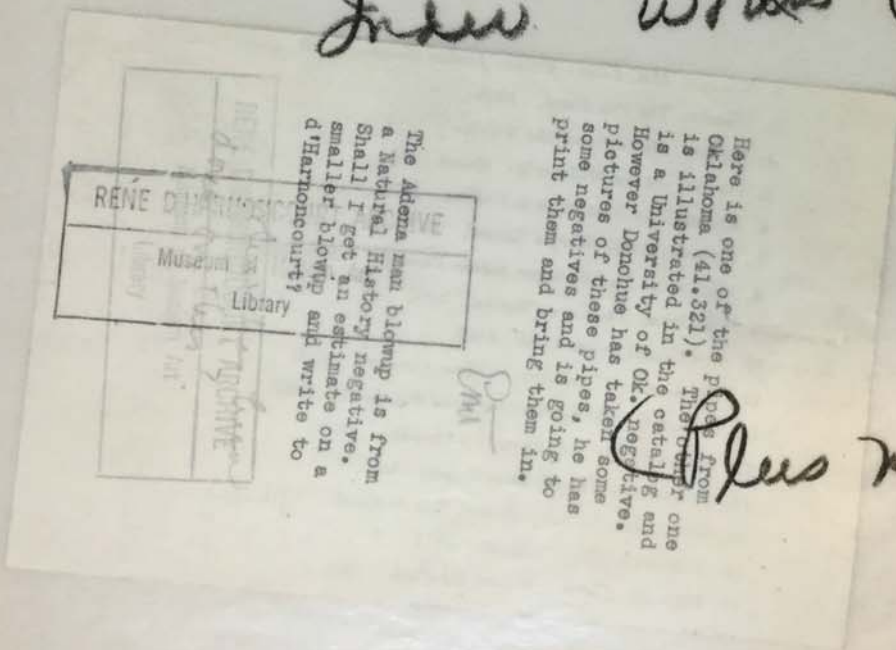

(Plus note)

FOR STUDY PURPOSES ONLY. NOT FOR REPRODUCTION.

The Museum of Modern Art Archives, NY	Collection:	Series.Folder:
	RDH	VIII.50

Here is one of the pipes from Oklahoma (41.321). The other one is illustrated in the catalog and is a University of Ok. negative. However Donohue has taken some pictures of these pipes, he has some negatives and is going to print them and bring them in.

*Emt*

The Adena man blowup is from a Natural History negative. Shall I get an estimate on a smaller blowup and write to d'Harnoncourt?

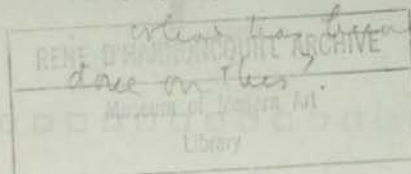

FOR STUDY PURPOSES ONLY. NOT FOR REPRODUCTION.

The Museum of Modern Art Archives, NY	Collection:	Series.Folder:
	RDH	VIII . 50

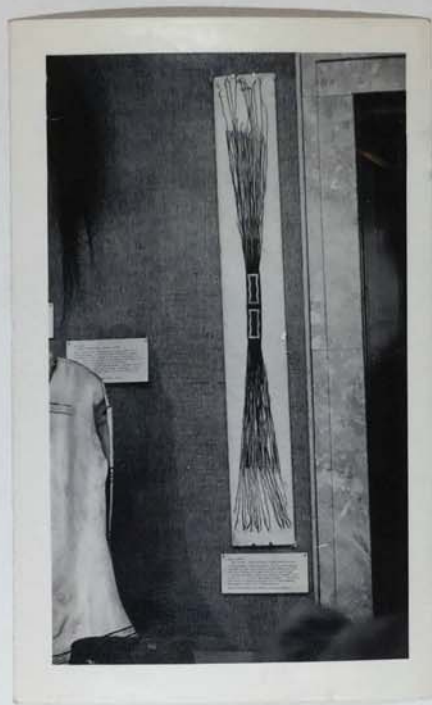

FOR STUDY PURPOSES ONLY. NOT FOR REPRODUCTION.

The Museum of Modern Art Archives, NY	Collection:	Series.Folder:
	RDH	VIII . 50



FOR STUDY PURPOSES ONLY. NOT FOR REPRODUCTION.

The Museum of Modern Art Archives, NY	Collection:	Series.Folder:
	RDH	VIII.50



FOR STUDY PURPOSES ONLY. NOT FOR REPRODUCTION.

The Museum of Modern Art Archives, NY	Collection:	Series.Folder:
	RDH	VIII.50

A STONE PIPE, red bauxite  
Spiro, Le Flore County, Okla.

Excavated 1936 by Forrest Clements

Lent by the University of Oklahoma

INDIAN ART OF THE UNITED STATES

Jan. 22, 1941-Apr. 20, 1941

The Museum of Modern Art  
11 West 53 St., New York

RENÉ D'HARNOUCOURT ARCHIVE

Museum of Modern Art  
Library

Photographed for The Museum of Modern Art  
by Seichi Sunami. If reproduced, credit  
must be given The Museum of Modern Art.

S-3053

FOR STUDY PURPOSES ONLY. NOT FOR REPRODUCTION.

The Museum of Modern Art Archives, NY	Collection:	Series.Folder:
	RDH	VIII.50



FOR STUDY PURPOSES ONLY. NOT FOR REPRODUCTION.

The Museum of Modern Art Archives, NY	Collection:	Series.Folder:
	RDH	VIII.50

This photo by the  
New Mexico State Tourist Bureau  
Capitol Building  
Santa Fe, New Mexico



Photograph by  
Wyatt Davis  
Canyon Rd  
Santa Fe, N.M.

FOR STUDY PURPOSES ONLY. NOT FOR REPRODUCTION.

The Museum of Modern Art Archives, NY	Collection:	Series.Folder:
	RDH	VIII.50



FOR STUDY PURPOSES ONLY. NOT FOR REPRODUCTION.

The Museum of Modern Art Archives, NY	Collection:	Series.Folder:
	RDH	VIII.50



INDIAN ART OF THE UNITED STATES - Installation  
photograph at the Lyman-Allyn Museum,  
New London, Conn.  
  
Circulated by The Museum of Modern Art, N.Y.C.

Northwest  
Duplicate

RENE D'AMICO GIFT ARCHIVE  
Museum of Modern Art  
Library



FOR STUDY PURPOSES ONLY. NOT FOR REPRODUCTION.

The Museum of Modern Art Archives, NY	Collection:	Series.Folder:
	RDH	VIII.50

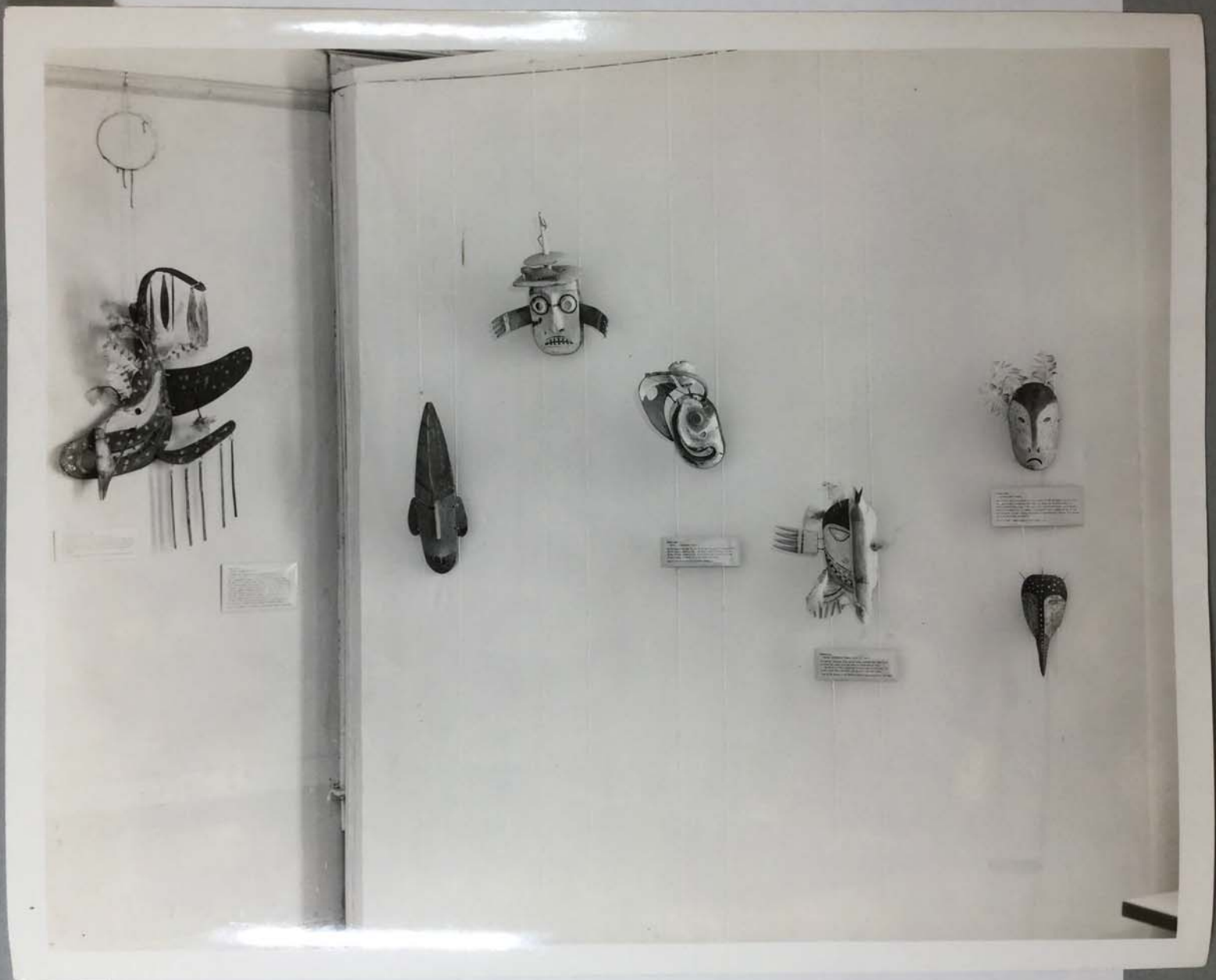

FOR STUDY PURPOSES ONLY. NOT FOR REPRODUCTION.

The Museum of Modern Art Archives, NY	Collection:	Series.Folder:
	RDH	VIII.50



This Photo by The  
New Mexico State Tourist Bureau  
Capitol Building  
Santa Fe, New Mexico

RENÉ D'HARNONCOURT ARCHIVE  
Museum of Modern Art  
Library



Photograph by  
Wyatt Davis  
Canyon Rd.  
Santa Fe, N. M.

FOR STUDY PURPOSES ONLY. NOT FOR REPRODUCTION.

The Museum of Modern Art Archives, NY	Collection:	Series.Folder:
	RDH	VIII . 50

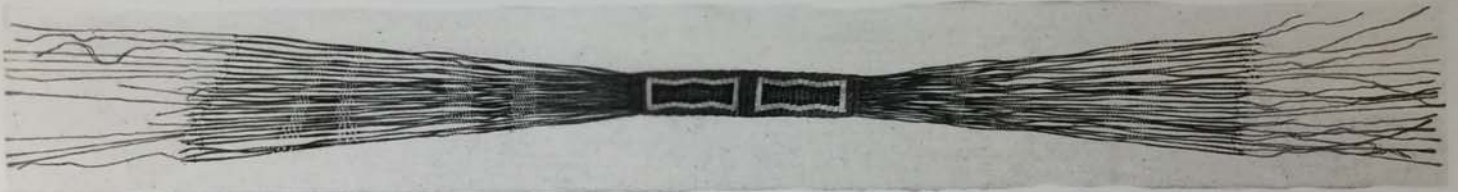

FOR STUDY PURPOSES ONLY. NOT FOR REPRODUCTION.

The Museum of Modern Art Archives, NY	Collection:	Series.Folder:
	RDH	VIII. 50



MILWAUKEE PUBLIC MUSEUM

All rights to the use of this photograph are reserved by the Museum.

It may be reproduced only under the following conditions:

1. *Written consent for the reproduction must be obtained from the Museum.*
2. It must not be sold, rented or leased to others.
3. The following credit must be printed under each reproduction so authorized.

"Milwaukee Public Museum Photo"

BY ORDER OF THE BOARD OF TRUSTEES

Negative No. 74162

MILWAUKEE PUBLIC MUSEUM ARCHIVE  
Museum of Modern Art  
Library

The Museum of Modern Art Archives, NY	Collection:	Series.Folder:
	RDH	VIII.50

10" sq. Pedestal " long

1 - This is an estimate  
of the masonry feet

2 -

3 - of the prehistoric - 35'

4 - the Hopi murals 83'3" craft.

5 - 118'3"

6 - than Ames asked 5 - m.f.  
for for Gallup, New Mexico

pedestal fee

adena nam 4'0" x 8'0"

Hopi Mural

Space 23'6" x 14'8".

allow room to  
walk around.



21  
12  
12  
1310  
8  
12  
10 5  
15  
-----  
83'3"

FOR STUDY PURPOSES ONLY. NOT FOR REPRODUCTION.

The Museum of Modern Art Archives, NY	Collection:	Series.Folder:
	RDH	VIII.50

Cases  
 prehistoric  
 1 - Pedestal 10" sq.  
 2 -  
 3 -  
 4 -  
 5 -  
 6 -

Unique Ptg. & Sta. Co., Inc. - No. 420

**TELEPHONE MESSAGE**

Date \_\_\_\_\_

For Emu

By \_\_\_\_\_

Phone \_\_\_\_\_

Time \_\_\_\_\_

Remarks  
What does this all mean?

Rec'd by \_\_\_\_\_

11" long

0.2 ft.

35 - n.f.

pedestal  
 adena nam 4'0" x 8'0"

Hopi Mural

Space 23'6" x 14'8".

allow room to walk around.

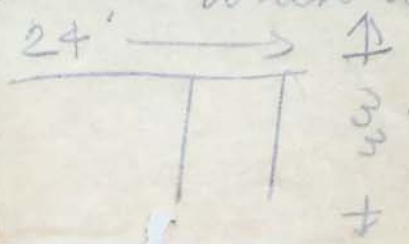

21  
 12  
 12  
 13'0  
 8  
 12  
 10 5  
 15  
 -----  
 8'3"3"

The Museum of Modern Art Archives, NY	Collection:	Series.Folder:
	RDH	VIII.50

Pedestal <sup>10" sq.</sup> Wall Case 15" long  
 1 - 5"  
 2 - 5"  
 3 - 5"  
 4 - 5"  
 5 - 5"  
 6 - 5"

Cases  
 primitive set

30 ft.  
 35 - n.f.

pedestal 12" - sq.  
 adena nam 4'0" x 8'0"

Hopi Mural

Space 23'6" x 14'8".

allow room to  
 walk around.

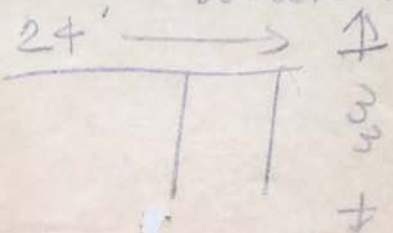

21  
 12  
 12  
 13'0  
 8  
 12  
 10 5  
 15  
 -----  
 8'3"3"

FOR STUDY PURPOSES ONLY. NOT FOR REPRODUCTION.

The Museum of Modern Art Archives, NY	Collection:	Series.Folder:
	RDH	VIII.50

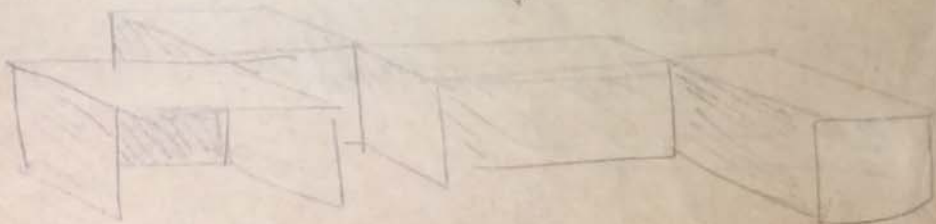
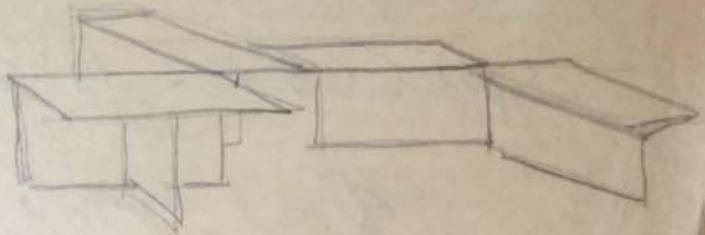
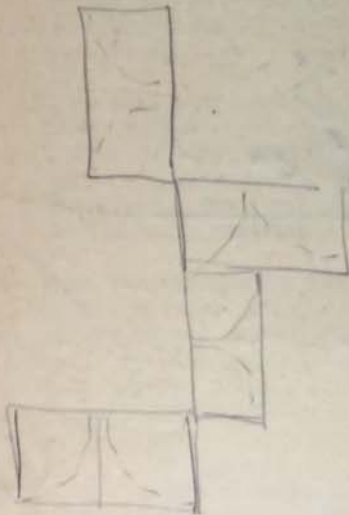
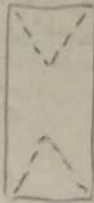
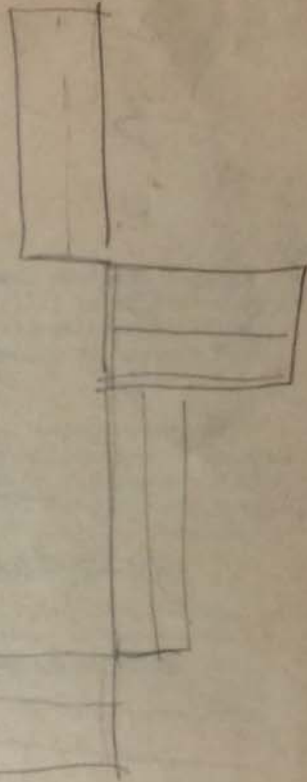
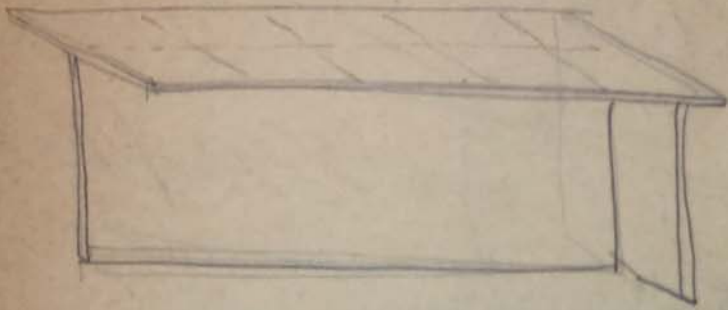

FOR STUDY PURPOSES ONLY. NOT FOR REPRODUCTION.

The Museum of Modern Art Archives, NY	Collection:	Series.Folder:
	RDH	VIII . 50

*Prices herein  
Do Not File*

FORM LETTER I

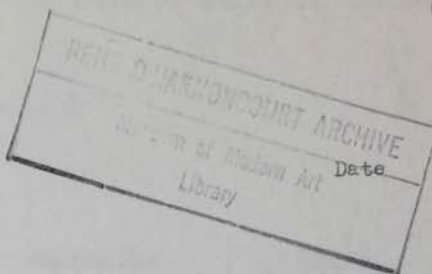

Dear .....

The exhibition, Indian Art of the United States, which you have engaged for the period ..... to ....., is scheduled to close at ..... on ..... The [entire] exhibition will, therefore, be shipped to you on ..... by Railway Express Collect.

The weight of the entire exhibition, including installation cases, Hopi Murals, "pictograph", and objects is 7376 pounds for which express charges will be approximately \$..... (Should you wish to eliminate the installation material and include only the objects, "pictograph", and murals, the weight will be 4581 pounds and transportation charges will be about \$.....)

I am enclosing an Installation List of the material in the exhibition. Under separate cover, we are sending you a drawn plan of installation. These, together with installation photographs which we are sending you under separate cover, will give you some idea of how the show is to be installed. Also enclosed, <sup>with</sup> is a plan ~~for~~ for installing the Hopi murals ~~with~~ instructions, ~~for same~~.

I am enclosing also two suggested forms of publicity release on the exhibition which you may wish to use in announcing your show. I have checked in red on the installation list, those items of which photographs may be had. To save time, we are sending you under separate cover a selection of photographs, which you will probably wish to have. The price is 50¢ each, but all prints returned to the Museum in good condition will, of course, be credited.

A copy of the Indian catalogue published at the time of the New York showing is being sent to you. We will be glad to supply you with these for sale during your showing. The catalogue sells for \$2.50 for the paper bound edition and \$3.50 for the cloth bound one. There will be a discount of 40% on orders of ten or more copies, on a consignment basis.

Several days before you are to receive the Indian exhibition, we will send you Unpacking Instructions for it. If we may assist you in any way at the present time, please let me know.

Very sincerely yours,

- Enclosures: Installation List - <sup>check pp. 2, 5, 6</sup> marked for photos      Under separate cover:
- Installation Plan - Hopi murals      Installation Plan
  - Installation Instructions - Hopi Murals      "      Photos
  - Publicity Releases - 2      Catalog

FOR STUDY PURPOSES ONLY. NOT FOR REPRODUCTION.

The Museum of Modern Art Archives, NY	Collection:	Series.Folder:
	RDH	VIII.50

*Prices herein  
Do Not File*

FORM LETTER I

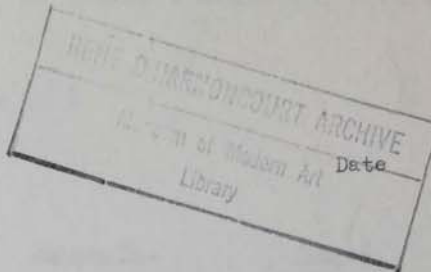

Dear .....

The exhibition, Indian Art of the United States, which you have engaged for the period ..... to ....., is scheduled to close at ..... on ..... The [entire] exhibition will, therefore, be shipped to you on ..... by Railway Express Collect.

The weight of the entire exhibition, including installation cases, Hopi Murals, "pictograph", and objects is 7376 pounds for which express charges will be approximately \$..... (Should you wish to eliminate the installation material and include only the objects, "pictograph", and murals, the weight will be 4581 pounds and transportation charges will be about \$.....)

I am enclosing an Installation List of the material in the exhibition. Under separate cover, we are sending you a drawn plan of installation. These, together with installation photographs which we are sending you under separate cover, will give you some idea of how the show is to be installed. Also enclosed, <sup>with the</sup> is a plan ~~for~~ for installing the Hopi murals ~~and~~ instructions, ~~for same~~.

I am enclosing also two suggested forms of publicity release on the exhibition which you may wish to use in announcing your show. I have checked in red on the installation list, those items of which photographs may be had. To save time, we are sending you under separate cover a selection of photographs, which you will probably wish to have. The price is 50¢ each, but all prints returned to the Museum in good condition will, of course, be credited.

A copy of the Indian catalogue published at the time of the New York showing is being sent to you. We will be glad to supply you with these for sale during your showing. The catalogue sells for \$2.50 for the paper bound edition and \$3.50 for the cloth bound one. There will be a discount of 40% on orders of ten or more copies, on a consignment basis.

Several days before you are to receive the Indian exhibition, we will send you Unpacking Instructions for it. If we may assist you in any way at the present time, please let me know.

Very sincerely yours,

Enclosures: Installation List - <sup>dash pp 2, 5, 6</sup> marked for photos      Under separate cover:  
 Installation Plan - Hopi murals      Installation Plan  
 Installation Instructions - Hopi Murals      "      Photos  
 Publicity Releases - 2      Catalog

FOR STUDY PURPOSES ONLY. NOT FOR REPRODUCTION.

The Museum of Modern Art Archives, NY	Collection:	Series.Folder:
	RDH	VIII.50

*c - photos available*

INDIAN ART OF THE UNITED STATES

An exhibition circulated by The Museum of Modern Art, New York City

INSTALLATION LIST

Poster for the exhibition

Box 7

Installation Unit                      Museum No.                      Object                      Packing Box

PREHISTORIC

Map - Ancient People of the Northern Woodlands

Carvers of the Northwest Coast

Pedestal #1                      ✓ 41.309 ✓                      Stone Totem                      Box 8 *Ray, Post. Mus. - \$200.00*

Engravers of the Arctic

Wall Case #1                      ✓ 40.5107 ✓ OK                      Ivory Drum Handle (Installed)                      Box 7 *Haye - \$10.00*

Sculptors of the East

Vertical Case #1                      ✓ 41.636 ✓ *chip fr. edge*                      Banner Stone                      Box 3 *Anderson - \$10.00*  
 41.639 ✓                      Banner Stone                      Box 3 *Anderson - \$10.00*  
 41.640 ✓                      Banner Stone                      Box 3 *Anderson - \$10.00*  
 41.641 ✓                      Banner Stone                      Box 3 *Anderson - \$10.00*  
 41.642 ✓                      Banner Stone                      Box 3 *Anderson - \$10.00*  
 ✓ 41.487 ✓ OK                      Bird Stone                      Box 3 *Pack - \$200.00*

Vertical Case #2                      41.1376 ✓                      Monitor Pipe                      Box 3 *MMA - 9/8 - \$25.00*  
 41.472 ✓ *top of pipe wings taken*                      Stone Pipe                      Box 4 *Clapline - \$25.00*  
 41.521 ✓ OK                      Stone Pipe                      Box 3 *MMA - \$50.00*  
 41.1662 ✓ OK                      Bird Pipe                      Crate 7 *Davenport - \$250.00*  
 41.1663 ✓ *OK as chip fr. bottom*                      Bird Pipe                      Box 2                      "                      - \$250.00

Wall Case #1a                      \* ✓ 41.1631 - 1638 ✓ *34, 32, 33, 35, 31, 37, 38, 36 - this last broken*                      Shell Gorgets *for each*                      Box 3 *MMA - \$16.00*  
 ✓ 41.1374 ✓                      Shell Gorgets                      Box 3 *MMA - 9/8 - \$15.00*  
 ✓ 41.1375 ✓                      Shell Gorgets                      Box 3 *MMA - 9/8 - \$15.00*

Vertical Case #3                      41.275 ✓ OK                      Female Figure Georgia (cast)                      Box 1 *Haye - \$10.00*  
 41.1485 ✓ OK                      Stone Pipe (cast)                      Box 3 *Okla - \$25.00*  
 41.1486 ✓ *old crack along neck*                      Stone Pipe (cast)                      Box 3 *Okla - \$25.00*

*See 41.321*

The Museum of Modern Art Archives, NY	Collection:	Series.Folder:
	RDH	VIII.50

-2-

Sculptors of the East (Continued)

Pedestal #3	✓ 41.1483 - OK	Adena Man	Box 3 Pacl - \$25 <sup>00</sup>
Enlarged Photo	No number	Adena Man	Box 5
On Wall	41.491 a-b	Pictograph	Special box - <sup>with Art Prof!</sup> \$1525 <sup>00</sup>

The Painters of the Southwest - Hohokam

Wall Case #2	41.672 ✓ OK	Coyote shell (Installed)	Box 7 Harmancourt \$5.00
	✓ 41.165 ✓ OK	Frog shell (large) (Installed)	Box 7 Brookings - \$5.00
	41.166 ✓ OK	Frog Shell (small) (Installed)	Box 7 Brookings \$5.00
	40.5232 - kept by L.F.	Stone Palette (Installed)	Box 7 X.F. Mus. - \$100 <sup>00</sup>

<del>Pedestal #1</del>	<del>40.5231</del>	<del>Pottery fragment</del>	<del>Box 2 L.H. Mus. - \$100.00</del>
------------------------	--------------------	-----------------------------	---------------------------------------

Hanging	✓ 40.5198 - hole in <sup>old</sup> bottom, also side	Basket	Box 7 U. of Col. \$250
---------	--	--------	------------------------

Mimbres

Vertical Case #4	✓ 41.469 - hole in bottom - <sup>old</sup> general cracks	Bowl	Box 2 Taylor Mus. - \$25
	40.5194 - <sup>old</sup> cracks	Bowl	Box 2 U. of Col. \$50.00
	40.5195 - <sup>old</sup> hole in bottom	Bowl	Box 2 U. of Col. \$50 <sup>00</sup>

Arizona Pottery

Vertical Case #5	✓ 40.5201 ✓ OK	Pottery bowl	Box 2 Morris - \$50 <sup>00</sup>
	40.5199 ✓ <sup>old</sup> neck - old patches	Pottery canteen	Box 2 Morris - \$75 <sup>00</sup>
	40.5200 ✓ OK	Pottery jar	Box 2 Morris - \$40 <sup>00</sup>

Hopi Murals

	40.4927	Dancing gourd	Mural Boxes \$800
	✓ 40.4924 a-d	Mural - Aquatic - Awatovi, Ariz.	1-5 for all murals
	40.4923 a-c	Altar, Awatovi, Ariz.	" " " "
	40.4926 a-d	Mural A - " " " "	" " " "
	✓ 40.4921 a-c	Mural B - " " " "	" " " "
	✓ 40.4925 a-d	Mural C - " " " "	" " " "
	✓ 40.4920 a-d	Mural " " " "	" " " "
	✓ 40.4922 a-c	Mural of Falling Warrior! Kawaika-a, Ariz.	" " " "

LIVING TRADITIONS

Wall map - Living Traditions

The Museum of Modern Art Archives, NY	Collection:	Series.Folder:
	RDH	VIII.50

The Pueblo Cornplanters

Introductory Panel #2

Platform #1	41.389 ✓	Kachina Doll	Box 3 A+C - \$3.00
	41.225 ✓ - hand off - <del>old</del>	Kachina Doll	Box 3 Ladd - \$3.00
	41.212 ✓	Kachina Doll	Box 3 Ladd - \$3.00
	41.201 ✓	Kachina Doll	Box 3 Ladd - \$5.00
	41.231 ✓	Kachina Doll	Box 3 Ladd - \$3.00
	41.203 ✓ pc out of head - <del>old</del>	Kachina Doll	Box 3 Ladd - \$3.00
	41.213 ✓	Kachina Doll	Box 3 Ladd - \$3.00
On Wall	✓ 41.71 ✓ <del>frags</del> - <del>old</del>	Mask	Box 4 Brooklyn - \$100.00
On Stand Provided	41.111 ✓ OK	Wedding robe	Box 5 Denver - \$40.00
	41.484 ✓ several old types some patched - <del>old</del>	Hopi blanket	Box 5 Denver - \$250.00
Platform #2	41.107 ✓ OK	Jar	Box 1 Denver - \$5.00
	41.109 ✓ OK	San Ildefonso bowl	Box 1 Douglas - \$25.00
	41.181 ✓ chipalong lip - <del>old</del>	San Ildefonso bowl	Box 1 Denver - \$50.00
Vertical Case #6	41.153 ✓ <del>cracked &amp; repd.</del> - <del>old</del>	Hopi tile	Box 4 Denver - \$1.00
	41.152 ✓ " " " - <del>old</del>	Hopi tile	Box 4 Denver - \$1.00
	41.157 ✓	Hopi tile	Box 4 Denver - \$1.00
	41.154 ✓	Hopi tile	Box 4 Denver - \$1.00
	41.151 ✓	Hopi tile	Box 4 Denver - \$1.00
	41.155 ✓ T-crack - <del>repd.</del> - <del>old</del>	Hopi tile	Box 4 Denver - \$1.00
	41.156 ✓ <del>cracked &amp; repd.</del> - <del>old</del>	Hopi tile	Box 4 Denver - \$1.00
	41.118 ✓ OK	Necklace, coral	Box 5 Douglas - \$40.00
	41.117 ✓ OK	Necklace, white shell	Box 5 Douglas - \$40.00
	41.116 ✓ OK	Necklace, turquoise	Box 5 Douglas - \$40.00
Platform #3	✓ 41.108 ✓ - OK	Acoma jar	Box 1 Denver - \$15.00
	41.233 ✓ - OK	Wedding jar	Box 2 A+C - \$15.00
	41.408 ✓ OK	Pottery owl	Box 2 Fisher - \$15.00
	✓ 41.175a - small wing off but hole; another missing (frags when seen)	Headdress	Box 5 Brooklyn - \$100.00 w/ headress.
Platform #4	41.167 ✓ OK - chipalong lip - <del>old</del>	Zuni jar	Box 1 Brooklyn - \$100.00
	✓ 41.172 ✓	Zuni war god	Box 3 Brooklyn - \$50.00
	41.173a+b ✓	Zuni war god	Box 3 Brooklyn - \$50.00
	41.326 ✓ OK	Zuni bowl	Box 1 - Douglas - \$20.00
On Wall	41.175b ✓	Baton	Box 3 Brooklyn - \$100.00 w/ headress.

The Navaho Shepherds

Introductory panel #3

Table Case #1	41.375 ✓ - OK	Concha belt (Installed)	Box 6 A+C - \$40.00
	41.383 a-g ✓ <del>18</del> <del>18</del> <del>18</del> <del>18</del> <del>18</del> <del>18</del> <del>18</del>	Bridle (Installed)	Box 6 A+C - \$25.00
	41.348 ✓	Button (Installed)	Box 6 A+C - \$1.00
	41.347 ✓	Button (Installed)	Box 6 A+C - \$1.00

FOR STUDY PURPOSES ONLY. NOT FOR REPRODUCTION.

The Museum of Modern Art Archives, NY	Collection:	Series.Folder:
	RDH	VIII.50

The Navaho Shepherds (Continued)

Table Case #1 (Cont'd)	41.351 ✓	Button (Installed)	Box 6 A+C - \$1.00
	41.750 ✓	Tobacco pouch (Installed)	Box 6 - Adair - \$15.00
	41.748 a-b ✓	Bridle ornaments (Installed)	Box 6 Bisher - \$5.00
	41.618 ✓	Silver bracelet (Installed)	Box 6 Bisher - \$10.00
	41.740 <del>ant</del> ✓ OK	Silver bracelet (Installed)	Box 6 Bisher - \$50.00
Box Platform Units	40.5141 ✓ - OK	Navaho blanket	Box 5 Denver - \$300.00
	40.5140 ✓ - OK	Navaho blanket	Box 5 Denver - \$100.00
	40.5143 ✓ OK	Navaho blanket	Box 5 Denver - \$300.00
	41.470 ✓ a+b OK	Navaho blanket	Box 5 Clifton - \$200.00
	41.471 ✓ OK	Navaho blanket	Box 5 Clifton - \$100.00

The Apache Mountain People

Introductory Panel #4

Table #1	✓ 40.5135 ✓ OK	Basket	Box 7 Denver - \$75.00
	41.430 a-b ✓ OK - <del>broken</del>	Fiddle	Box 7 a' Horn - \$50.00
	41.2208 ✓ OK	Basket, San Carlos Apache	Box 7 AMNH - \$35.00
	41.2210 ✓ OK	Basket Tray, San Carlos Apache	Box 7 AMNH - \$25.00

The Desert Dwellers of the Southwest

Introductory Panel #5

Table #2	41.121 ✓ OK	Wooden bowl	Box 4 Denver - \$40.00
	✓ 41.398 ✓ OK	Pima basket	Crate 7d Horn - \$25.00
	✓ 40.4497 ✓ OK	Pottery bowl	Box 2 Denver - \$20.00
	41.2209 ✓ OK	Basket bowl	Box 7 AMNH - \$20.00

The Seed Gatherers of the Far West

Introductory Panel #6

Table #3	41.516 ✓ OK (a+b)	Basket jar	Crate 7 AMNH - \$50.00
	41.553 ✓ OK	Work basket	Crate 7 AMNH - \$75.00

The Hunters of the Plains

Introductory Panel #7

The Museum of Modern Art Archives, NY	Collection:	Series.Folder:
	RDH	VIII.50

The Hunters of the Plains (Continued)

On figure and box provided	41.441 ✓ OK	Saddle	Box 4 A+C - \$15.00
On figure and box provided	41.429 ✓ OK 41.725 ✓ OK	Roach headdress Breastplate	Box 5 A+C - \$10.00 Box 4 Beaver - \$10.00
On Wall	41.785 ✓ ✓ 41.432 ✓	Quilled armbands Fan	Box 5 Tanager - \$3.00 Box 4 A+C - \$10.00
On figure and box provided	40.5152 ✓ ✓ <i>Spool of pipe shown in 2 pcs.</i>	Ceremonial pipe	Box 4 Beaver - \$5.00
On figure and box provided	40.5148 ✓ OK, 40.5150 ✓ OK 40.802 ✓ OK.	Pipe bag Pipe bag Hair ornament	Box 5 Beaver - \$15.00 Box 5 Beaver - \$ Box 5 Merritt - \$50.00
On Wall (see diagram)	41.723 ✓ ✓ 41.180 ✓ OK, 40.5126 ✓ 40.5127 ✓ 40.5079 ✓ 41.296 a-b ✓ OK <del>40.5072 a-b</del> 41.128 ✓ <i>feather pipe, bushy fringed.</i> ✓ 40.5192 ✓ OK. 41.1443 ✓ OK.	Rattle Parflache Decorated lance Decorated lance Battle axe Buckskin leggings <del>Glass pipe</del> Shield Ribbon garment Elkskin robe	Box 4 Beaver - \$15.00 Box 4 Spindler - \$50.00 Box 8 Heys - \$40.00 Box 8 Heys - \$25.00 Box 3 Heys - \$15.00 Box 5 Heys - \$50.00 <del>Box 3 Miller - \$50.00</del> Box 4 Beaver - \$50.00 Box 5 Merritt - \$50.00 Box 5 Claplin - \$200
On Wall (see diagram)	( 41.1404a ✓ ( ( 41.1404b ✓ ( ( 41.1404c ✓ ( ( 41.1404d ✓ ( (	"The Snakes let Sca- vanger through the sky hole" (Color.Repro..and Diagram) "Encounter with sky and buffalo people" (Color.Repro. and Diagram) "Final ascension of scavenger attended by light- enings"(Repro. and Diagram) "The Red Snake People from Red Mountain" (Repro. and Diagram)	Box 7 <i>M of MA - Publ. Sept. 3 5.</i> " " \$50 " " \$50 " " \$50 " " \$50
On Stand Provided	41.73 ✓ OK.	War bonnet	Box 5 Pillsbury - \$50.00

The Woodsmen of the East

Introductory Panel #8

On Wall	41.2206 <i>pendulous top - old</i> 41.2257 <i>in binding of book @ top of packet.</i> 41.2207a <i>but binding in volume, be standard</i> ✓ 41.440 ✓	Bag, Winnebago Beaded bandolier and bag, Winnebago pair of beaded broad- cloth leggings Wooden mask	Box 5 AMNH - \$5 Box 5 Pillsbury - \$50.00 Box 5 AMNH - \$25 Box 4 A+C - \$10.00
---------	--	--	---

The Museum of Modern Art Archives, NY	Collection:	Series.Folder:
	RDH	VIII.50

-3-

The Woodsmen of the East (Continued).

On Wall (Cont'd)	✓ 40.5153 ✓	Wooden mask	Box 3 Denver - \$15.00
	41.438 ✓	Corn husk mask	Box 3 A+C - \$5.00
Table #1	✓ 41.147 a-b ✓ OK	Birch box	Box 3 Denver - \$10.00
	✓ 41.146 ✓ <i>spat inside.</i>	Birch box, Cree	Box 4 Denver - \$20.00
	40.5082 a-b ✓	Micmac box	Box 4 Hays - \$75.00
	40.5067	<del>Quilled garter</del>	Box 8 Milwaukee - \$5.00
	40.5145 a+b ✓ OK	Beaded bandolier	Box 5 Denver \$10.00
	41.714 a-b ✓ <i>much better</i>	Ribbon work leggings	Box 5 Denver - \$30.00
	41.2337 <i>frayed along</i>	Birch bark box	Box 7 Denver - \$100.00
	<i>see #1.142 a+b.</i>	<del>Old</del>	
On Stand Provided	41.144 ✓ OK	Skin coat	Box 5 Denver - \$60.00

Salish

Table #5	40.5121 ✓	Wooden figure	Box 4 Hays - \$15.00
	41.510 ✓	Wooden figure	Box 3 AMNH - \$75.00
	41.512 ✓ OK	Wooden figure	Box 3 AMNH - \$50.00
Free-standing	✓ 41.511 ✓	Wooden figure	Box 8 AMNH - \$350.00
Table #6	41.400 ✓ OK	Muckleshoot basket	Box 7 A+C - \$150.00

Fishermen of the Northwest Coast

Table #3 (continued)	41.1344 ✓	<del>Old</del> Food box	Box 3 AMNH - \$150.00
	41.1341 ✓ <i>2 brittle missing</i>	Rattle	Box 2 AMNH - \$50.00
	<i>552?</i>	<i>fl. head of fig.</i>	
Table #7	41.538 ✓ OK	Berry basket	Box 7 AMNH - \$50.00
	41.437 ✓ OK	Copper plaque	Box 4 Hays - \$500.00
	40.5206 (on wall above)	Dance wand	Box 8 Wash. State - \$50.00
	41.1345 - 3 pieces	Headress	Box 3 AMNH - \$75.00
	41.148 - 2 pieces	Copper helmet	Box 1 Denver - \$40.00
	41.538 - 2 pieces	Berry basket	Box 7 AMNH - \$50.00
	41.567a-b ✓ OK	Cedar chest	Box 3 A+C - \$25.00
Table #8	✓ 40.5208 ✓ <i>10/16/00 missing</i>	<del>Old</del> Bear rattle	Box 2 Wash State - \$50.00
	41.540 ✓ OK	Horn dish	Box 3 AMNH - \$75.00
	41.503 ✓ OK	Pipe (eagle)	Box 3 AMNH - \$50.00
	41.504 ✓ OK	Pipe (whale)	Box 2 AMNH - \$50.00
Pedestal #5	✓ 41.1295 ✓ <i>knackpt chipped</i>	Bear mother (cast)	Box 3 U.S. Natl Mus. - \$30.00
	41.311 ✓	Slate figurine	Box 4 Roy. Ontario Mus. - \$10.00
On Wall	41.566 ✓ OK	Chilkat blanket	Box 5 A+C - \$90.00
	40.5139 ✓ OK	Wooden mask	Box 2 Denver - \$25.00
	✓ 41.298 ✓ OK	Wooden mask	Box 4 Hays - \$40.00
	✓ 41.513 ✓ OK	Wooden mask	Box 4 AMNH - \$100.00
	✓ 41.508 ✓	Wooden mask	Box 4 AMNH - \$75.00

The Museum of Modern Art Archives, NY	Collection:	Series.Folder:
	RDH	VIII.50

-7-

Fishermen of the Northwest Coast (Continued)

On Wall (Cont'd)	✓ 40.5207	Wooden mask	Box 3 U. of Cal. - \$200.
	41.310 ✓	Spear	Box 8 Reg. Bur. Num. \$1000 <sup>00</sup>
	40.5074 ✓ OK.	House mask	House mask <i>nilewaka</i> Num. - box nwa ms.

Eskimo

Introductory Panel #9

On Wall (see diagram)	41.581 ✓ OK	Fishline	Box 4 A+C - \$5.00
	41.543 ✓	Spear	Box 8 AMNH - \$15.00
	41.541 ✓	Spear	Box 8 AMNH - \$15.00
	✓ 41.439 ✓ <i>only 3 feathers in ant.</i>	Seal mask	House mask <i>d'Herm</i> - \$50 <sup>00</sup> box
	✓ 40.5095 ✓	Mask	Box 3 Hege - \$50.00
	✓ 40.5090 ✓ <i>wing off side</i>	Mask	Box 3 Hege - \$40.00
	✓ 40.5092 ✓ <i>4 p's broken in main head</i>	Mask	Box 5 Hege - \$50.00
	✓ 40.5091 ✓	Mask	Box 3 Hege - \$60.00
	✓ 40.5088 ✓	Mask	Box 3 Hege - \$30.00
	✓ 40.5206 ✓	Mask	Box 3 U. of Cal. - \$200

INDIAN ART FOR MODERN LIVING

Table Case #2	41.355 ✓	Silver cup (Installed)	Box 5 A+C - \$20.00
	41.356 ✓	Silver cup (Installed)	Box 6 A+C - \$20.00
	41.333 ✓	Silver bracelet (Installed)	Box 5 A+C - \$10.00
	41.602 ✓	Silver bird pin (Installed)	Box 6 A+C - \$2.50
	41.379 ✓	Silver bow guard (Installed)	Box 5 A+C - \$10.00
	41.336 ✓	Silver bracelet (Installed)	Box 6 A+C - \$10.00
	✓ 41.580 ✓	Silver necklace (Installed)	Box 6 A+C - \$40.00
	41.521 ✓	Large Zuni pin (Installed)	Box 6 <i>desker</i> - \$45 <sup>00</sup>
	41.824 ✓	Mosaic dragon fly (Installed)	Box 6 <i>d'Herm</i> - \$25 <sup>00</sup>
	41.823 ✓	Small Zuni pin (Installed)	Box 6 <i>d'Herm</i> - \$10.00
Table Case #3	✓ 41.442 ✓	Large ivory bear (Installed)	Box 5 A+C - \$4.50
	40.5180 ✓	Ivory fork (Installed)	Box 6 <i>d'Herm</i> - \$2.50
	40.5167 ✓	Small ivory bear (Installed)	Box 6 <i>d'Herm</i> - \$2.00

The Museum of Modern Art Archives, NY	Collection:	Series.Folder:
	RDH	VIII.50

INDIAN ART FOR MODERN LIVING (Continued)

Table Case #3	40.5159 ✓	Ivory whale (Installed)	Box 6 <i>Thurn</i> #2 <sup>00</sup>
	40.5161 ✓	Ivory walrus "	Box 6 " - #2 <sup>00</sup>
	40.5163 ✓	Ivory sea-lion "	Box 6 " - #2 <sup>00</sup>
	40.5170 ✓	Ivory baby sea-lion (Installed)	Box 6 " - #2,00
	41.613 ✓	Silver buckle "	Box 6 <i>Decker</i> #25 <sup>00</sup>
	41.611 ✓	Silver bracelet "	Box 6 <i>Decker</i> #25 <sup>00</sup>
	41.612 ✓	Silver bracelet "	Box 6 " #25 <sup>00</sup>
	41.779 ✓	Silver pin with tur- quoise (Installed)	Box 6 " - #10,00
	41.623 ✓	Silver bracelet with turquoise (Installed)	Box 6 <i>Decker</i> #46 <sup>00</sup>
Table #9	40.495 ✓ <i>OK</i>	Black platter	Box 4A+C - #4.00
	41.428 ✓ <i>OK</i>	Red and white belt	Box 5A+C - #4.50
	41.445 ✓ <i>OK</i>	Hopi shawl	Box 5A+C - #25 <sup>00</sup>
	40.449 ✓ <i>OK</i>	Waste paper basket	Box 4A+C - #3.00
	41.782 ✓ <i>OK</i>	Skin boots	Box 5 <i>Decker</i> #20 <sup>00</sup>
	41.478 ✓ <i>OK</i>	Scrap basket	Box 7 <i>Decker</i> #15 <sup>00</sup>
On Wall	41.819 ✓ <i>OK</i>	Navaho rug	Box 5 <i>Fr Weigelt</i> - #40.
	( 41.755.5 ✓	Linoleum print	Box 7 <i>Beatty</i> - #5
	( 41.755.8 ✓	Linoleum print	Box 7 " "
Mounted	( 41.755.12 ✓	Linoleum print	Box 7 " "
	( 41.755.13 ✓	Linoleum print	Box 7 " "
	( 41.755.15 ✓	Linoleum print	Box 7 " "
	✓ 41.776 ✓ <i>OK</i>	Seminole ski suit	Box 5 <i>Picard</i> - #75 <sup>00</sup>
	41.762 ✓ <i>OK</i>	"Dancers" (glazed water- color)	Box 7 <i>Spencer</i> - #25 <sup>00</sup>
	41.453 ✓ <i>OK</i>	Wooden panel	Box 7A+C - #50 <sup>00</sup>

16 Mounted Explanatory Panels - These to be installed and used if desired - Box 7

1. ✓ Pueblo
2. ✓ Pottery Making - Pueblo
3. ✓ Sand Painting
4. ✓ The Navaho
5. ✓ Weaving and Embroidery - Pueblo
6. ✓ Basketry - Pueblo
7. ✓ Navaho Silver
8. ✓ California Basket Making
9. ✓ Hunters of the Plains
10. ✓ Skin dressing and Painting - Plains Indians
11. ✓ Woodwork and Copper - Northwest Coast Indians
12. ✓ Northwest Coast and Alaska
13. ✓ Chilkat Weaving - Northwest Coast
14. ✓ Beadwork
15. ✓ Porcupine Quillwork
16. ✓ Eastern Woodland Tribes



FOR STUDY PURPOSES ONLY. NOT FOR REPRODUCTION.

The Museum of Modern Art Archives, NY	Collection:	Series.Folder:
	RDH	VIII.50

INDIAN ART OF THE UNITED STATES

An exhibition circulated by The Museum of Modern Art, New York City

INSTALLATION INSTRUCTIONS - Hopi Murals

1. Please consult the diagram of installation when installing the murals. Each mural panel is numbered the same as on the diagram.
2. Panels which are back to back are fitted together first. That is:
  - a) Panels #1 and #2 are placed back to back with space of 4" or 5" between.
  - b) The 2 panels are held firmly together by 2 braces at the top edges and 2 braces at the lower edges. These braces (in Box #5) slide down over metal screws already fastened into side frames of panels.
  - c) Panels #3 and #4 are next fastened together in the same manner.
  - d) Then, slide Panels #3 and #4 into position beside #1 and #2, fitting the pegs on the sides of the panels into the holes on the next panel.
  - e) When 2 pairs of panels are fitted together in this way, insert bolts at top of frames in holes provided. Screw securely.
  - f) Proceed in this manner in installing all panels.
3. Panels #1 through #12; #13 through #20; and #21 through #26 form 3 separate groups of murals.

4 end pieces are provided to close off the open ends of the 3 groups.

Slide the hooks on the end pieces over the braces at the open ends of the panels, so that the end pieces are firmly in position.

Panel group #21 through #26 and Panel group #13 through #20 are placed with one end against Panel group #1 through #12, to form right angles.

FOR STUDY PURPOSES ONLY. NOT FOR REPRODUCTION.

The Museum of Modern Art Archives, NY	Collection:	Series.Folder:
	RDH	VIII.50

May 21, 1941

Do not Remove  
from File

CIRCULATING EXHIBITION OF INDIAN ART  
Geographical Distribution

PREHISTO  
Carvers  
41.309  
Engrave  
40.5107  
The Scul  
41.636  
41.639  
41.640  
41.641  
41.642  
41.487  
41.322  
41.321  
41.472  
41.275  
41.521  
41.466  
41.462  
41.701  
41.680  
41.692  
41.693  
41.694  
41.682  
41.683  
41.1376  
41.1374  
41.137  
The Pair  
Hohokam  
41.672  
41.165  
41.166  
40.5232  
40.5231  
c. 40.5245  
40.5198  
Mimbres  
41.469  
40.5194  
40.5195  
Arizona  
40.5201  
40.5199  
40.5200

75  
40  
20  
10  
23  
23  
10  
45  
45  
20  
15  
35  
25  
125  
569

Unique Ptg. & Sta. Co., Inc.—No. 420

TELEPHONE MESSAGE

Date 5/12/41

For Miss  
By Miss Dudley  
Phone  
Time  
Remarks The wishes to know whether special boxes for Indian show at Worcester are to be held here at the Museum or returned to lenders for shipment to Worcester. The do tend to shipping them to Worcester, do not we?

Rec'd by Hill

10 22 4  
+ 55  
10 27 9

Ontario Museum

Pach  
sity of  
ma  
n

l History  
sity of  
as  
tate Museum

" " Packs  
" "  
" "  
" "

Harnoncourt  
rn

eles  
Anthropology

olorado

olorado  
"

rris  
"

" jar

The Museum of Modern Art Archives, NY	Collection:	Series.Folder:
	RDH	VIII.50

May 21, 1941

Do not Remove  
from File

CIRCULATING EXHIBITION OF INDIAN ART  
Geographical Distribution

- PREHISTORIC
- Carvers
  - +2000 41.309
- Engrave
  - +100 40.5107
- The Sea
  - +10.00 41.636
  - +10.00 41.639
  - +10.00 41.640
  - +10.00 41.641
  - +10.00 41.642
  - +200 41.487
  - new # for cast:
    - c. 41.322
    - c. 41.321
    - +25 41.472
    - +10 41.275
    - +50 41.521
  - ask again 41.466
  - " " 41.462
  - make c. ?? 41.701
  - " " " 41.680
  - lend c. ?? 41.692
  - " " " 41.693
  - " " " 41.694
  - " " " 41.682
  - " " " 41.683
  - +25 41.1374
  - +15 41.137
  - +15 41.13
- The Pad
- Hohokam
  - +50 41.672
  - +50 41.165
  - +50 41.166
  - +100 40.5232
  - +100 40.5231
  - o. 40.5245
  - +250 40.5198
- Mimbres
  - +25 41.469
  - +50 40.5194
  - +50 40.5195
- Arizona
  - +50 40.5201
  - +75 40.5199
  - +60 40.5200

75  
40  
25  
10  
2.50  
2.00

569.50  
3630.00  
3633.00

Miss Woodruff,

If a museum sends us a cast of an object that was in the exhibition, as will be the case with Oklahoma, and may be the case with Columbus, we must have it reacquisitioned and given a new number and green slip. In the case of the Bear Mother the number which appears on this list is the new number for the cast. The Georgia female figure also has the right number on this list as it was the cast that was exhibited. If the Mountain Sheep comes from The Lab. of Anthropology it will need new number etc.

\*cast

*Emt.*

25  
125

569.50

10224  
+ 55  
10279

Ontario Museum

Pack  
ity of  
a

History  
ity of  
s  
ate Museum

*Pack*

Harnoncourt  
yn

geles

f Anthropology

Colorado

Colorado  
"

orris

jar

FOR STUDY PURPOSES ONLY. NOT FOR REPRODUCTION.

The Museum of Modern Art Archives, NY	Collection:	Series.Folder:
	RDH	VIII.50

May 21, 1941

Do not Remove  
from File

CIRCULATING EXHIBITION OF INDIAN ART  
Geographical Distribution

PREHISTORIC  
Carvers  
41.309  
Engrave  
40.5107  
The Seal  
41.636  
41.639  
41.640  
41.641  
41.642  
41.487  
41.322  
41.321  
41.472  
41.275  
41.521  
41.466  
41.462  
41.701  
41.680  
41.692  
41.693  
41.694  
41.682  
41.683  
41.1376  
41.1377  
41.1378  
The Paiute  
Hohokam  
41.672  
41.165  
41.166  
40.5232  
40.5231  
40.5245  
40.5198  
Mimbres  
41.469  
40.5194  
40.5195  
Arizona  
40.5201  
40.5199  
40.5200

75  
40  
25  
10  
2.50  
2.00  
2  
2  
2  
2  
12  
25  
25  
25  
10  
45  
45  
20  
15  
35  
25  
125  
569.50  
369.50  
3630.00  
1033.00  
1872.00  
3120.00  
10224.50  
6/19/41  
10224  
+ 55  
10279

Ontario Museum

er.

r Pach  
rsity of  
oma  
in

l History  
rsity of  
as  
State Museum

" " Packs  
" "  
" "  
" "

'Harnoncourt  
yn

geles

f Anthropology

Colorado

Colorado  
"

orris  
"

jar

FOR STUDY PURPOSES ONLY. NOT FOR REPRODUCTION.

The Museum of Modern Art Archives, NY	Collection:	Series.Folder:
	RDH	VIII.50

May 21, 1941

*Remove  
File*

CIRCULATI  
Geographi  
  
PREHISTOR  
Carvers o  
41.309 (H  
  
Engravers  
40.5107 ( )  
  
The Sculp  
41.636 (3  
41.639 (3  
41.640 (3  
41.641 (3  
41.642 (3  
41.487 (1  
41.322 (B  
c. 41.321 ( )  
41.472 (9  
c. 41.275 (1  
41.521 (T  
41.466  
41.462  
41.701 (1  
41.680 (1  
41.692 a/  
41.693 (2  
41.694 (2  
41.682 (1  
41.683 (1  
41.1376  
41.1374  
41.1375  
The Paint  
Hohokam  
41.672 - ( )  
41.165 ( )  
41.166 ( )  
40.5232 ( )  
40.5231 ( )  
c. 40.5245 ( )  
40.5198 ( )  
  
Mimbres  
41.469 ( )  
40.5194 ( )  
40.5195 ( )

2000	100	5	25
10	10	10	1000
10	40	50	100
10		75	500
10	250	40	40
10	5	20	100
	25	50	75
10	1	75	200
200	1	10	50
25	1	50	50
10	1	15	150
50	1	15	75
5		15	50
5	1	50	75
5	15	40	50
100	40	25	50
400	40	15	50
250	40	50	40
25	1.00	50	15
50	50	50	75
50	50	3	50
50	15	50	350
25	50	50	15
60	20	10	15
	15	20	50
	300	15	40
	100	75	50
	300	30	60
	300	10	30
	100	60	200
	1872		3630
		1033	

*3120*

Ontario Museum  
  
Pach  
ity of  
a  
  
History  
ity of  
as  
ate Museum  
Pacha  
"  
"  
"  
"  
"  
"  
arnoncourt  
les  
Anthropology  
olorado  
olorado  
"

Arizona Pottery  
40.5201 (72305) illus. *OK*  
40.5199 *OK*  
40.5200 *OK*

Pottery bowl  
" canteen  
" jar

Earl Morris  
" "  
" "

The Museum of Modern Art Archives, NY	Collection:	Series.Folder:
	RDH	VIII.50

May 21, 1941

Do not Remove  
from File

CIRCULATING EXHIBITION OF INDIAN ART  
Geographical Distribution

PREHISTORIC

Carvers of the Northwest Coast

~~\$200.00~~ 41.309 (HN184) illus. OK Stone Totem Royal Ontario Museum

Engravers of the Arctic

~~\$10.00~~ 40.5107 (18/3622) illus. OK Ivory Drum Handle Heye

The Sculptors of the East

~~\$10.00~~ 41.636 (35059) OK Banner stone Andover,

~~\$10.00~~ 41.639 (35235) OK " " "

~~\$10.00~~ 41.640 (35076) OK " " "

~~\$10.00~~ 41.641 (35078) OK " " "

~~\$10.00~~ 41.642 (35074) OK " " "

~~\$200.00~~ 41.487 (189455) OK Bird Stone Walter Pach

new # for casts: c. 41.322 (B-99-2) illus. OK Stone pipe (Oklahoma) University of Oklahoma

c. 41.321 (cast) OK " " " Claflin

~~\$25.00~~ 41.472 (9138) OK Stone pipe (Tenn. And Ohio) Heye

~~\$10.00~~ c. 41.275 (14/1455) OK Female figure (Georgia) Natural History

~~\$50.00~~ 41.521 (T833) OK Stone pipe (Tenn. & Ohio) University of Arkansas

ask again 41.466 Tripod bowl University of Arkansas

" " 41.462 Bowl, plumed serpent Arkansas

make c. ?? 41.701 (14/23) Stone Disk (Miss.) Ohio State Museum

" " " 41.680 (1200/10) illus. Adena Man cast " " " Pack

lend c. ?? 41.692 a/b (283/325 & 6) Copper ornament, serpent " " "

" " " 41.693 (283/384) " " " " " "

" " " 41.694 (283/323) " " " " " "

" " " 41.682 (125/17) illus. Stone pipe, Tremper Mound " " "

" " " 41.683 (125/24) illus. " " " " " "

~~\$25.00~~ 41.1376 Monitor Pipe (cast)  
~~\$16.00~~ 41.1374 Shell Gorget (cast) "  
~~\$15.00~~ 41.1375 Shell Gorget (cast)

The Painters of the Southwest

Hohokam

~~\$50.00~~ 41.672 - OK Coyote Shell Rene d'Harnoncourt

~~\$5.00~~ 41.165 (03.262) illus. OK Frog shell (large) Brooklyn

~~\$5.00~~ 41.166 (03.263) OK " " (small) "

~~\$100.00~~ 40.5232 (A4431/351) OK Stone palette Los Angeles

~~\$100.00~~ 40.5231 (A4431/486) - OK Pottery bowl, fragment " "

c. 40.5245 (10/502) Mountain sheep Lab. of Anthropology

~~\$250.00~~ 40.5198 (2558) illus. OK Basket U. of Colorado

Mimbres

~~\$25.00~~ 41.469 (10/59) illus. OK Bowl Taylor

~~\$50.00~~ 40.5194 (3198) OK " " U. of Colorado

~~\$50.00~~ 40.5195 (3264) OK " " " "

Arizona Pottery

~~\$50.00~~ 40.5201 (72305) illus. OK Pottery bowl Earl Morris

~~\$75.00~~ 40.5199 OK " canteen " "

~~\$60.00~~ 40.5200 OK " jar " "



The Museum of Modern Art Archives, NY	Collection:	Series.Folder:
	RDH	VIII.50

Indian Circ. Page 3  
May 21, 1941

The Navaho Shepherds  
 \$5.00 41.748 a-b OK  
 \$10.00 41.618 OK  
 \$5.00 41.740 OK

Bridle Ornaments  
 Silver bracelet  
 " "

Mr and Mrs Disher  
 " " " "  
 " " " "

LIVING TRADITIONS (cont'd)

The Apache Mountain People  
 \$7.00 40.5135 illus. OK  
 7- 41.430 a/b - OK

Basket  
 Fiddle

Mrs. Denman  
 Rene d'Harnoncourt

The Desert Dwellers of the Southwest  
 \$40.00 41.121 (QP-2-P) OK  
 \$4.00 41.398 OK  
 \$20.00 40.4497 (XMO-1-GG) illus. OK

Wooden bowl  
 Pima basket  
 Pottery bowl

Denver Museum  
 Rene d'Harnoncourt  
 Denver Museum

The Seed Gatherers of the Far West  
 \$5.00 41.516 (50.1-8265) OK  
 \$7.50 41.553 (50/2696) OK  
 send for if needed

Basket jar  
 Work basket  
 California baskets

Natural History  
 " "  
 Denver

The Hunters of the Plains  
 \$2.00 41.429 (128) OK  
 \$1.00 41.441 OK  
 \$1.00 41.432 (902) OK  
 \$10.00 41.725 (BS-59-G) OK  
 \$5.00 40.5152 (PICr-1-P) illus. OK  
 \$15.00 40.5148 (BCr-6-P) OK  
 \$15.00 40.5150 (BS-81-P) OK  
 \$15.00 41.723 (B-63-P) OK  
 \$5.00 41.180 (35.194L-a) illus. OK  
 \$4.00 40.5126 (12/2157) OK  
 \$2.50 40.5127 (9/9928) OK  
 \$15.00 40.5079 (20/1987) OK  
 \$5.00 41.296a/b (2/1506) OK  
 \$5.00 40.5072a/b (31491a/b) OK  
 \$5.00 41.73 (136) OK  
 \$5.00 41.802 OK  
 \$3.00 41.786 a/b OK  
 \$5.00 40.5192 illus. OK  
 send for when wanted - OK  
 \$5.00 41.128 (PS-3-DG) OK

Roach (headdress)  
 Saddle  
 Fan  
 Breastplate  
 Ceremonial pipe  
 Pipe bag  
 " "  
 Rattle  
 Rawhide parfleche  
 Decorated lance (fur)  
 " " (feathers)  
 Battle axe  
 Buckskin leggings  
 Clan pipe  
 War bonnet  
 Hair ornament  
 Quilled arm bands  
 Ribbon applique garment  
 Elkskin robe  
 Shield

Indian Arts and Crafts  
 " " " "  
 " " " "  
 Denver Museum  
 " "  
 " "  
 " "  
 Brooklyn "  
 Heye  
 " "  
 " "  
 Milwaukee Public Museum  
 Philbrook Mus., Tulsa  
 Alice Marriot  
 Tantaquidgeon  
 Indian Arts and Crafts  
 Claflin  
 Denver

The Woodsmen of the East  
 \$1.00 41.440 (1687) illus. OK  
 \$10.00 41.147a/b (CMG-3-P) illus. OK  
 \$2.00 41.146 (CWC-1-P) illus. OK  
 \$15.00 40.5153 (M-Sen-8-P) illus. OK  
 \$1.00 41.438 illus. OK  
 \$2.50 40.5082 (6/518) OK  
 \$1.00 40.5067 (30435) OK  
 \$3.00 41.714 a/b (HOT-2-P) OK  
 \$10.00 40.5145 a/b (BOJ-2-X) OK  
 \$10.00 41.144 (PNa-7-P) OK

Wooden Mask  
 Montagnais birch box  
 Birch box, Cree  
 Wooden mask  
 Iroquois corn husk mask  
 Micmac box  
 Quilled garter  
 Ribbonwork leggings  
 Beadwork, beaded leather strap  
 Man's coat

Indian Arts and Crafts  
 Denver Museum  
 " "  
 " "  
 Rene d'Harnoncourt  
 Heye  
 Milwaukee Public Mus.  
 Denver  
 " "

The Museum of Modern Art Archives, NY	Collection:	Series.Folder:
	RDH	VIII.50

Indian Circ. Page 4  
May 22, 1941

LIVING TRADITIONS cont'd  
Fishermen of the Northwest Coast

# 4000 41.567a/b (OK)	Cedar chest	Indian Arts and Crafts
# 4000 41.566 (OK)	Chilkat blanket	" " " "
# 25 40.5139 (NCow-1-P) (OK)	Wooden mask	Denver
# 100 41.310 (HN-1298) (OK)	Spear	Royal Ontario Museum
# 100 41.311 (HN-296) (OK)	Slate figurine (female)	" " "
# 500 41.437 (OK)	Copper plaque	Rene d'Harnoncourt
# 40 41.298 (3/4678) illus (OK)	Wooden mask	Heye
# 100 41.513 (16/377) illus (OK)	" "	Natural History
# 75 41.508 (16/962) illus (OK)	" "	" "
# 200 40.5207 illus - OK	" "	University of California
# 50 40.5208 (955) (OK)	Rattle	Wash. State Museum
# 50 40.5205 (1237) (OK)	Dance wand	" " "
# 150 41.1344 (19/1086) (OK)	Food box	Natural History
# 75 41.540 (19/696) illus (OK)	Horn Dish	" "
# 50 41.1341 (19/830) (OK)	Rattle	" "
# 75 41.1345 (E/1560) (OK)	Headdress	" "
# 50 41.538 (E/2318) illus (OK)	Berry picker basket	" "
# 50 41.503 (T/22579) (OK)	Wooden pipe (eagle shape)	" "
# 50 41.504 (E/1278) (OK)	" " (whale shape)	" "
c. 41.1295 - OK - OK	Bear Mother	U.S. National Mus.
# 40 41.148 (Q/1-21-P) (OK)	Helmet	Denver
# 40 5074 (17741a) (OK)	Carved Mask	Milwaukee
<u>Salish</u>		
# 15 41.400 (OK)	Muckleshoot burden basket	Indian Arts and Crafts
# 15 40.5121 (10/163) (OK)	Wooden figure	Heye
# 75 41.510 (16.4921) (OK)	" "	Natural History
# 50 41.512 (T22/24) (OK)	" "	" "
# 350 41.511 (16/9946) illus. - 16/4741 - 11	" "	" "
<u>Eskimo</u>		
# 100 41.439 illus. (OK)	Seal mask	Rene d'Harnoncourt
# 100 41.581 (118) illus (OK)	Fishline	Indian Arts and Crafts
# 15 41.543 (1/2279) illus (OK)	Spear	Natural History
# 15 41.541 (60.1/5650) (OK)	" "	" "
# 50 40.5095 (12/925) illus (OK)	Mask	Heye
# 40 40.5090 (12/910) (OK)	" "	" "
# 50 40.5092 (9/3409) (OK)	" "	" "
# 40 40.5091 (5/8667) (OK)	" "	" "
# 30 40.5088 (10/6031) (OK)	" "	" "
# 200 40.5206 (2/5854) (OK)	" "	University of California



The Museum of Modern Art Archives, NY	Collection:	Series.Folder:
	RDH	VIII.50

*return books*  
*file*

*Handley*  
*recycle*

7/4/41

Page 1

CIRCULATING EXHIBITION OF INDIAN ART  
Objects to be gotten for Worcester  
\* already asked for

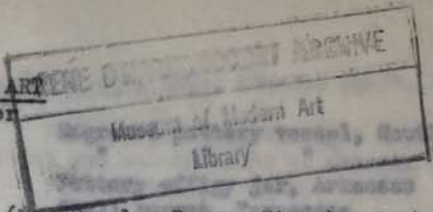

Phillips Academy, Andover, Mass. (Dr. Douglas Byers, Director Peabody Foundation)

La., Ga. and Ala.  
\* 41.626 (82-R113) illus. Stone Image, Ga. (get cast of the one in this ex.)

University of Arkansas, Fayetteville, Arkansas (Dr. S.C. Bellinger, Dept. of Zoology)

Sculptors of the East  
41.466 ho # Tripod bowl, black  
41.462 ve # Bowl, plumed serpent

American Museum of Natural History, New York (Dr. George Vaillant)

dc Fishermen of the Northwest Coast  
\* 41.511 (16/8946) illus. Wooden figure, Salish  
41.515 (E.453) illus. Wooden mask, Tlinket  
41.538 (E.2318) illus. Berry picker basket  
dc 41.503 (T/22579) Wooden pipe, in the shape of an eagle  
41.504 (E/1278) " " in the shape of a whale

Brooklyn Museum, Brooklyn, New York (Dr. Herbert J. Spinden)

ok The Pueblo Cornplanters  
\* 41.167 (03.132) Zuni water jar

Field Museum of Natural History, Chicago, Illinois

return Sculptors of the East  
40.5049 (85500) Stone figure

Heye Foundation, Museum of the American Indian, New York (Mr. George Heye)

return Carvers of the Northwest Coast  
41.242 (20/980) illus. Soapstone figure  
41.866 (19/1615) illus. jar  
Sculptors of the East  
41.248 (18/2785) illus. Stone pipe from Virginia  
41.701 (14/23) illus. Stone disk



The Museum of Modern Art Archives, NY	Collection:	Series.Folder:
	RDH	VIII.50

8/4/41

Page 3

Peabody Museum, Harvard University, Cambridge, Mass. (Donald Scott, Director)

Sculptors of the East

send  
back\* 41.19 (22059) Painted water bottle (got this original or a cast)  
Ask for a copper piece to go with cut out enlargements of design.  
41.36 (37.111.10/12537) Pottery bowl, Pueblo

TELL WORCESTER:

- 1) to larvae eggs
- 2) how to clean stoneware

Royal Ontario Museum of Archeology, Toronto, Canada (Ethlyn M. Greenaway, Ass't. to director)

Fishermen of the Northwest Coast

41.311 (HN296) Slate figurine of a woman

- 1) Eskimo mask, Neys #40.1092
- 2) Zuni headdress, 41.175b

United States National Museum, Washington, D.C.

The Fishermen of the Northwest Coast

41.759 (73117) Slate carving "The Bear Mother"

- 1) Zuni basket, 41.175b

Utah Art Project, WPA

Pictograph is 12 1/2" x 60"

- 1) tables: Metal tongue should point down, not up  
Long tables need another crosswise support

Add to Worcester Exhibition (mats containing excerpts from catalogue 5" sq. by 10" sq.)

- 2) Cradle in (panels with paper lettering #40.5290)
- 3) Put larger blocks in vertical case #4 for Sábres board

Want to do about vertical cases in prehistoric section that Miss Miller says should open in the front not in the back?

overhead

Handwritten notes and diagrams, including a large checkmark and various scribbles.

The Museum of Modern Art Archives, NY	Collection:	Series.Folder:
	RDH	VIII.50

Wednesday August 13th  
Gallup

Dear Elodie:

TO BE DONE TO THE INDIAN SHOW

We had a few days of immense headache with the show but finally got it up. Found the Gallup art center under-staffed and inexperienced in handling this

TELL WORCESTER:

- 1) to laryx rugs
- 2) how to clean plexiglas *how? using window soap & water - dry with silk*

WITHDRAW FROM SHOW

- an Apache Indian and an artist both of whom are employed*
- 1) Eskimo mask, Heye #40.5092
  - 2) Zuni headdress, 41.175a *unpack, unglued, assembled cases, heaved them around and installed all the stuff.*

ADD TO SHOW

- I trust you got my wire saying that one item was missing when we checked the material in. Here is a detailed*
- 1) Zuni baton, 41.175b

FIX INSTALLATION addition:

- 1) tables: Metal tongue should point down, not up - *put extra side post*  
Long tables need another crosswise support
- 2) Make a pedestal for Salish figure #41.511, 15" sq. by 18" high
- 3) Cradle in vertical case #5 for jar #40.5200 probably *broken*
- 4) Put larger blocks in Vertical case #4 for Mimbres bowls, headdress and baton. Both missing from

*dcw* What to do about vertical cases in prehistoric section that Miss Miller says should open in the front not in the back?

- 41.173 a-b Zuni war god. Found in this case but not listed.
- 41.213 Kachina doll. Arm broken off, old break. Glued by me.
- Box 5 - 41.502 Hair Ornament. Correct number is 41.500 not 40.502 as listed.

*Bret Lock*

Here is my general impression of the show and the installation material. In general it is OK and I think our workshop did a marvelous job to build all that equipment in such short time. The cases are ingenious but in some ways very impractical. The vertical cases have a serious error in opening at the back - means you have to set up all the fragile and delicate balanced objects in the case, then close it which makes everything dangerously, then the whole case has to be moved back against the wall. This is very bad. *NO* front of the case should be the removable part. Hopi tile case is particularly difficult as it was almost impossible to screw on the back of the case without disassembling

*also to be done with the cases*

The Museum of Modern Art Archives, NY	Collection:	Series.Folder:
	RDH	VIII.50

Wednesday August 13th  
Gallup

*Frederic*

*Gallup*

Dear Elodie:

We had a few days of immense headache with the show but finally got it up. Found the Gallup art center under-staffed and inexperienced in handling this kind of a show - were used to putting up pictures but not this kind of installing at all. With the help of an Acoma Indian and an artist both of whom are employed at the Center, we opened crates, unpacked, assembled cases, heaved them around and installed all the stuff. I trust you got my wire saying that one item was missing when we checked the material in. Here is a detailed report on condition:

Box 3 - 41.1345 Headdress. 2 pcs. of shell missing, probably old loss, not new? *not that*

" - 41.636 Banner stone. Slight chips, probably old *answered*

" - 41.175 a-b Headdress and baton. Both missing from this case. Headdress found in case 5 but baton still missing. Headdress had 2 pc s. *OK* broken off, 1 old break, 1 new. Glued by me. *should be OK*

" - 41.173 a-b Zuni war god. Found in this case - *OK* but not listed.

" - 41.213 Kachina doll. Arm broken off, old break. Glued by me.

Box 5 - 41.802 Hair ornament. Correct number is 41.802 *OK* not 40.802 as listed.

Here is my general impression of the show and the installation material. In general it is OK and I think our workshop did a marvelous job to build all that equipment in such a short time. The cases are ingenious but in some ways very impractical. The vertical cases have a serious error in opening at the back. It means you have to set up all the fragile and delicately balanced objects in the case, then close it which shakes everything dangerously, then the whole case has to be moved back against the wall. This is very bad. The front of the case should be the removable part. Hopi tile case as particularly difficult as it was almost impossible to screw on the back of the case without displacing

*Also too many screws at the back - 18. I would have been enough.*

The Museum of Modern Art Archives, NY	Collection:	Series.Folder:
	RDH	VIII.50

2

the tiles which are attached to it. If the cases had been designed to open at the front I would say they are excellent, and very ingenious. The plexiglass is a swell idea. Better find out if there is any special way to clean it and let Boston (if that is next stop for show) know about it.

The table cases with permanent installation are swell. ~~xxx~~ I wish the whole show could have been permanently installed. That would be the only way to insure the safety of these objects. Some of them are so frail that I think they will be reduced to matchwood before half the circuit is over. Two pieces should, I think, be withdrawn from the show for this reason if they are to be preserved for posterity - namely the Eskimo mask belonging to Heye (#40.5092) and the Zuni headdress (#41.175a). If you decide to withdraw these, I would suggest that you let them go on~~e~~ with the rest of the show to the next place and then let them be shipped back to you from there. Facilities for packing are so limited here that it would be better not to ask Gallup to ship these out separately.

The tables are goodlooking but flimsy and have one error in design. The metal tongue which is supposed to lock the two pieces together should point downward instead of up. As it is, you cannot move the tables even a few feet without their coming apart. I think they will warp and get pretty shaky before long. The long ones really need another crosswise support to be steady.

A pedestal is needed for the large Salish figure #41.511. We found none, so made a hideous makeshift. If you send one on to the next place, it should be 15" square by about 18" high. The missing piece of plexiglass did not arrive, so we got glass for the Bear Mother case.

I found a moth residing in the Chilkat blanket but could find no signs of damage. I sprayed it and brushed it. You might ask Boston (I keep assuming that is the next stop, but don't know if it is) to get some Larvex and spray all the blankets, I couldn't find Larvex in this impossible town, so used Flit on the wrong side of the blanket.

As you know, the installation blueprints do not correspond exactly to the actual objects in the show. The most confusing section in this regard was the Prehistoric. A lot of pots and so on did not arrive. A huge prehistoric pot #40.5200 was supposed to go in vertical case 5, but the diameter of the pot is over 18" and the ~~width~~ depth of the case inside 13". We solved this by constructing in a very primitive way a sort of cradle to hold the pot up on edge so it could fit in the case, as there was no other place to put it. The little blocks on which the Mimbres pots were to stand were too small to hold them with the rubber supports, so I simply tore them out of the case which fortunately had been painted under them.

This will do  
for rest of show  
but is not  
ideal.

the blocks

The Museum of Modern Art Archives, NY	Collection:	Series.Folder:
	RDH	VIII.50

Will you tell Publications Dept. to bill me for two paperbound catalogs with the staff discount. Eddie and I gave them to our Acoma Indian and other assistant. (Arthur Penner)

I am returning two labels to you. One is for objects which did not arrive - Large Human Effigy Pipes #41.321 & 41.321. The other is also for an object which is not here although it is labeled with the number which is on the pot - 41.107. The correct label for this pot should read "Santo Domingo Pueblo, made by Roma." Will you see if you can find the correct label and have it sent as soon as possible, as the pot is now unlabeled. It is lent by Denver.

I hope I have thought of all I should tell you. We are going to Rest through Aug. 22 at Oraibi, and can be addressed C/o Gen'l Delivery, Oraibi, Arizona till then. After that I will go on to Calif.

As you may have guessed this is a filthy typewriter - sorry. Hope you get some vacation. Love to you and a selected group of others at MMA.

Dusky

P.S. - The Acoma Indian is wonderful. He is acting as a guard & is all dressed up in feathers & turquoise, & tells people that he "lives this material every day of his life."

The Museum of Modern Art Archives, NY	Collection:	Series.Folder:
	RDH	VIII.50

Wednesday, Aug. 13th

Dear Elodie:

The show opened on time last night after Dorothy and I had put on the blitz for four days to get it up. Among the assistants we had was an Acoma Indian, James Paytiamo, who came to the opening in full regalia and guided visitors through the exhibit. Dorothy did a wonderful job. She took charge of everything, unpacking, registrar's job, installation, and labelling. Some of the installations, especially the Eskimo and Northwest material is very beautiful indeed. The ~~prehistoric~~ prehistoric room looks fine, the Plains Indian room is good, and the Navajo and Pueblo rooms fairly good. I think there is probably too little material in the Apache, Seegatherer, and Desert Dweller groups to make an impression. But the show, in general, is very good indeed.

We are making arrangements with the Indian Arts and Crafts Board people to get an experienced packer to superintend the packing of the exhibit, especially the pottery and the masks. I think everything will go all right, ~~though~~ though I'm not quite sure how well the installation material will stand up after a few showings of the exhibit. It is very ingenious, really one of the Museum triumphs, but I'm afraid it's a bit fragile. The plexiglass is very difficult to clean. At least it was for us, since we didn't dare to wash it. If you have any method of cleaning it that is effective I wish you'd send it to the folks out here.

I want to tell you how much I appreciate all your help in getting this exhibit here. Also, I think the Museum is doing a real pioneer job in working out methods of sending out object shows. If you could work out a complete set of installation for this type of show, of the kind you made for the silver and the prehistoric material, ~~which~~ it would be a great help to small museums and art galleries that really aren't equipped to handle shows of this kind. *Among these is the Gullap art Center.*

The people out here have been told that they must give themselves a least a week or ten days to pack the material. I wish you'd tell them when it must be shipped.

With kindest regards,

Eddie

FOR STUDY PURPOSES ONLY. NOT FOR REPRODUCTION.

The Museum of Modern Art Archives, NY	Collection:	Series.Folder:
	RDH	VIII. 50

**CLASS OF SERVICE**  
 This is a full-rate Telegram or Cablegram unless its deferred character is indicated by a suitable symbol above or preceding the address.

*0625.07 # 1050*

# WESTERN UNION

*Miller*

R. B. WHITE PRESIDENT  
 NEWCOMB CARLTON CHAIRMAN OF THE BOARD  
 J. C. WILLEVER FIRST VICE-PRESIDENT

1201

**SYMBOLS**

DL = Day Letter
NT = Overnight Telegram
LC = Deferred Cable
NLT = Cable Night Letter
Ship Radiogram

The filing time shown in the date line on telegrams and day letters is STANDARD TIME at point of origin. Time of receipt is STANDARD TIME at point of destination

VA20 24/22 NT COLLECT=AU GALLUP NMEX 10 041 AUG 11 AM 2 38  
 MISS ELODIE COURTER=  
 MUSEUM OF MODERN ART 11 WEST 53 ST NYK=

SHOW UNDER CONTROL, ZUNI BATON 41.175B MISSING, PLEASE ADVISE  
 OPENING DATE BOSTON AND SHIPPING DATE FROM GALLUP LETTER  
 FOLLOWS BEST REGARDS=  
 DOROTHY MILLER.

*Baton in B243*  
*Miller - write Gallup*

THE COMPANY WILL APPRECIATE SUGGESTIONS FROM ITS PATRONS CONCERNING ITS SERVICE

I understand that Miss Dudley, our registrar, has arranged to have the items lent by ..... (name of institution) to our exhibition, Indian art of the U.S., delivered to you by Hahn Brothers, tomorrow, July 25rd. I trust that they will reach you in good order.

I wish to thank you for your great generosity in permitting us to include these valuable pieces in our traveling show. I do believe that their temporary absence from your collection has been more than compensated for by the tremendous public interest in the show and the splendid success it has met everywhere.

Since leaving New York in the summer of last year, the exhibition has been shown at the Gallup Art Center, Gallup, New Mexico; the Worcester Art Museum, Worcester, Massachusetts; the Lyman-Allyn Museum, New London, Connecticut; the Cleveland Art Museum, Cleveland, Ohio; the ~~Worcester Art Museum~~ Joslyn Memorial, Omaha, Nebraska; the City Art Museum of St. Louis, Missouri; and the Los Angeles County Museum of History, Science and Art, Los Angeles, California.

*(38)*

*7/27/42*

Dear .....

INDIAN LETTER \* NEW YORK CITY RETURNS:

*copy for Dudley*

*(no) copy for Dudley*

*Miller*

FOR STUDY PURPOSES ONLY. NOT FOR REPRODUCTION.

The Museum of Modern Art Archives, NY	Collection:	Series.Folder:
	RDH	VIII.50

*Museum  
Executives*

*(na) copy for Dudley*

*H. Wagoner  
Tulsa  
shipped  
registered  
today*

INDIAN LETTER \* NEW YORK CITY RETURNS:

Dear .....

*7/23/42*

I understand that Miss Dudley, our Registrar, has arranged to have the items lent by ..... (name of institution) to our exhibition, Indian Art of the U.S., delivered to you by Hahn Brothers, tomorrow, July 23rd. I trust that they will reach you in good order.

*(38  
Hahn)*

I wish to thank you for your great generosity in permitting us to include these valuable pieces in our traveling show. I do believe that their temporary absence from your collection has been more than compensated for by the tremendous public contacted at the show and the splendid success it has met everywhere.

Since leaving New York in the summer of last year, the exhibition has been shown at the Gallup Art Center, Gallup, New Mexico; the Worcester Art Museum, Worcester, Massachusetts; the Lyman-Allyn Museum, New London, Connecticut; the Cleveland Art Museum, Cleveland, Ohio; the ~~xxxxxxx~~ Joslyn Memorial, Omaha, Nebraska; the City Art Museum of St. Louis, Missouri; and the Los Angeles County Museum of History, Science and Art, Los Angeles, California.

When your loans have been received and checked, will you be good enough to sign and return the enclosed receipt?

INDIAN LETTER \* OUT OF TOWN RETURNS:

Dear .....

The items lent by you (or name of institution) to our exhibition, Indian Art of the United States, will be shipped to you by Railway Express from the Museum of Modern Art sometime during the week of July 30th. I trust that they will reach you in good order.

(Then, proceed as above.) *- see change TP 2*

NOTE: Brooklyn Museum letter: *(white copy)*  
4th paragraph:

*7/23/42*

In checking the condition of the various items, I regret to say that we found two pieces of wood broken from the headdress, #41.175a. Since I believe that you have better facilities and more expert craftsmen to make such repairs, I have had the piece returned to you in this condition. Will you be good enough to make whatever repairs you deem necessary and bill The Museum of Modern Art for the expense incurred? *I think the sawages were not ~~permanently~~ repair the headdress (mask)*

*7/23/42*

NOTE: Heye Foundation letter: 4th paragraph: *(white copy)*

"In checking the condition of the various items, I regret to say that we found ~~two~~ pieces broken from the mask, #40.5092. Since I believe, etc.

*4 a pc. loan from  
mask #40.5090.*

FOR STUDY PURPOSES ONLY. NOT FOR REPRODUCTION.

The Museum of Modern Art Archives, NY	Collection:	Series.Folder:
	RDH	VIII.50

NOTE: Denver Art Museum letter: *(white copy)*

7/31/42 ✓

In checking the condition of the various items, I regret to say that we found the bowl of the pipe, #40.5152, broken in two pieces, and a split in the side of the birch bark box, 41.146, - - etc.

As you will note from the enclosed receipt forms, certain items belonging to the Indian Arts and Crafts Board have been returned to you at the request of the Board. When your loans and those of the Board have been received and checked, will you be good enough to sign and return the enclosed receipts?

NOTE: U. of Alabama letter: *(white copy)*

here + these  
pieces to  
be  
see cases.  
7/31/42

In checking the condition of the various items, I regret to say that we found the shell gorget cast, #41.1636, broken in two pieces. Etc.

finally  
sorted  
8/6/42

NOTE: Milwaukee Public Museum letter:

Last paragraph: As you will remember, the <sup>cloth</sup> garter decorated with porcupine quills, #40.5067 was returned to you in April of this year. When the mask has been received and checked, will you be good enough to sign and return the enclosed receipt for it and the garter?

NOTE: Indian Arts & Crafts Board (d'Harmoncourt)

8/4/42 ✓

1st para.: - " - - lent by you and Mrs. D'Harmoncourt, as well as the Indian Arts and Crafts Board etc.

2<sup>nd</sup> para. - *to hope Mrs. D'Harmoncourt has not missed the jewelry to which I am sure*  
Last para; - "When the loans have been received and checked, will you be good enough to sign and return the enclosed receipts? We have followed your instructions in returning other items belonging to the Board, to ~~the~~ Mr. Austin Ladd, and the Denver Art Museum.

*the visitors to the Ed  
Have sincerely appreciated an opportunity to see the finest Indian place.*

NOTE: U. of Cal.:

7/31/42 ✓

1st para: - "The 2 masks lent by the Museum of Anthro. to our exhibition, Indian Art of the U.S., have now been returned to you directly from the Los Angeles County Museum in L.A. I trust that they have reached you in good order.

Etc.

705  
B7  
152

FOR STUDY PURPOSES ONLY. NOT FOR REPRODUCTION.

The Museum of Modern Art Archives, NY	Collection:	Series.Folder:
	RDH	VIII.50

INDIAN ART OF THE UNITED STATES

An exhibition circulated by The Museum of Modern Art, New York City

INSTALLATION LIST

Poster for the exhibition

Box 7

<u>Installation Unit</u>	<u>Museum No.</u>	<u>Object</u>	<u>Packing Box</u>
--------------------------	-------------------	---------------	--------------------

PREHISTORIC

Map - Ancient People of the Northern Woodlands

Carvers of the Northwest Coast

Pedestal #1	41.309	Stone Totem	Box 8
-------------	--------	-------------	-------

Engravers of the Arctic

Wall Case #1	40.5107	Ivory Drum Handle (Installed)	Box 7
--------------	---------	----------------------------------	-------

Sculptors of the East

Vertical Case #1	41.636	Banner Stone	Box 3
	41.639	Banner Stone	Box 3
	41.640	Banner Stone	Box 3
	41.641	Banner Stone	Box 3
	41.642	Banner Stone	Box 3
	41.487	Bird Stone	Box 3

Vertical Case #2	41.1376	Monitor Pipe	Box 3
	41.472	Stone Pipe	Box 4
	41.521	Stone Pipe	Box 3
	41.1662	Bird Pipe	Crate 7
	41.1663	Bird Pipe	Box 2

Wall Case #1a	41.1631 - 1638	Shell Gorgets	Box 3
	41.1374	Shell Gorgets	Box 3
	41.1375	Shell Gorgets	Box 3

Vertical Case #3	41.275	Female Figure Georgia (cast)	Box 1
	41.1485	Stone Pipe (cast)	Box 3
	41.1486	Stone Pipe (cast)	Box 3

The Museum of Modern Art Archives, NY	Collection:	Series.Folder:
	RDH	VIII.50

-2-

Sculptors of the East (Continued)

Podestal #3	41.1483	Adena Man	Box 3
Enlarged Photo	No number	Adena Man	Box 5

The Painters of the Southwest - Hohokom

Wall Case #2	41.672	Coyote shell (Installed)	Box 7
	41.165	Frog shell (large) (Installed)	Box 7
	41.166	Frog Shell (small) (Installed)	Box 7
	40.5232	Stone Palette (Installed)	Box 7
Podestal #4	40.5231	Pottery fragment	Box 2
Hanging	40.5198	Basket	Box 7

Mimbres

Vertical Case #4	41.469	Bowl	Box 2
	40.5194	Bowl	Box 2
	40.5195	Bowl	Box 2

Arizona Pottery

Vertical Case #5	40.5201	Pottery bowl	Box 2
	40.5199	Pottery canteen	Box 2
	40.5200	Pottery jar	Box 2

Hopi Murals

	40.4927	Dancing gourd	Mural Boxes 1-5
	40.4924 a-d	Mural - Aquatic - Awatovi, Ariz.	" "
	40.4923 a-c	Altar, Awatovi, Ariz.	" "
	40.4926 a-d	Mural A - " "	" "
	40.4921 a-c	Mural B - " "	" "
	40.4925 a-d	Mural C - " "	" "
	40.4920 a-d	Mural " "	" "
	40.4922 a-c	Mural of Falling Warrior! Kawaika-a, Ariz.	" "

LIVING TRADITIONS

Wall map - Living Traditions

The Museum of Modern Art Archives, NY	Collection:	Series.Folder:
	RDH	VIII.50

-3-

The Pueblo Cornplanters

## Introductory Panel #2

Platform #1	41.389	Kachina Doll	Box 3
	41.325	Kachina Doll	Box 3
	41.212	Kachina Doll	Box 3
	41.201	Kachina Doll	Box 3
	41.231	Kachina Doll	Box 3
	41.203	Kachina Doll	Box 3
	41.213	Kachina Doll	Box 3
On Wall	41.71	Mask	Box 4
On Stand Provided	41.111	Wedding robe	Box 5
	41.484	Hopi blanket	Box 5
Platform #2	41.107	Jar	Box 1
	41.109	San Ildefonso bowl	Box 1
	41.181	San Ildefonso bowl	Box 1
Vertical Case #6	41.153	Hopi tile	Box 4
	41.152	Hopi tile	Box 4
	41.157	Hopi tile	Box 4
	41.154	Hopi tile	Box 4
	41.151	Hopi tile	Box 4
	41.155	Hopi tile	Box 4
	41.156	Hopi tile	Box 4
	41.118	Necklace, coral	Box 5
	41.117	Necklace, white shell	Box 5
	41.116	Necklace, turquoise	Box 5
Platform #3	41.108	Acoma jar	Box 1
	41.233	Wedding jar	Box 2
	41.408	Pottery owl	Box 2
	41.175a	Headdress	Box 5
Platform #4	41.167	Zuni jar	Box 1
	41.172	Zuni war god	Box 3
	41.173	Zuni war god	Box 3
	41.326	Zuni bowl	Box 1
On Wall	41.175b	Baton	Box 3

The Navaho Shepherds

## Introductory panel #3

Table Case #1	41.376	Concha belt (Installed)	Box 6
	41.383 a-g	Bridle (Installed)	Box 6
	41.348	Button (Installed)	Box 6
	41.347	Button (Installed)	Box 6

The Museum of Modern Art Archives, NY	Collection:	Series.Folder:
	RDH	VIII.50

The Navaho Shepherds (Continued)

Table Case #1 (Cont'd)	41.351	Button (Installed)	Box 6
	41.750	Tobacco pouch (Installed)	Box 6
	41.748 a-b	Bridle ornaments (Installed)	Box 6
	41.618	Silver bracelet (Installed)	Box 6
	41.740	Silver bracelet (Installed)	Box 6
Box Platform Units	40.5141	Navaho blanket	Box 5
	40.5140	Navaho blanket	Box 5
	40.5143	Navaho blanket	Box 5
	41.470	Navaho blanket	Box 5
	41.471	Navaho blanket	Box 5

The Apache Mountain People

## Introductory Panel #4

Table #1	40.5135	Basket	Box 7
	41.430 a-b	Fiddle	Box 7
	41.2208	Basket, San Carlos Apache	Box 7
	41.2210	Basket Tray, San Carlos Apache	Box 7

The Desert Dwellers of the Southwest

## Introductory Panel #5

Table #2	41.121	Wooden bowl	Box 4
	41.398	Pima basket	Crate 7
	40.4497	Pottery bowl	Box 2
	41.2209	Basket bowl	Box 7

The Seed Gatherers of the Far West

## Introductory Panel #6

Table #3	41.516	Basket jar	Crate 7
	41.553	Work basket	Crate 7

The Hunters of the Plains

## Introductory Panel #7

The Museum of Modern Art Archives, NY	Collection:	Series.Folder:
	RDH	VIII.50

-5-

The Hunters of the Plains (Continued)

On figure and box provided	41.441	Saddle	Box 4
On figure and box provided	41.429	Roach headdress	Box 5
	41.725	Breastplate	Box 4
On Wall	41.786	Quilled armbands	Box 5
	41.432	Fan	Box 4
On figure and box provided	40.5152	Ceremonial pipe	Box 4
On figure and box provided	40.5148	Pipe bag	Box 5
	40.5150	Pipe bag	Box 5
	40.802	Hair ornament	Box 5
On Wall (see diagram)	41.723	Rattle	Box 4
	41.180	Parflache	Box 4
	40.5126	Decorated lance	Box 8
	40.5127	Decorated lance	Box 8
	40.5079	Battle axe	Box 3
	41.296 a-b	Buckskin leggings	Box 5
	40.5072 a-b	Clan pipe	Box 3
	41.128	Shield	Box 4
	40.5192	Ribbon garment	Box 5
	41.1443	Elkskin robe	Box 5
On Wall (see diagram)	( 41.1404a	"The Snakes let Sca-	Box 7
	(	vanger through the sky hole"	
	(	(Color.Repro. and Diagram)	
	( 41.1404b	"Encounter with sky	Box 7
	(	and buffalo people"	
	(	(Color.Repro. and Diagram)	
	( 41.1404c	"Final ascension of	Box 7
	(	scavenger attended by light-	
	(	enings"(Repro. and Diagram)	
	( 41.1404d	"The Red Snake People	Box 7
	(	from Red Mountain"	
	(	(Repro. and Diagram)	
On Stand Provided	41.73	War bonnet	Box 5
<u>The Woodsmen of the East</u>			
Introductory Panel #8			
On Wall	41.2206	Bag, Winnebago	Box 5
	41.2257	Beaded bandolier and	Box 5
		bag, Winnebago	
	41.2207a-b	Pair of beaded broad-	Box 5
		cloth leggings	
	41.440	Wooden mask	Box 4

The Museum of Modern Art Archives, NY	Collection:	Series/ Folder:
	RDH	VIII.50

-3-

The Woodsmen of the East (Continued)

On Wall (Cont'd)	40.5153	Wooden mask	Box 3
	41.438	Corn husk mask	Box 3
Table #4	41.147 a-b	Birch box	Box 3
	41.146	Birch box, Cree	Box 4
	40.5082 a-b	Micmac box	Box 4
	40.5067	Quilled garter	Box 8
	40.5145 a-b	Beaded bandolier	Box 5
	41.714 a-b	Ribbon work leggings	Box 5
	41.2337	Birch bark box	Box 7
On Stand Provided	41.144	Skin coat	Box 5

Salish

Table #5	40.5121	Wooden figure	Box 4
	41.510	Wooden figure	Box 3
	41.512	Wooden figure	Box 3
Free-standing	41.511	Wooden figure	Box 8
Table #6	41.400	Muckleshoot basket	Box 7

Fishermen of the Northwest Coast

Table #6 (continued)	41.1344	Food box	Box 3
	41.1341	Rattle	Box 2
Table #7	41.538	Berry basket	Box 7
	41.437	Copper plaque	Box 4
	40.5205 (on wall above)	Dance wand	Box 8
	41.1345	Headdress	Box 3
	41.148	Copper helmet	Box 1
	41.538	Berry basket	Box 7
	41.567a-b	Cedar chest	Box 3
Table #8	40.5208	Deer rattle	Box 2
	41.540	Horn dish	Box 3
	41.503	Pipe (eagle)	Box 3
	41.504	Pipe (whale)	Box 2
Pedestal #5	41.1295	Deer mother (cast)	Box 3
	41.311	Slate figurine	Box 4
On Wall	41.566	Chilkat blanket	Box 5
	40.5139	Wooden mask	Box 2
	41.298	Wooden mask	Box 4
	41.513	Wooden mask	Box 4
	41.508	Wooden mask	Box 4

The Museum of Modern Art Archives, NY	Collection:	Series.Folder:
	RDH	VIII.50

-7-

Fishermen of the Northwest Coast (Continued)

On Wall (Cont'd)	40.5207	Wooden mask	Box 3
	41.310	Spear	Box 8
	40.5074	House mask	House mask box

Eskimo

## Introductory Panel #9

On Wall (see diagram)	41.581	Fishline	Box 4
	41.543	Spear	Box 8
	41.541	Spear	Box 8
	41.439	Seal mask	House mask box
	40.5095	Mask	Box 3
	40.5090	Mask	Box 3
	40.5092	Mask	Box 5
	40.5091	Mask	Box 3
	40.5088	Mask	Box 3
	40.5206	Mask	Box 3

INDIAN ART FOR MODERN LIVING

Table Case #2	41.355	Silver cup(Installed)	Box 6	
	41.356	Silver cup(Installed)	Box 6	
	41.333	Silver bracelet (Installed)	Box 6	
	41.602	Silver bird pin (Installed)	Box 6	
	41.379	Silver bow guard (Installed)	Box 6	
	41.336	Silver bracelet (Installed)	Box 6	
	41.580	Silver necklace (Installed)	Box 6	
	41.321	Large Zuni pin (Installed)	Box 6	
	41.324	Mosaic dragon fly (Installed)	Box 6	
	41.323	Small Zuni pin (Installed)	Box 6	
	Table Case #3	41.442	Large ivory bear (Installed)	Box 6
		40.5180	Ivory fork (Installed)	Box 6
		40.5167	Small ivory bear (Installed)	Box 6

The Museum of Modern Art Archives, NY	Collection:	Series.Folder:
	RDH	VIII.50

-8-

INDIAN ART FOR MODERN LIVING (Continued)

Table Case #3	40.5159	Ivory whale(Installed)	Box 6
	40.5161	Ivory walrus "	Box 6
	40.5165	Ivory sea-lion "	Box 6
	40.5170	Ivory baby sea-lion (Installed)	Box 6
	41.613	Silver buckle "	Box 6
	41.611	Silver bracelet "	Box 6
	41.612	Silver bracelet "	Box 6
	41.779	Silver pin with tur- quoise(Installed)	Box 6
	41.523	Silver bracelet with turquoise(Installed)	Box 6
	Table #9	40.4495	Black platter
41.428		Red and white belt	Box 5
41.445		Hopi shawl	Box 5
40.4494		Taste paper basket	Box 4
41.782 a-b		Skin boots	Box 5
41.478		Scrap basket	Box 7
On Wall	41.819	Navaho rug	Box 5
	( 41.755.5	Linoleum print	Box 7
	( 41.755.8	Linoleum print	Box 7
	( 41.755.12	Linoleum print	Box 7
	( 41.755.13	Linoleum print	Box 7
	( 41.755.15	Linoleum print	Box 7
	41.776	Seminole ski suit	Box 5
	41.752	"Dancers"(glazed water- color)	Box 7
	41.453	Wooden panel	Box 7

16 Mounted Explanatory Panels - These to be installed and used if desired - Box 7

1. Pueblo
2. Pottery Making - Pueblo
3. Sand\*Painting
4. The Navaho
5. Weaving and Embroidery - Pueblo
6. Basketry - Pueblo
7. Navaho Silver
8. California Basket Making
9. Hunters of the Plains
10. Skin dressing and Painting - Plains Indians
11. Woodwork and Copper - Northwest Coast Indians
12. Northwest Coast and Alaska
13. Chilkat Weaving - Northwest Coast
14. Beadwork
15. Porcupine Quillwork
16. Eastern Woodland Tribes

The Museum of Modern Art Archives, NY	Collection:	Series.Folder:
	RDH	VIII . 50

**THE MUSEUM OF MODERN ART**  
**11 WEST 53RD STREET, NEW YORK**

TELEPHONE: CIRCLE 5-8900



FOR RELEASE \_\_\_\_\_

An exhibition of INDIAN ART OF THE UNITED STATES; organized by the Indian Arts and Crafts Board of the United States Department of the Interior, with the cooperation of the universities and museums of science throughout the country, has been sent to \_\_\_\_\_ by The Museum of Modern Art. It will open at \_\_\_\_\_ on \_\_\_\_\_. After the showing in \_\_\_\_\_, it will be circulated throughout the country by New York's Museum of Modern Art where the exhibition was first shown last winter.

This is the traveling exhibition assembled from the largest and most representative exhibition of its kind ever held. The exhibition consists of three sections. The first, devoted to pre-historic Indian art, shows outstanding objects from the great pre-historic areas. These divisions are: THE SCULPTORS OF THE EAST (stone and wood sculpture, shell jewelry, copper ornaments, pottery); THE PAINTERS OF THE SOUTHWEST (ceramics, weaving and basketry); THE CARVERS OF THE FAR WEST (early stone sculptures of animals); and THE ENGRAVERS OF THE ARTIC (ivory objects with delicate linear patterns.)

The second section deals with the subject of living traditions, still of influence among the various tribes. The areas shown in this section are THE PUEBLO FARMER, THE NAVAHO SHEPHERD, THE APACHE MOUNTAIN DWELLERS, THE SEED GATHERERS OF CALIFORNIA, THE DESERT DWELLER OF ARIZONA, THE HUNTER OF THE PLAINS, THE FISHERMEN OF THE NORTHWEST COAST and THE ESKIMO HUNTER OF THE ARCTIC.

The third section consists of contemporary Indian products - jewelry, clothing, accessories such as belts and embroidery, useful objects for the modern home and garden such as pottery, rugs and a ski suit showing the use of Indian-made ribbon work with modern materials and designs.

This exhibition will close at the \_\_\_\_\_  
 on \_\_\_\_\_\*

The Museum of Modern Art Archives, NY	Collection:	Series.Folder:
	RDH	VIII.50

**THE MUSEUM OF MODERN ART**  
 11 WEST 53RD STREET, NEW YORK  
 TELEPHONE: CIRCLE 5-8900



EXHIBITION OF INDIAN ART OF THE UNITED STATES  
 OPENS AT .....

.....will open on.....  
 an exhibition of Indian Art of the United States. The exhibition, largest and most representative of its kind ever held, was organized by the Indian Arts and Crafts Board of the United States Department of the Interior with the cooperation of universities and museums of science throughout the country for New York's Museum of Modern Art. It is now being circulated throughout the country by the Museum of Modern Art.

The exhibition was assembled under the direction of René d'Harnoncourt, General Manager of the Indian Arts and Crafts Board in collaboration with Frederic H. Douglas, Curator of Indian Art of the Denver Art Museum, and Henry Klumb, architect. Active support has been given by the Commissioners of the Indian Arts and Crafts Board: John Collier, Chairman; Ebert K. Burlew, Dr. A.V.Kidder, James W. Young and Lorenzo Hubbell. The sponsoring institutions are The United States National Museum, Washington, D.C., and The Royal Ontario Museum of Archaeology, Toronto.

The foreword to the book of the exhibition is by Mrs. Franklin D. Roosevelt, who writes as follows:

The White House  
 Washington, D. C.

"At this time, when America is reviewing its cultural resources, this book and the exhibit on which it is based open up to us age-old sources of ideas and forms that have never been fully appreciated. In appraising the Indian's past and present achievements, we realize not only that his heritage constitutes part of the artistic and spiritual wealth of this country, but also that the Indian people of today have a contribution to make toward the America of the future.

"In dealing with Indian art of the United States we find that its sources reach far beyond our borders, both to the north and to the south. Hemispheric interchange of ideas is as old as man on this continent. Long before Columbus, tribes now settled in Arizona brought traditions to this country that were formed in Alaska and Canada; Indian traders from the foot of the Rocky Mountains ex-

The Museum of Modern Art Archives, NY	Collection:	Series.Folder:
	RDH	VIII.50

- 2 -

changed goods and ideas with the great civilizations two thousand miles south of the Rio Grande. Related thoughts and forms that are truly of America are found from the Andes to the Mississippi Valley.

"We acknowledge here a cultural debt not only to the Indians of the United States but to the Indians of both Americas.

(Signed) Eleanor Roosevelt

The exhibition is a cross section of the artistic achievements of the Indians of the United States during the last fifteen hundred years. It contains the finest obtainable examples of the many techniques and design styles which have been perfected throughout this period. Some of the more important prehistoric objects shown are great stone pipes in human form from the prehistoric Indians of Oklahoma; superb pottery in a bewildering range of shapes. Outstanding in the exhibits from the historic period are finely woven and embroidered textiles from many tribes; examples of the beaded and quilled skin clothing; and examples of the grotesque and elaborate wood sculpture of Southeast Alaska.

The modern items include silver cups and goblets by Navaho silversmiths and service plates of black or red pottery suitable for contemporary dinner tables. The adaptability to contemporary fashions of Indian fabrics, bead and braid work and ribbon appliqué made by the modern Indian is shown in an after-ski suit which incorporates the Indian work as part of the design.

The Museum of Modern Art has published an elaborate and comprehensive catalog with 16 color plates, 200 halftones. The book contains 220 pages and has been written by Frederic H. Douglas and René d'Harnoncourt. Like the exhibition it is built around the following general subjects: Tribal Traditions and Progress; Indian Art; Indian Origins and History. In the field of prehistoric art it treats as individual groups The Carvers of the Northwest Coast; The Engravers of the Arctic; The Sculptors of the East; The Painters of the Southwest. The living traditions of the Indian are divided into the following sections: The Pueblo Cornplanters; The Navaho Shepherds; The Apache Mountain People; The Desert Dwellers of the Southwest; The Seed Gatherers of the Far West; The Hunters of the Plains; The Woodsmen of the East; The Fishermen of the Northwest Coast; The Eskimo Hunters of the Arctic.

The Museum of Modern Art Archives, NY	Collection:	Series.Folder:
	RDH	VIII.50

- 3 -

There is also a section in the book on Indian Art for Modern Living. The end papers show Indian designs and give a chart of the chronological relationship between the discovery of the various tribal groups and their cultural developments.

In the introduction to the book the authors comment specifically on the art of the Indian as follows:

"Fine art in the sense of art for art's sake is a concept that is almost unknown in Indian cultures. There are very few aboriginal art forms that have no established function in tribal life. Some of the miniature ivory carvings of the Eskimo may be an exception to the rule since there is no evidence that they serve any specific purpose, but by and large every product made by an Indian artist has a function and is created by him primarily to serve a given end. Artistic merit is simply considered a necessary by-product of good workmanship.

"The close relationship between aesthetic and technical perfection gives the work of most Indian artists a basic unity rarely found in the products of an urban civilization..... The Indian artist, whose simple tools have always forced him to study his raw material in order to discover just what treatment will best utilize its inherent characteristics, has developed a sense of the fitness of form and material that gives distinction to all his work.....

"Beyond general statements little can be said about Indian art that would fit all the various tribes and tribal groups, since each area of Indian culture has an art of its own. Indian art always was and still is regional in the deepest sense of the word. The artists of the Northwest Coast not only portray men and animals of that region but also convey in form and design the very essence of the gloomy fogbound coast with its dark forests and its mysterious animation. Even the Pueblo potter, whose most abstract forms abstain completely from representation, still achieves effects in color and design that are essentially of the Southwest and could not be associated with any other part of the country. Indian art from coast to coast actually recreates the land, America, in every one of the its countless variations."

The following museums and individual lenders throughout the country have cooperated in lending material for the circulating exhibition:

Mr. William H. Claflin, Jr., Belmont, Mass.  
 Mrs. William Denman, San Francisco, Calif.  
 Mr. and Mrs. Kenneth B. Disher, Newton Highlands,  
 Mass.  
 Mrs. René d'Harnoncourt, Washington, D. C.  
 Mr. Frederic H. Douglas, Denver, Colorado  
 Mr. Charles de Young Elkus, San Francisco, Calif.  
 Mr. Earl Morris, Boulder, Colorado  
 Dr. Herbert J. Spinden, New York City  
 Miss Amelia Elizabeth White, Santa Fe, New Mexico  
 The Royal Ontario Museum of Archaeology, Toronto,  
 Canada  
 Museum of the American Indian, Heye Foundation,  
 New York City  
 Peabody Foundation for Archaeology, Andover, Mass.  
 Miss Alice L. Marriott, Oklahoma City, Okla.  
 The Philbrook Art Museum, Tulsa, Okla.  
 University of Oklahoma, Norman, Okla.  
 Ohio State Museum, Columbus, Ohio  
 American Museum of Natural History, New York City  
 University of Arkansas, Fayetteville, Arkansas  
 The Brooklyn Museum, Brooklyn, New York

The Museum of Modern Art Archives, NY	Collection:	Series.Folder:
	RDH	VIII.50

- 4 -

Los Angeles County Museum of History, Science & Art,  
 Los Angeles, California  
 University of Colorado Museum, Boulder, Colorado  
 The Taylor Museum, Colorado Springs, Colorado  
 Earl Morris  
 Indian Arts and Crafts Board, Dept. of the Interior,  
 Washington, D. C.  
 The Denver Art Museum, Denver, Colorado  
 Mr. John Adair, New York City  
 Miss Gladys Tantaquidgeon, Pine Ridge, South Dakota  
 Milwaukee Public Museum  
 Washington State Museum, Seattle, Washington  
 United States National Museum  
 University of California, Berkeley, California

FOR STUDY PURPOSES ONLY. NOT FOR REPRODUCTION.

The Museum of Modern Art Archives, NY	Collection:	Series.Folder:
	RDH	VIII. 50

FORM LETTER III

Date

Dear .....

The exhibition of Indian Art of the United States is scheduled, as you know to close at the ..... on ..... I am enclosing Packing Instructions and a Box List. Will you please see that these are carefully followed by your men? Each item should be checked on the list as it is repacked.

The Indian show is scheduled to open next in ....., on ..... Please have it shipped by Railway Express Collect on , ..... , addressed to:

Person in Charge  
Institution  
Address

A valuation of 50¢ per pound should be declared on the shipment. It might be wise to have the exhibition shipped in sections, that is, whenever a section of the show is repacked, it could be shipped along before the rest of the show is packed.

I trust that you will have no difficulty repacking the exhibition. If there should be any questions, please let me know.

Has the exhibition been well received during its ..... appearance? I will be very pleased to receive extra copies which you might have of publicity relating to your showing.

Very sincerely yours,

Enclosures: Packing Instructions  
Box List - *Circle pp. 1, 2 & 4*

Bill: to Miss Parish

FOR STUDY PURPOSES ONLY. NOT FOR REPRODUCTION.

The Museum of Modern Art Archives, NY	Collection:	Series.Folder:
	RDH	VIII.50

INDIAN ART OF THE UNITED STATES

An exhibition circulated by The Museum of Modern Art, New York City

PACKING INSTRUCTIONS -- BOX #1 -- 8 Pottery bowls

1. The objects to be packed in this box are listed in the Box List of the exhibition.
2. Each bowl must be filled with excelsior. Wrap each bowl separately in tissue paper and heavy wrapping paper.
3. Place each object in the section of the box marked with the same number as the object. Surround each object well with excelsior - on all sides, bottom and top.
4. Place sheet of corrugated board in box last. Place cover on box and fasten securely. Be sure iron washers are on screws before attaching screw heads.

PACKING INSTRUCTIONS -- BOXES #2, #3, #4, and #5 -- Objects

1. The objects to be packed in each of these boxes are listed in the Box List of the exhibition.
2. In Box #3, wrap carefully in tissue and place in object 41.1344, the following: 41.1295, 41.1345, 41.1374, 41.1375, 41.1631 - 1638.  
  
Also in Box #3, wrap carefully in tissue and place in object 41.567a-b, the following: 40.5207 and 40.5153.  
  
Also in Box #3, wrap carefully in tissue and place in object 41.147a-b, the following: 41.640, 41.642, 41.641, 41.639, 41.487, 41.636.
3. In Box #4, wrap carefully in tissue and place in object 40.5082a-b, the following: 41.151, 41.152, 41.153, 41.154, 41.155, 41.156, 41.157.  
  
In Box #4, wrap 41.311 carefully in tissue and place in 41.146; 41.472 in 41.121; 41.581 in 40.4494. Special board should be used in packing object 41.71 (headdress).
4. Wrap each object carefully in tissue paper and heavy wrapping paper. Place those objects which have special compartments in the section marked with their number.  
  
As each object is placed in a box, surround the piece thoroughly with excelsior. Fill bowls solidly with excelsior.
5. Place sheet of corrugated board in box last. Place cover on box and fasten securely. Be sure iron washers are on screws before attaching screw heads.

The Museum of Modern Art Archives, NY	Collection:	Series.Folder:
	RDH	VIII.50

-2-

PACKING INSTRUCTIONS -- BOX #6 -- 3 Table Cases and 6 Leg Supports.

1. Slide 3 Table Case tops, one at a time, into the special grooves for them. Be careful not to scratch plexiglass tops. All tops should face in same direction.
2. Wrap each of the 6 Leg Supports separately in heavy wrapping paper. Slide them into partition at one side of box, staggering or overlapping them, so that they are firmly placed in the crate.  
  
A sheet of corrugated board should be placed between each leg support. Excelsior-filled pads should be placed at ends, between each leg support to prevent movement in the box.
3. Place cover on box and fasten securely. Be sure iron washers are on screws before attaching screw heads.

PACKING INSTRUCTIONS -- BOX #7 -- Objects, labels, poster, mats, watercolors, 8 Introductory Panels.

1. Place 4 mounted color reproductions of sand paintings (41.1404 a-d) face to face, with tissue paper between. Wrap in heavy wrapping paper and place in bottom of box.
2. Place 1 mount of linoleum prints (41.755.5, 41.755.8, 41.755.12, 41.755.13, 41.755.15) and exhibition poster face to face with tissue paper between. Wrap in heavy brown wrapping paper and place in box next.
3. Cover wood panel, 41.453, with corrugated board sheet and wrap in heavy paper. Place in box next.
4. Place 16 explanatory panels face to face with tissue paper between; wrap in heavy wrapping paper. Place in box.
5. Divide exhibition labels into 5 groups of like sizes. Place labels face to face with tissue paper between. Wrap each of 5 groups in heavy wrapping paper.
6. Place strips of masking tape across glass of watercolor (41.762). Wrap carefully with corrugated board and place in bottom section of box.
7. When the above are evenly spaced in bottom of box, cover with sheet of corrugated board.
8. The objects to be packed in the upper section of this box are listed in the Box List. Wrap each object in tissue paper and heavy wrapping paper.  
  
Wrap carefully in tissue and pack in 41.400, the following: 41.538, 41.478, 41.430a=b.

Surround all objects thoroughly with excelsior.

The Museum of Modern Art Archives, NY	Collection:	Series.Folder:
	RDH	VIII.50

-3-

9. Place sheet of corrugated board in box last. Place cover on box and fasten securely. Be sure iron washers are on screws before attaching screw heads.

PACKING INSTRUCTIONS - BOX #8 - Objects

1. The objects to be packed in this box are listed in the Box List.
2. Place stone totem, 41.309, in special compartment in bottom of box. Surround thoroughly with excelsior - on all sides, top and bottom.
3. Wrap each piece in tissue paper and heavy wrapping paper. Place objects in box and surround thoroughly with excelsior.
4. Place sheet of corrugated board in box last. Place cover on box and fasten securely. Be sure iron washers are on screws before attaching screw heads.

PACKING INSTRUCTIONS - CRATE #1 - 9 Tops of T-shaped tables

1. Place 7 large table tops in crate, one at a time, with sheet of corrugated board between each table top. The tops should be face to face and back to back.  
  
Place 2 small table tops side by side on top of the larger ones. Place sheet of corrugated board in crate last.
2. Place cover on box and fasten securely. Be sure iron washers are on screws before attaching screw heads.

PACKING INSTRUCTIONS - CRATE #2 - Leg-supports for 9 T-shaped tables.

1. Place 7 large table supports in box, one at a time, with sheet of corrugated board between each.
2. Place 2 small table supports on top, side by side, with block of corrugated-covered wood separating each. Place sheet of corrugated board on top.
3. Place cover on box and fasten securely. Be sure iron washers are on screws before attaching screw heads.

PACKING INSTRUCTIONS - CRATES #3 and #4 - 6 Box Stands each

1. Stand crate on side. Slide box stands into crate one at a time.  
  
Place sheet of waterproof paper between each box stand.  
  
Place sheet of waterproof paper on top.

The Museum of Modern Art Archives, NY	Collection:	Series.Folder:
	RDH	VIII.50

-4-

2. Place cover on box and fasten securely. Be sure iron washers are on screws before attaching screw heads.

PACKING INSTRUCTIONS - C R A T E #5 - Vertical Cases #3, #4, #5, #6, and 2 Wall Maps.

1. Dismantle and collapse the 4 Vertical Cases. Tie cord around each case.
2. Place each case in crate one at a time, with tops of cases facing center of box.
3. Sheet of corrugated board must be placed in center of box, between tops of cases. Place large sheet of corrugated board on top, after cases have been placed in box.
4. Wrap each map in heavy wrapping paper. Place large map in crate first, then smaller map.  
  
Adjust two braces with angle irons so that two maps are held securely in crate. Tighten screws.
5. Place cover on crate and fasten securely. Be sure iron washers are on screws before attaching screw heads.

PACKING INSTRUCTIONS - C R A T E #6 - Vertical Cases #1 and #2

1. Dismantle and collapse the 2 Vertical Cases. Tie cord around each case.
2. Place each case in crate one at a time.
3. Place large sheet of corrugated board on top, after cases have been placed in box.
4. Place cover on box and fasten securely. Be sure iron washers are on screws before attaching screw heads.

PACKING INSTRUCTIONS - C R A T E #7 - 5 Pedestals, small blocks or pedestals, objects.

1. Wrap Pedestals #1, #2, #3, #4, and #5 in heavy wrapping paper. Place in crate and surround thoroughly with excelsior, filling all empty spaces.
2. Wrap various small pedestals in heavy wrapping paper and place in crate next. Surround with excelsior.
3. Wrap carefully in tissue paper and pack in 41.553, the following: 41.515, 41.398 and 41.1662. Surround 41.5153 with excelsior

The Museum of Modern Art Archives, NY	Collection:	Series.Folder:
	RDH	VIII . 50

- Place cover on crate and fasten securely. Be sure iron washers are on screws before attaching screw heads.

PACKING INSTRUCTIONS - CRATE #8 - 4 Platforms with collapsible sides.

- Platforms #1, #2, #3 and #4 go into this case.
- Place tops and bases in crate in the following order:

Top 3B )  
" 1B ) side by side

Top 2B )  
" 4B ) side by side

Base 2A )  
" 4A ) side by side

Base 1A

Base 3A

- Bases 1A and 3A are placed on top of one another to one side of the box.  
Place sheet of corrugated board between each layer of tops and bases.
- Adjust two braces with angle irons so that platforms are held firmly in place. Tighten screw on angle irons.
- Place cover on crate and fasten securely. Be sure iron washers are on screws before attaching screw heads.

PACKING INSTRUCTIONS - CRATE #9 - 15 Stands

- The following stands are packed in this crate:
  - 5 Navaho Blanket Stands - for Navaho blankets #40.5141, 40.5140, 40.5143, 41.470, 41.471.
  - 1 Stand - for wedding robe #41.111
  - 1 Headdress stand - for Zuni headdress 41.175a
  - 1 Headdress stand - for headdress #41.1345
  - 1 Stand - for copper helmet #41.148
  - 1 Stand - for War Bonnet #41.73
  - 1 Stand - for Hopi Blanket #41.484
  - 1 Stand - for skin coat #41.144
  - 3 Stands in form of Cactus, Human and Horse
- Place stands in crate one at a time. Surround thoroughly with excelsior.
- Place cover on crate and fasten securely. Be sure iron washers are on screws before attaching screw heads.

The Museum of Modern Art Archives, NY	Collection:	Series.Folder:
	RDH	VIII.50

-6-

PACKING INSTRUCTIONS -- BOXES #1, #2, #3, #4 and #5 -- Hopi murals

1. In Box #1, are packed Panels #1 through #6.  
In Box #2, are packed Panels #7 through #12.  
In Box #3, are packed Panels #13 through #18.  
In Box #4, are packed Panels #21 through #26.  
In Box #5, are packed Panels #19 and #20, braces, bolts, 4 end pieces and hohokam strip.
2. The panels should be packed in each box face to face, back to back, with sheet of corrugated board between each two.
3. In Box #1, small "squash" mural and mural label are packed side by side on the top.
4. In Box #5, before placing murals in box, pack 52 braces in flat rows in special partitions in bottom of box. 27 bolts are placed in special section at one corner of box. 1 small bird cut-out is packed in special compartment on bottom of box.

Also in Box #5, place 2 end pieces side by side and the other two end pieces side by side face to face, on top of mural panels 19 and 20.

Also in Box #5, wrap each of 3 Hohokam strips in wrapping paper and place in box last on top of murals.

PACKING INSTRUCTIONS -- BOX -- Milwaukee House Mask

1. Place house mask in box, fitting it into the rubber pads on the bottom of the box.
2. Place 2 braces in position, one over forehead of figure, one over mouth, and fasten securely.
3. Place cover on box and fasten securely. Be sure washers are on screws before attaching screw heads.

FOR STUDY PURPOSES ONLY. NOT FOR REPRODUCTION.

The Museum of Modern Art Archives, NY	Collection:	Series.Folder:
	RDH	VIII.50

INDIAN ART OF THE UNITED STATES

An exhibition circulated by The Museum of Modern Art, New York City

BOX LIST

	<u>Mus. No.</u>	<u>Object</u>	<u>Installation</u>
Box #1 -	41.167	Zuni jar	Platform #4
	41.108	Acoma jar	Platform #3
	41.107	Pueblo jar	Platform #2
	41.181	San Ildefonso bowl	Platform #2
	41.326	Zuni bowl	Platform #4
	41.109	San Ildefonso bowl	Platform #2
	41.148	Copper helmet	Table #7
	41.275	Female Figure, Ga.	Vertical Case #3
Box #2 -	<del>40.5231</del>	<del>Pottery fragment</del>	<del>Pedestal #4</del>
	41.408	Pottery owl	Platform #3
	40.5200	Pottery jar	Vertical Case #5
	41.233	Wedding jar	Platform #3
	40.5139	Wooden mask	Wall
	40.5194	Bowl	Vertical Case #4
	41.469	Bowl	Vertical Case #4
	40.5201	Pottery bowl	Vertical Case #5
	40.5195	Bowl	Vertical Case #4
	40.5199	Pottery Canteen	Vertical Case #5
	40.4497	Pottery bowl	Table #2
	40.5208	Bear Rattle	Table #8
	41.504	Pipe (whale)	Table #8
	41.1341	Rattle	Table #6
	41.1663	Bird pipe	Vertical Case #2
Box #3 -	( 41.1344	Food box	Table #6
	( 41.1295	Bear mother	Pedestal #5
	( 41.1345	Headdress	Table #7
	( 41.1374	Shell Gorget	Wall Case #1a
	( 41.1375	Shell Gorget	Wall Case #1a
	( 41.1631-1638	Shell Gorgets	Wall Case #1a
	41.510	Wooden figure	Table #5
	41.512	Wooden figure	Table #5
	40.5088	Mask	Wall
	41.172	Zuni War God	Platform #4
	41.540	Horn dish	Table #8
	40.5090	Mask	Wall
	40.5091	Mask	Wall
	40.5206	Mask	Wall
	40.5095	Mask	Wall
	40.5079	Battle axe	Wall
	41.1376	Monitor pipe	Vertical Case #2

The Museum of Modern Art Archives, NY	Collection:	Series.Folder:
	RDH	VIII.50

-2-

Box #3 (Cont'd)	41.521	Stone pipe	Vertical Case #2
	41.503	Pipe (eagle)	Table #8
	( 41.567 a-b	Cedar chest	Table #7
	( 40.5207	Wooden mask	Wall
	( 40.5153	Wooden mask	Wall
	( 41.147 a-b	Birch box	Table #4
	( 41.640	Banner stone	Vertical Case #1
	( 41.642	Banner stone	Vertical Case #1
	( 41.641	Banner stone	Vertical Case #1
	( 41.639	Banner stone	Vertical Case #1
	( 41.487	Bird stone	Vertical Case #1
	( 41.636	Banner stone	Vertical Case #1
	41.175 b	Baton	Wall
	<del>40.5072 a-b</del>	<del>Clan pipe</del>	<del>Wall</del>
	41.212	Kachina doll	Platform #1
	41.203	" "	" #1
	41.201	" "	" #1
	41.213	" "	" #1
	41.325	" "	" #1
	41.389	" "	" #1
	41.231	" "	" #1
	41.438	Corn husk mask	Wall #1
	41.173	Zuni War God	Platform #4
	41.1483	Adena Man	Pedestal #3
	41.1485	Stone pipe(cast)	Vertical Case #3
	41.1486	Stone pipe(cast)	Vertical Case #3
		Stands for some of the Kachina dolls	
		4 sticks, painted grey	
Box #4	41.725	Brestplate	Human figure
	41.180	Parfleche	Wall
	41.513	Wood mask	Wall
	41.298	Wood mask	Wall
	41.440	Wood mask	Wall
	41.508	Wood mask	Wall
	41.71	Mask	Wall
	41.138	Shield	Wall
	40.5152	Ceremonial pipe	Human figure
	41.723	Rattle	Wall
	41.432	Fan	Wall
	( 40.5082 a-b	Micmac box	Table #4
	( 41.151	Hopi tile	Vertical Case #6
	( 41.152	Hopi tile	Vertical Case #6
	( 41.153	Hopi tile	Vertical Case #6
	( 41.154	Hopi tile	Vertical Case #6
	( 41.155	Hopi tile	Vertical Case #6
	( 41.157	Hopi tile	Vertical Case #6
	( 41.156	Hopi tile	Vertical Case #6

The Museum of Modern Art Archives, NY	Collection:	Series.Folder:
	RDH	VIII.50

-3-

Box #4 (Cont'd)	(41.146 (41.311	Birch box Slate figurine	Table #4 Pedestal #5
	41.441 40.5121 40.4495	Saddle Wooden figure Black platter	Horse figure Table #5 Table #9
	(41.121 (41.472	Wooden bowl Stone pipe	Table #2 Vertical Case #2
	41.437	Copper plaque	Table #7
	(40.4494 (41.581	Waste paper basket Fishline	Table #9 Wall
Box #5	41.566 40.5092 40.802 40.5145 a-b 40.5148 40.5150 41.714 a-b 41.175 a 41.786 a-b 41.429 41.296 a-b 41.73 41.819 41.1443 41.144 41.445 41.111 41.484 41.776 a-b 41.782 a-b 40.5192 41.428 41.116 41.117 41.118 41.470 a-b 40.5143 40.5141 40.5140 41.471 41.2207 a-b  41.2206 41.2257	Chilkat blanket Mask Hair ornament Beaded bandolier Pipe bag Pipe bag Ribbon Work leggings Headdress Quilled armbands Rouch headdress Buckskin leggings War bonnet Navaho rug Elkskin robe Skin coat Hopi shawl Wedding robe Hopi blanket After-ski suit Skin boots Ribbon garment Red and white belt Necklace, turquoise Necklace, white shell Necklace, coral Navaho blanket Navaho blanket Navaho blanket Navaho blanket Navaho blanket Black leggings beaded in white Woven bag Pottawatomie bandolier Large colored map Photograph of deer head Photograph of Adena man	Wall Wall Human figure Table #4 Cactus form Cactus form Table #4 Platform #3 Wall Human form Wall Stand Wall Wall Stand Table #9 Stand Stand Wall Table #9 Wall Table #9 Wall Table #9 Vertical Case #6 " " #6 " " #6 Box units Box units Box units Box units Box units Wall  Wall Wall

FOR STUDY PURPOSES ONLY. NOT FOR REPRODUCTION.

The Museum of Modern Art Archives, NY	Collection:	Series.Folder:
	RDH	VIII.50

-4-

Box #3	3 Table Cases and 6 Leg Supports - containing objects permanently installed (Navaho silver, modern silver and ivory carvings.)		
Box #7	( 41.400	Muckleshoot basket	Table #6
	( 41.538	Berry basket	Table #7
	( 41.478	Scrap basket	Table #9
	( 41.430 a-b	Fiddle	Table #1
	41.762	"Dancers" (watercolor)	Wall
	40.5135	Basket	Table #1
	40.5107	Ivory drum handle	Wall Case #1(Permanently Installed)
	41.672	Coyote shell	Wall Case #2 (Permanently Installed)
	41.165	Frog shell	Wall Case #2(Permanently Installed)
	41.166	Frog shell	Wall Case #2(Permanently Installed)
	40.5232	Stone palette	Wall Case #2(Permanently Installed)
	40.5198	Basket	Hanging
	41.1404 a-d	4 mounted sand painting reproductions.	Wall
	41.755.5	Linoleum print)	
	41.755.8	Linoleum print)	
	41.755.12	Linoleum print)	Mounted and on wall
	41.755.13	Linoleum print)	
	41.755.15	Linoleum print)	
	41.453	Wooden panel	Wall
	41.2337 a-b	Embroidered bark box	Table #4
	41.2210	Basket tray	Table #1
	41.2209	Basket bowl	Table #2
	41.2208	Scrap basket	Table #1
		Poster for exhibition	
		16 explanatory panels	
		Labels for exhibition	
Box #8	<del>40.5007</del>	<del>Quilled garter</del>	<del>Table #4</del>
	40.5205	Dance Wand	Table #7
	41.310	Spear	Wall
	40.5126	Decorated lance	Wall
	40.5127	Decorated lance	Wall
	41.541	Spear	Wall
	41.543	Spear	Wall
	41.511	Wooden figure	Free-standing
	41.309	Stone totem	Pedestal #1
		Stands for lance, Zuni gods, etc.	
Crate #1	9 Tops of T-shaped Tables		
Crate #2	9 Leg-Supports for 9 T-shaped Tables		
Crates #3 and #4	12 Box Stands (6 each)		

The Museum of Modern Art Archives, NY	Collection:	Series.Folder:
	RDH	VIII . 50

-5-

Crate #5		4 Vertical Cases, 2 Maps (Vertical Cases #3, #4, #5 and #5)
Crate #6		2 Vertical Cases (#1 and #2)
Crate #7	( 41.553	5 Pedestals; small blocks or pedestals
	( 41.516	Work basket Table #3
	( 41.398	Basket jar Table #3
	( 41.1662	Pima jar Table #2
		Bird pipe (in 41.516) Vertical Case #2
Crate #8		4 Platforms with collapsible sides
Crate #9		15 Stands
Milwaukee House	41.5074	Milwaukee house mask Wall
Mask Box	41.439	Seal mask Wall
		Package of masonite effigies Wall
Hopi Mural Box #1		Panels #1 through #6
	41.4927	"Dancing Gourd" mural
Hopi Mural Box #2		Panels #7 through #12
Hopi Mural Box #3		Panels #13 through #18
Hopi Mural Box #4		Panels #21 through #26
Hopi Mural Box #5		Panels #19 through #20, braces bolts 4 end pieces

FOR STUDY PURPOSES ONLY. NOT FOR REPRODUCTION.

The Museum of Modern Art Archives, NY	Collection:	Series.Folder:
	RDH	VIII.50

INDIAN ART OF THE UNITED STATES

An exhibition circulated by The Museum of Modern Art, New York City

INSTALLATION LIST

Poster for the exhibition

Box 7

<u>Installation Unit</u>	<u>Museum No.</u>	<u>Object</u>	<u>Packing Box</u>
--------------------------	-------------------	---------------	--------------------

PREHISTORIC

Map - Ancient People of the Northern Woodlands

Carvers of the Northwest Coast

Pedestal #1	41.309	Stone Totem	Box 8
-------------	--------	-------------	-------

Engravers of the Arctic

Wall Case #1	40.5107	Ivory Drum Handle (Installed)	Box 7
--------------	---------	----------------------------------	-------

Sculptors of the East

Vertical Case #1	41.636	Banner Stone	Box 3
	41.639	Banner Stone	Box 3
	41.640	Banner Stone	Box 3
	41.641	Banner Stone	Box 3
	41.642	Banner Stone	Box 3
	41.487	Bird Stone	Box 3
Vertical Case #2	41.1376	Monitor Pipe	Box 3
	41.472	Stone Pipe	Box 4
	41.521	Stone Pipe	Box 3
	41.1662	Bird Pipe	Crate 7
	41.1663	Bird Pipe	Box 2
Wall Case #1a	41.1631 - 1638	Shell Gorgets	Box 3
	41.1374	Shell Gorgets	Box 3
	41.1375	Shell Gorgets	Box 3
Vertical Case #3	41.275	Female Figure Georgia (cast)	Box 1
	41.1485	Stone Pipe (cast)	Box 3
	41.1486	Stone Pipe (cast)	Box 3

The Museum of Modern Art Archives, NY	Collection:	Series.Folder:
	RDH	VIII.50

-2-

Sculptors of the East (Continued)

Podestal #3	41.1483	Adena Man	Box 3
Enlarged Photo	No number	Adena Man	Box 5

The Painters of the Southwest - Hohokam

Wall Case #2	41.672	Coyote shell (Installed)	Box 7
	41.165	Frog shell (large) (Installed)	Box 7
	41.166	Frog Shell (small) (Installed)	Box 7
	40.5232	Stone Palette (Installed)	Box 7
Podestal #4	40.5231	Pottery fragment	Box 2
Hanging	40.5198	Basket	Box 7

Mimbres

Vertical Case #4	41.469	Bowl	Box 2
	40.5194	Bowl	Box 2
	40.5195	Bowl	Box 2

Arizona Pottery

Vertical Case #5	40.5301	Pottery bowl	Box 2
	40.5199	Pottery canteen	Box 2
	40.5200	Pottery jar	Box 2

Hopi Murals

40.4927	Dancing gourd	Mural Boxes
40.4924 a-d	Mural - Aquatic - Awatovi, Ariz.	" " 1-5
40.4923 a-c	Altar, Awatovi, Ariz.	" "
40.4926 a-d	Mural A - " "	" "
40.4921 a-c	Mural B - " "	" "
40.4925 a-d	Mural C - " "	" "
40.4920 a-d	Mural " " "	" "
40.4922 a-c	Mural of Falling Warrior, Kawaika-a, Ariz.	" "

LIVING TRADITIONS

Wall map - Living Traditions

The Museum of Modern Art Archives, NY	Collection:	Series.Folder:
	RDH	VIII . 50

-3-

The Pueblo Cornplanters

## Introductory Panel #2

Platform #1	41.389	Kachina Doll	Box 3
	41.225	Kachina Doll	Box 3
	41.212	Kachina Doll	Box 3
	41.201	Kachina Doll	Box 3
	41.231	Kachina Doll	Box 3
	41.203	Kachina Doll	Box 3
	41.213	Kachina Doll	Box 3
On Wall	41.71	Mask	Box 4
On Stand Provided	41.111	Wedding robe	Box 5
	41.484	Hopi blanket	Box 5
Platform #2	41.107	Jar	Box 1
	41.109	San Ildefonso bowl	Box 1
	41.181	San Ildefonso bowl	Box 1
Vertical Case #6	41.153	Hopi tile	Box 4
	41.152	Hopi tile	Box 4
	41.157	Hopi tile	Box 4
	41.154	Hopi tile	Box 4
	41.151	Hopi tile	Box 4
	41.155	Hopi tile	Box 4
	41.156	Hopi tile	Box 4
	41.118	Necklace, coral	Box 5
	41.117	Necklace, white shell	Box 5
	41.116	Necklace, turquoise	Box 5
Platform #3	41.108	Acoma jar	Box 1
	41.233	Wedding jar	Box 2
	41.408	Pottery owl	Box 2
	41.175a	Headdress	Box 5
Platform #4	41.167	Zuni jar	Box 1
	41.172	Zuni war god	Box 3
	41.173	Zuni war god	Box 3
	41.336	Zuni bowl	Box 1
On Wall	41.175b	Baton	Box 3

The Navaho Shepherds

## Introductory panel #3

Table Case #1	41.375	Concha belt (Installed)	Box 6
	41.383 a-g	Bridle (Installed)	Box 6
	41.348	Button (Installed)	Box 6
	41.347	Button (Installed)	Box 6

The Museum of Modern Art Archives, NY	Collection:	Series.Folder:
	RDH	VIII.50

The Navaho Shepherds (Continued)

Table Case #1 (Cont'd)	41.351	Button (Installed)	Box 6
	41.750	Tobacco pouch (Installed)	Box 6
	41.748 a-b	Bridle ornaments (Installed)	Box 6
	41.618	Silver bracelet (Installed)	Box 6
	41.740	Silver bracelet (Installed)	Box 6
Box Platform Units	40.5141	Navaho blanket	Box 5
	40.5140	Navaho blanket	Box 5
	40.5143	Navaho blanket	Box 5
	41.470	Navaho blanket	Box 5
	41.471	Navaho blanket	Box 5

The Apache Mountain People

## Introductory Panel #4

Table #1	40.5135	Basket	Box 7
	41.430 a-b	Fiddle	Box 7
	41.2208	Basket, San Carlos Apache	Box 7
	41.2210	Basket Tray, San Carlos Apache	Box 7

The Desert Dwellers of the Southwest

## Introductory Panel #5

Table #2	41.131	Wooden bowl	Box 4
	41.398	Pima basket	Crate 7
	40.4497	Pottery bowl	Box 2
	41.2209	Basket bowl	Box 7

The Seed Gatherers of the Far West

## Introductory Panel #6

Table #3	41.516	Basket jar	Crate 7
	41.553	Work basket	Crate 7

The Hunters of the Plains

## Introductory Panel #7

The Museum of Modern Art Archives, NY	Collection:	Series.Folder:
	RDH	VIII .50

-5-

The Hunters of the Plains (Continued)

On figure and box provided	41.441	Saddle	Box 4
On figure and box provided	41.429	Roach headdress	Box 5
	41.725	Breastplate	Box 4
On Wall	41.786	Quilled armbands	Box 5
	41.432	Fan	Box 4
On figure and box provided	40.5152	Ceremonial pipe	Box 4
On figure and box provided	40.5148	Pipe bag	Box 5
	40.5150	Pipe bag	Box 5
	40.802	Hair ornament	Box 5
On Wall (see diagram)	41.723	Rattle	Box 4
	41.180	Parflache	Box 4
	40.5126	Decorated lance	Box 8
	40.5127	Decorated lance	Box 8
	40.5079	Battle axe	Box 3
	41.296 a-b	Buckskin leggings	Box 5
	40.5072 a-b	Clan pipe	Box 3
	41.128	Shield	Box 4
	40.5192	Ribbon garment	Box 5
	41.1443	Elkskin robe	Box 5
On Wall (see diagram)	( 41.140-a	"The Snakes let Sca-	Box 7
	(	vanger through the sky hole"	
	( 41.140+b	(Color.Repro. and Diagram)	
	(	"Encounter with sky	Box 7
	(	and buffalo people"	
	(	(Color.Repro. and Diagram)	
	( 41.140-c	"Final ascension of	Box 7
	(	scavenger attended by light-	
	(	enings"(Repro. and Diagram)	
	( 41.140-d	"The Red Snake People	Box 7
	(	from Red Mountain"	
	(	(Repro. and Diagram)	
On Stand Provided	41.73	War bonnet	Box 5

The Woodsmen of the East

## Introductory Panel #8

On Wall	41.2206	Bag, Winnebago	Box 5
	41.2257	Beaded bandolier and	Box 5
		bag, Winnebago	
	41.2307a-b	Pair of beaded broad-	Box 5
		cloth leggings	
	41.440	Wooden mask	Box 4

The Museum of Modern Art Archives, NY	Collection:	Series.Folder:
	RDH	VIII.50

-5-

The Woodsmen of the East (Continued)

On Wall (Cont'd)	40.5153	Wooden mask	Box 3
	41.438	Corn husk mask	Box 3
Table #1	41.147 a-b	Birch box	Box 3
	41.146	Birch box, Cree	Box 4
	40.5082 a-b	Micmac box	Box 4
	40.5087	Quilled garter	Box 8
	40.5145 a-b	Beaded bandolier	Box 5
	41.714 a-b	Ribbon work leggings	Box 5
	41.2337	Birch bark box	Box 7
	41.144	Skin coat	Box 5

Selish

Table #5	40.5121	Wooden figure	Box 4
	41.510	Wooden figure	Box 3
	41.512	Wooden figure	Box 3
Free-standing	41.511	Wooden figure	Box 8
Table #6	41.400	Muckleshoot basket	Box 7

Fishermen of the Northwest Coast

Table #5 (continued)	41.1344	Food box	Box 3
	41.1341	Rattle	Box 2
Table #7	41.538	Berry basket	Box 7
	41.437	Copper plaque	Box 4
	40.5205 (on wall above)	Dance wand	Box 8
	41.1345	Headdress	Box 3
	41.148	Copper helmet	Box 1
	41.538	Berry basket	Box 7
	41.567a-b	Cedar chest	Box 3
Table #8	40.5208	Bear rattle	Box 2
	41.540	Horn dish	Box 3
	41.503	Pipe (eagle)	Box 3
	41.504	Pipe (whale)	Box 2
Pedestal #5	41.1295	Bear mother (cast)	Box 3
	41.311	Slate figurine	Box 4
On Wall	41.566	Chilkat blanket	Box 5
	40.5139	Wooden mask	Box 2
	41.298	Wooden mask	Box 4
	41.513	Wooden mask	Box 4
	41.508	Wooden mask	Box 4

The Museum of Modern Art Archives, NY	Collection:	Series.Folder:
	RDH	VIII.50

-7-

Fishermen of the Northwest Coast (Continued)

On Wall (Cont'd)	40.5207	Wooden mask	Box 3
	41.310	Spear	Box 8
	40.5074	House mask	House mask box

Eskimo

## Introductory Panel #9

On Wall (see diagram)	41.581	Fishline	Box 4
	41.543	Spear	Box 8
	41.541	Spear	Box 8
	41.439	Seal mask	House mask box
	40.5095	Mask	Box 3
	40.5090	Mask	Box 3
	40.5092	Mask	Box 5
	40.5091	Mask	Box 3
	40.5088	Mask	Box 3
	40.5205	Mask	Box 3

INDIAN ART FOR MODERN LIVING

Table Case #2	41.355	Silver cup(Installed)	Box 5	
	41.356	Silver cup(Installed)	Box 6	
	41.333	Silver bracelet (Installed)	Box 6	
	41.602	Silver bird pin (Installed)	Box 6	
	41.379	Silver bow guard (Installed)	Box 6	
	41.336	Silver bracelet (Installed)	Box 6	
	41.580	Silver necklace (Installed)	Box 6	
	41.621	Large Zuni pin (Installed)	Box 6	
	41.824	Mosaic dragon fly (Installed)	Box 6	
	41.823	Small Zuni pin (Installed)	Box 6	
	Table Case #3	41.442	Large ivory bear (Installed)	Box 6
		40.5180	Ivory fork (Installed)	Box 6
		40.5167	Small ivory bear (Installed)	Box 6

The Museum of Modern Art Archives, NY	Collection:	Series.Folder:
	RDH	VIII.50

-8-

INDIAN ART FOR MODERN LIVING (Continued)

Table Case #3	40.5159	Ivory whale(Installed)	Box 6
	40.5161	Ivory walrus "	Box 6
	40.5163	Ivory sea-lion "	Box 6
	40.5170	Ivory baby sea-lion (Installed)	Box 6
	41.613	Silver buckle "	Box 6
	41.611	Silver bracelet "	Box 6
	41.612	Silver bracelet "	Box 6
	41.779	Silver pin with tur- quoise(Installed)	Box 6
	41.523	Silver bracelet with turquoise(Installed)	Box 6
	Table #9	40.4495	Black platter
41.428		Red and white belt	Box 5
41.445		Hopi shawl	Box 5
40.4494		Taste paper basket	Box 4
41.782 a-b		Skin boots	Box 5
41.478		Scrap basket	Box 7
On Wall  Mounted	41.819	Navaho rug	Box 5
	( 41.755.5	Linoleum print	Box 7
	( 41.755.8	Linoleum print	Box 7
	( 41.755.12	Linoleum print	Box 7
	( 41.755.13	Linoleum print	Box 7
	( 41.755.15	Linoleum print	Box 7
	41.776	Seminole ski suit	Box 5
	41.762	"Dancers"(glazed water- color)	Box 7
	41.453	Wooden panel	Box 7

16 Mounted Explanatory Panels - These to be installed and used if desired - Box 7

1. Pueblo
2. Pottery Making - Pueblo
3. Sand\*Painting
4. The Navaho
5. Weaving and Embroidery - Pueblo
6. Basketry - Pueblo
7. Navaho Silver
8. California Basket Making
9. Hunters of the Plains
10. Skin dressing and Painting - Plains Indians
11. Woodwork and Copper - Northwest Coast Indians
12. Northwest Coast and Alaska
13. Chilkat Weaving - Northwest Coast
14. Bendwork
15. Porcupine Quillwork
16. Eastern Woodland Tribes