

CONDITIONS OF USE FOR THIS PDF

The images contained within this PDF may be used for private study, scholarship, and research only. They may not be published in print, posted on the internet, or exhibited. They may not be donated, sold, or otherwise transferred to another individual or repository without the written permission of The Museum of Modern Art Archives.

When publication is intended, publication-quality images must be obtained from SCALA Group, the Museum's agent for licensing and distribution of images to outside publishers and researchers.

If you wish to quote any of this material in a publication, an application for permission to publish must be submitted to the MoMA Archives. This stipulation also applies to dissertations and theses. All references to materials should cite the archival collection and folder, and acknowledge "The Museum of Modern Art Archives, New York."

Whether publishing an image or quoting text, you are responsible for obtaining any consents or permissions which may be necessary in connection with any use of the archival materials, including, without limitation, any necessary authorizations from the copyright holder thereof or from any individual depicted therein.

In requesting and accepting this reproduction, you are agreeing to indemnify and hold harmless The Museum of Modern Art, its agents and employees against all claims, demands, costs and expenses incurred by copyright infringement or any other legal or regulatory cause of action arising from the use of this material.

NOTICE: WARNING CONCERNING COPYRIGHT RESTRICTIONS

The copyright law of the United States (Title 17, United States Code) governs the making of photocopies or other reproductions of copyrighted material. Under certain conditions specified in the law, libraries and archives are authorized to furnish a photocopy or other reproduction. One of these specified conditions is that the photocopy or reproduction is not to be "used for any purpose other than private study, scholarship, or research." If a user makes a request for, or later uses, a photocopy or reproduction for purposes in excess of "fair use," that user may be liable for copyright infringement.

The Museum of Modern Art Archives, NY	Collection:	Series.Folder:
	MoMA Exhs.	670.30

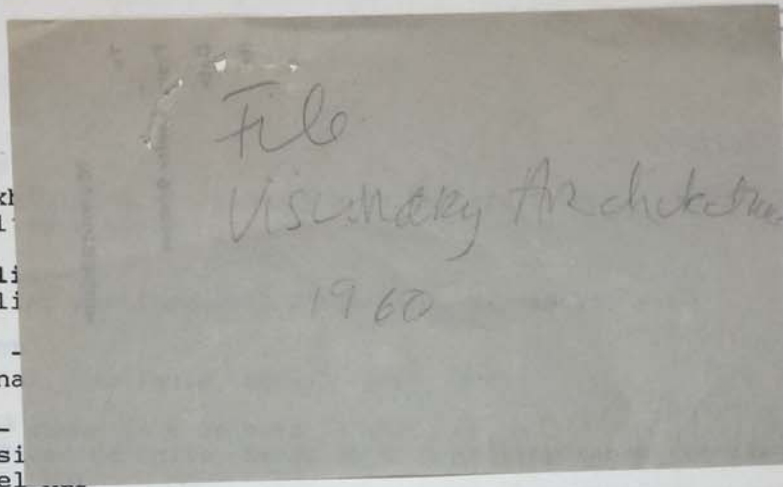

File
A. 11960

William
, 1960

MoMA Exh
Partial

Australia
Australia

Brazil -
VI Biena

Chile -
Universi

Vina del
Universidad de Concepcion, Dec. 1968 - mid-January 1969
Regional Center of Temuco
Osorno
University Center in Antofagasta

Ecuador -

Facultad de Arquitectura y Urbanismo, Universidad Central, Centro
de Artes, Mar. 30 - April 6, 1967

Universidad de Guayaquil, "Año Jubilar desu Primer Centenario,
1867-1967," May 2-10, 1967

Germany - (first stop on European tour)
Staatliche Kunsthalle, Baden-Baden, 1961 (part of a larger
exhibition entitled, "Phantastische Architektur")
Peru - shown in Lima, 1969

The Netherlands -
Kroller-Muller Museum
Gemeentemuseum

Norway -
Oslo Arkitektforening, 1963

Sweden -
Gotenberg, Mar. 1963
Stockholm, April 1963

U.S.A. -
Harvard University
Contemporary Arts Association, Houston
Chicago

Yugoslavia -
Muzej za umjetnost i obrt, Aug. 15- Sept. 8, 1963, Zagreb

* *Italics indicate that the possibility of an exhibition was
discussed in correspondence; whether or not exhibition ever
materialized is uncertain but probable.*

Compiled 6/92 PH

The Museum of Modern Art Archives, NY	Collection:	Series.Folder:
	MoMA Exhs.	670.30

*File
V.A. 11960*

KATAVALOS, William

MOMA Exhibition, "Visionary Architecture," Sept. 29-Dec. 4, 1960
Partial Tour List

Australia -

Australian Architectural Convention, May 19-25, 1962

Brazil -

VI Bienal, Sao Paolo, Brazil, Sept. 1961

Chile - shown in 6 University Centers:

Universidad de Chile, Museo de Arte Contemporaneo, Santiago

Vina del Mar

Universidad de Concepcion, Dec. 1968 - mid-January 1969

Regional Center of Temuco

Osorno

University Center in Antofagasta

Ecuador -

Facultad de Arquitectura y Urbanismo, Universidad Central, Centro de Artes, Mar. 30 - April 6, 1967

Universidad de Guayaquil, "Ano Jubilar desu Primer Centenario, 1867-1967," May 2-10, 1967

Germany - (first stop on European tour)

Staatliche Kunsthalle, Baden-Baden, 1961 (part of a larger exhibition entitled, "Phantastische Architektur")

Peru - shown in Lima, 1969

The Netherlands -

Kroller-Muller Museum

Gemeentemuseum

Norway -

Oslo Arkitektforening, 1963

Sweden -

Gotenberg, Mar. 1963

Stockholm, April 1963

U.S.A. -

Harvard University

Contemporary Arts Association, Houston

Chicago

Yugoslavia -

Muzej za umjetnost i obrt, Aug. 15- Sept. 8, 1963, Zagreb

* *Italics indicate that the possibility of an exhibition was discussed in correspondence; whether or not exhibition ever materialized is uncertain but probable.*

Compiled 6/92 PH

FOR STUDY PURPOSES ONLY. NOT FOR REPRODUCTION.

The Museum of Modern Art Archives, NY	Collection:	Series/Folder:
	MoMA Exhs.	670.30

Copy for the Panels

Checklist (1st) MOMA-1962-1-22

February 15, 1962

Categories: 74 Photo panels
 49 Text panels
 123 TOTAL

URGENT

Dear George: Height preceding width. All panels are either 36 x 36 inches (91.4 x 91.4 cm) or 36 x 12 inches (91.4 x 30.5 cm). Except for the introductory panels, all photo panels are large and

Here, at long last, are the photos of the Visionary panels for which we'll need negatives sent over to Compo.

The exhibition has to be ready for shipment to Australia by March 7th, not much time as you can see.

Will you please pull out negs. for each panel and send both photo and negs. to Mr. Dolan. You can send them out piecemeal, if you like.

I will help you in whatever way I can, but you know the whereabouts of the negs. and I don't.

Call me if you have any questions.

Many thanks,

Allen

Panel No.	Architect	Subject	Dist. No.
A-1		Introductory text panel	1
A-2		Introductory photo panel	4
A-3		Introductory photo panel	4
A-4			1
A-5	DA VINCI, Leonardo	IDEAL CITY Text panel	1
A-6	DA VINCI, Leonardo	IDEAL CITY Photo panel	1
A-7	DA VINCI, Leonardo	IDEAL CITY Photo panel	1
A-8	FILARETA	SKYSCRAPER Text Panel	4

P.S. These prints represent the only record of the show. Mr. Dolan does not have a duplicate set.

Checklist provided to serve as a guide.

The Museum of Modern Art Archives, NY	Collection:	Series.Folder:
	MoMA Exhs.	670.30

Copy for Geo. Barron

Check List

September 5, 1961

Exhibition: VISIONARY ARCHITECTURE
An exhibition prepared by The Museum of Modern Art, New York

Contents: 74 Photo panels
49 Text panels
123 TOTAL

Dimensions: Height preceding width, all panels are either 36 x 36 inches (91.4 x 91.4 cm.) or 36 x 12 inches (91.4 x 30.5 cm.). Except for the Introductory panels, all photo panels are large and all text panels small.

Installation: All panels are numbered in sequence in the following categories:

- A 1-19 Introduction and History
- B 1-24 Mountain Cities
- C 1-13 Bruno Taut
- D 1-26 Geometric and Organic Cities
- E 1-8 Frank Lloyd Wright
- F 1-22 Road Cities
- G 1-11 Frederick Kiesler

Separation for installation should be made between categories.

Note: Nine photographs are composed of two panels each. They are joined as indicated; top and bottom or left and right.

<u>Panel No.:</u>	<u>Architect:</u>	<u>Subject</u>	<u>Box No.:</u>
A-1		Introductory text panel	1
A-2		Introductory photo panel	4
A-3		Introductory photo panel	4
A-4		Introductory text panel	1
A-5	DaVINCI, Leonardo	IDEAL CITY Photo Panel	1
A-6	DaVINCI, Leonardo	IDEAL CITY Text panel	4
A-7	DaVINCI, Leonardo	IDEAL CITY Photo panel	1
A-8	FILARETE	SKYSCRAPER Text Panel	4

The Museum of Modern Art Archives, NY	Collection:	Series.Folder:
	MoMA Exhs.	670.30

VISIONARY ARCHITECTURE		Check List	Page 2.
A-9	FILARETE	SKYSCRAPER Photo panel	1
A-10	SANT' ELIA, Antonio	RAILROAD TERMINAL AND HYDRO ELECTRIC STATION Photo panel	1
A-11	SANT' ELIA, Antonio	DESIGNS FOR THE CITY OF THE FUTURE Text panel	4
A-12	SANT' ELIA, Antonio	DESIGNS FOR THE CITY OF THE FUTURE Photo panel	1
A-13	PIRANESI, Giovanni	ACADEMY AND CIVIC CENTER Text panel	4
A-14	PIRANESI, Giovanni	ACADEMY AND CIVIC CENTER Photo panel	1
A-15	BOULLEE, Etienne-Louis	CENOTAPH FOR ISAAC NEWTON Text panel	4
A-16	BOULLEE, Etienne-Louis	CENOTAPH FOR ISAAC NEWTON Photo panel	1
A-17	FERRISS, Hugh	THE METROPOLIS OF TOMORROW Photo panel	1
A-18	FERRISS, Hugh	THE METROPOLIS OF TOMORROW Text panel	4
A-19	FERRISS, Hugh	THE METROPOLIS OF TOMORROW Photo panel	1
B-1	unknown	MOUNTAIN CITY Text panel	4
B-2	unknown	MOUNTAIN CITY Photo panel	1
B-3	ENTWISTLE, Clive	CIVIC CENTER and CRYSTAL PALACE Text panel	4
B-4	ENTWISTLE, Clive	CIVIC CENTER and CRYSTAL PALACE Photo panel	1

The Museum of Modern Art Archives, NY	Collection:	Series.Folder:
	MoMA Exhs.	670.30

<u>VISIONARY ARCHITECTURE</u>		<u>Check List</u>	<u>Page 3.</u>
B-5	ENTWISTLE, Clive	METROPOLITAN CATHEDRAL OF CHRIST THE KING Text panel	4
B-6	ENTWISTLE, Clive	METROPOLITAN CATHEDRAL OF CHRIST THE KING Photo panel	1
B-7	POELZIG, Hans	FESTIVAL HALL, Salzburg Photo panel	1
B-8	POELZIG, Hans	FESTIVAL HALL, Salzburg Text panel	4
B-9 left B-10 right	POELZIG, Hans	FESTIVAL HALL, Salzburg Double photo panel	1-1
B-11	POELZIG, Hans	FESTIVAL HALL, Salzburg Photo panel	1
B-12	POELZIG, Hans	FRIENDSHIP HOUSE, Istanbul Photo panel	1
B-13	POELZIG, Hans	FRIENDSHIP HOUSE, Istanbul Text panel	4
B-14	POELZIG, Hans	FRIENDSHIP HOUSE, Istanbul Photo panel	1
B-15	MAZET, Jean-Claude	IDEAL CITY Text panel	4
B-16 left B-17 right	MAZET, Jean-Claude	IDEAL CITY Double photo panel	1-1
B-18	SOLERI, Paolo	MESA BIOTECHNIC CITY Text panel	4
B-19 left B-20 right	SOLERI, Paolo	MESA BIOTECHNIC CITY Double photo panel	1-1
B-21	KORDA, Vincent	STAGE SET--THINGS TO COME Photo panel	1
B-22	KORDA, Vincent	STAGE SET--THINGS TO COME Text panel	4
B-23 top B-24 bottom	KORDA, Vincent	STAGE SET--THINGS TO COME Double photo panel	2-2

The Museum of Modern Art Archives, NY	Collection:	Series.Folder:
	MoMA Exhs.	670.30

<u>VISIONARY ARCHITECTURE</u>		<u>Check List</u>	<u>Page 4.</u>
C-1	TAUT, Bruno	ALPINE ARCHITECTURE Text panel	4
C-2	TAUT, Bruno	THE VALLEY AS A BLOSSOM Text panel	4
C-3	TAUT, Bruno	THE VALLEY AS A BLOSSOM Photo panel	2
C-4	TAUT, Bruno	THE CRYSTAL HOUSE IN THE MOUNTAINS Text panel	4
C-5	TAUT, Bruno	THE CRYSTAL HOUSE IN THE MOUNTAINS Photo panel	2
C-6	TAUT, Bruno	THE CRYSTAL HOUSE IN THE MOUNTAINS Text panel	4
C-7	TAUT, Bruno	ROCKY SITES IN TYROL Text panel	4
C-8	TAUT, Bruno	ROCKY SITES IN TYROL and THE NORTH ITALIAN LAKES Photo panel	2
C-9	TAUT, Bruno	THE NORTH ITALIAN LAKES Text panel	4
C-10	TAUT, Bruno	THE VALLEY WITH WATERFALLS Text panel	4
C-11	TAUT, Bruno	THE VALLEY WITH WATERFALLS Photo panel	2
C-12	TAUT, Bruno	THE CRYSTAL MOUNTAIN Text panel	4
C-13	TAUT, Bruno	THE CRYSTAL MOUNTAIN Photo panel	2
D-1	DOESBURG, Theo VAN	GROUP OF SKYSCRAPERS Text panel	4
D-2	DOESBURG, Theo VAN	GROUP OF SKYSCRAPERS Photo panel	2

The Museum of Modern Art Archives, NY	Collection:	Series.Folder:
	MoMA Exhs.	670.30

VISIONARY ARCHITECTURE		Check List	Page 5.
D-3	FINSTERLIN, Hermann	IDEAL BUILDING Text panel	4
D-4	FINSTERLIN, Hermann	IDEAL BUILDING Photo panel	2
D-5	LISSITZKY, El	DER WOLKENBUGEL Text panel	4
D-6	LISSITZKY, El	DER WOLKENBUGEL Photo panel	2
D-7	KAHN, Louis	CITY TOWER Photo panel	2
D-8	KAHN, Louis	CITY TOWER Text panel	4
D-9	KAHN, Louis	CITY TOWER Photo panel	2
D-10	KAHN, Louis	CENTER CITY Photo panel	2
D-11	KAHN, Louis	CENTER CITY Text panel	4
D-12	KAHN, Louis	CENTER CITY Photo panel	2
D-13	FULLER, Buckminster	PARTIAL ENCLOSURE OF MANHATTAN ISLAND Text panel	4
D-14	FULLER, Buckminster	PARTIAL ENCLOSURE OF MANHATTAN ISLAND photo panel	2
D-15	WEBB, Michael	OFFICE BUILDING Text panel	4
D-16 left D-17 right	WEBB, Michael	OFFICE BUILDING and SIDE ELEVATION Double photo panel	2-2
D-18	SOLERI, Paolo	THEOLOGICAL CENTER OF BIOTECHNIC CITY Photo panel	2

The Museum of Modern Art Archives, NY	Collection:	Series.Folder:
	MoMA Exhs.	670.30

VISIONARY ARCHITECTURE		Check List	Page 6.
D-19	SOLERI, Paolo	THEOLOGICAL CENTER OF BIOTECHNIC CITY Text panel	4
D-20	SOLERI, Paolo	THEOLOGICAL CENTER OF BIOTECHNIC CITY Photo Panel	2
D-21	SOLERI, Paolo	THEOLOGICAL CENTER OF BIOTECHNIC CITY Photo panel	2
D-22	KIKUTAKE, Kiyonori	MARINE CITY Photo panel	2
D-23	KIKUTAKE, Kiyonori	MARINE CITY Text panel	4
D-24	KIKUTAKE, Kiyonori	MARINE CITY Photo panel	2
D-25	KATAVOLOS, William	CHEMICAL ARCHITECTURE Text panel	4
D-26	KATAVOLOS, William	CHEMICAL ARCHITECTURE Photo panel	2
E-1	WRIGHT, Frank Lloyd	A CIVIC CENTER FOR PITTSBURGH Photo panel	2
E-2	WRIGHT, Frank Lloyd	A CIVIC CENTER FOR PITTSBURGH Text panel	4
E-3 left E-4 right	WRIGHT, Frank Lloyd	A CIVIC CENTER FOR PITTSBURGH Double photo panel	2-3
E-5 top E-6 bottom	WRIGHT, Frank Lloyd	MILE HIGH SKYSCRAPER Double photo panel	3-3
E-7	WRIGHT, Frank Lloyd	MILE HIGH SKYSCRAPER Text panel	4
E-8	WRIGHT, Frank Lloyd	MILE HIGH SKYSCRAPER Photo panel	3
F-1	LE CORBUSIER	COMBINED ROAD AND BUILDING FOR RIO DE JANEIRO Photo panel	3

The Museum of Modern Art Archives, NY	Collection:	Series.Folder:
	MoMA Exhs.	670.30

VISIONARY ARCHITECTURE		Check List	Page 7.
F-2	LE CORBUSIER	COMBINED ROAD AND BUILDING FOR RIO DE JANEIRO Text panel	4
F-3 left F-4 right	LE CORBUSIER	COMBINED ROAD AND BUILDING FOR RIO DE JANEIRO Double photo panel	3-3
F-5	LE CORBUSIER	COMBINED BUILDING AND ROAD FOR ALGIERS Text panel	4
F-6	LE CORBUSIER	COMBINED BUILDING AND ROAD FOR ALGIERS Photo panel	3
F-7	MALCOMSON, Reginald	METRO LINEAR CITY Photo panel	3
F-8 F-9	MALCOMSON, Reginald	METRO LINEAR CITY Text panels	4-4
F-10	MALCOMSON, Reginald	METRO LINEAR CITY Photo panel	3
F-11	MALCOMSON, Reginald	METRO LINEAR CITY Photo panel	3
F-12	KUROKAWA, Noriaki	AGRICULTURAL CITY Text panel	4
F-13	KUROKAWA, Noriaki	AGRICULTURAL CITY Photo panel	3
F-14	SOLERI, Paolo	LONG SPAN CONCRETE BRIDGE Text panel	4
F-15	SOLERI, Paolo	LONG SPAN CONCRETE BRIDGE Photo panel	3
F-16	NELSON, Paul	SUSPENDED HOUSE Photo panel	3
F-17	NELSON, Paul	SUSPENDED HOUSE Text panel	4
F-18	NELSON, Paul	SUSPENDED HOUSE Photo panel	3

The Museum of Modern Art Archives, NY	Collection:	Series.Folder:
	MoMA Exhs.	670.30

<u>VISIONARY ARCHITECTURE</u>		<u>Check List</u>	<u>Page 8.</u>
F-19	FIT ZGIBBON & SIDES	BRIDGE CITY Photo panel	3
F-20	FIT ZGIBBON & SIDES	BRIDGE CITY Text panel	4
F-21	FIT ZGIBBON & SIDES	BRIDGE CITY Photo panel	3
F-22	FIT ZGIBBON & SIDES	BRIDGE CITY Photo panel	3
G-1	KIESLER, Frederick	ENDLESS THEATRE Text panel	4
G-2	KIESLER, Frederick	ENDLESS THEATRE Photo panel	3
G-3	KIESLER, Frederick	CITY IN SPACE Text panel	4
G-4	KIESLER, Frederick	CITY IN SPACE Photo panel	3
G-5	KIESLER, Frederick	ENDLESS HOUSE Photo panel	3
G-6	KIESLER, Frederick	ENDLESS HOUSE Text panel	4
G-7	KIESLER, Frederick	ENDLESS HOUSE Photo panel	3
G-8	KIESLER, Frederick	ENDLESS HOUSE Photo panel	3
G-9 G-10	KIESLER, Frederick	ENDLESS HOUSE Text panels	4-4
G-11	KIESLER, Frederick	ENDLESS HOUSE Photo panel	3

The Museum of Modern Art Archives, NY	Collection:	Series.Folder:
	MoMA Exhs.	670.30

cc: File
Architecture Dept.

December 22, 1975

Ms. Jane C. Henning
Architecture Librarian
Soleri Archivist
Arizona State University
Tempe, Arizona 85281

Dear Ms. Henning:

0
5.50 your letter concerning the Museum's exhibition VISIONARY
9.60 I am enclosing the itinerary for the two versions.
33.40
72.75 Museum exhibition traveled to a limited number of places
6.30 see. A smaller panel version was prepared for our
5.50 Exhibition program and toured the United States and Canada
59.00 years. This itinerary is also enclosed.
11.50
9.60 information completes your search for details on this
81.00 There was no catalogue for the exhibition.
18.90
6.00
33.65
4.50
6.30
1.50
3.30
15.90
24.85
15.90

953.65 T

Assistant
Program

FOR STUDY PURPOSES ONLY. NOT FOR REPRODUCTION.

The Museum of Modern Art Archives, NY	Collection:	Series.Folder:
	MoMA Exhs.	670.30

cc: File
Architecture Dept.

December 2, 1975

Ms. Jane C. Henning
Architecture Librarian
Soleri Archivist
Arizona State University
Tempe, Arizona 85281

Dear Ms. Henning:

In reply to your letter concerning the Museum's exhibition VISIONARY ARCHITECTURE I am enclosing the itinerary for the two versions.

The original Museum exhibition traveled to a limited number of places as you will see. A smaller panel version was prepared for our Circulating Exhibition program and toured the United States and Canada for several years. This itinerary is also enclosed.

I hope this information completes your search for details on this exhibition. There was no catalogue for the exhibition.

Sincerely,

Marie Frost
Administrative Assistant
Exhibition Program

Enclosures

FOR STUDY PURPOSES ONLY. NOT FOR REPRODUCTION.

The Museum of Modern Art Archives, NY	Collection:	Series.Folder:
	MoMA Exhs.	670.30

ARIZONA STATE
UNIVERSITY

UNIVERSITY LIBRARY

TEMPE, ARIZONA 85281

Director of Public Information
Museum of Modern Art
11 West 53rd Street
New York, New York 10019

Dear Sir:

In 1960 the Museum of Modern Art held an exhibition titled
Visionary Architecture.

According to information for various sources this later became
a traveling exhibition. Would it be possible to obtain a list of
places where this show appeared and the dates of appearance?

Sincerely,

Jane C. Henning

Jane C. Henning (Ms.)
Architecture Librarian/Soleri Archivist
Arizona State University

FOR STUDY PURPOSES ONLY. NOT FOR REPRODUCTION.

The Museum of Modern Art Archives, NY	Collection:	Series.Folder:
	MoMA Exhs.	670.30

THE MUSEUM OF MODERN ART

Date October 19, 1965

To: A&D file, VISIONARY ARCHITECTURE

Re: VISIONARY ARCHITECTURE,
circulating version

From: Ellen Marsh

ALL photo negatives for this show are in box labelled
VISIONARY ARCHITECTURE in my office. Many of the nega-
tives are from George Barrows' file.

All ENGLISH language text negatives are in above-mentioned
box.

GUIDE PRINTS (no layout drawings exist) are in the back
of my upper righthand file drawer.

FOR STUDY PURPOSES ONLY. NOT FOR REPRODUCTION.

The Museum of Modern Art Archives, NY	Collection:	Series.Folder:
	MoMA Exhs.	670.30

Check List January 17, 1960

Exhibition: Visionary Architecture

Contents: 95 Panels

60 Photo Panels
24 Text Panels
11 Text and Photo Panels

Dimensions:

All dimensions are in inches with height preceding width.

Cat. No.:	Architect:	Subject and date:	Size:	Pkg. No
A-1	PORETTO, Hans	Introductory text	36 x 48"	
A-2		Introductory text	36 x 48"	
A-3	DAVINCI, Leonardo	IDEAL CITY Photo panel	36 x 48"	
A-4	DAVINCI, Leonardo	IDEAL CITY Text panel	36 x 32"	
A-5	DAVINCI, Leonardo	IDEAL CITY Photo panel	36 x 27"	
A-6	FILARETE	SKYSCRAPER Photo panel	36 x 32"	
A-7	FILARETE	SKYSCRAPER Text panel	36 x 27"	
A-8	SANT' ELIA, ANTONIO	DESIGNS FOR THE CITY OF THE FUTURE. Photo panel	36 x 35"	
A-9	SANT' ELIA, Antonio	Design For the City of the Future Text panel	36 x 36"	
A-10	PIRANESI, Giovanni Batista	ACADEMY AND CIVIC CENTER Photo panel	36 x 27 1/2"	
A-11	PIRANESI	Text panel (also has photo of PALATIAL INTERIOR)	36 x 24"	
A-12	BOULLEE, Etienne-Louis	CENOTAPH FOR ISAAC NEWTON Photo panel	36 x 60"	
A-13	BOULLEE	Text panel (also photo of GROUP OF CENOTAPHS)	36 x 30"	
A-14	FERRISS, Hugh	THE METROPOLIS OF TOMORROW View looking down from terrace. Photo panel	36 x 29 1/2"	

The Museum of Modern Art Archives, NY	Collection:	Series.Folder:
	MoMA Exhs.	670.30

MONARY ARCHITECTURE		Check List	page 2.
1-15	FERRISS, Hugh	Text panel (Also has photo of THE ART CENTER)	36 x 30"
16 B-7	Unknown	MOUNTAIN CITY Text and photo panel	51 x 36"
17 B-2	ENTWISTLE, Clive	CIVIC CENTER and CRYSTAL PALACE. Photo panel	72 x 95"
18 B-3	ENTWISTLE, Clive	METROPOLITAN CATHEDRAL OF CHRIST THE KING. Photo panel	72 x 50"
19 B-4	POELZIG, Hans	FESTIVAL HALL, Salzburg Text panel	72 x 54"
20 B-5	POELZIG, Hans	FESTIVAL HALL, Salzburg Photo panel	72 x 132"
21 B-6	POELZIG, Hans	FRIENDSHIP HOUSE, Istanbul Text panel	72 x 54"
22 B-7	POELZIG, Hans	FRIENDSHIP HOUSE, Istanbul Photo panel	72 x 108"
23 B-8	MAZET, Jean-Claude	IDEAL CITY Text and small photos panel	72 x 19 1/2" 72 x 54"
B-8A	" " "	Photo panel	72 x 54"
24 B-9	MAZET, Jean-Claude	IDEAL CITY Photo panel	72 x 96"
25 B-10	SOLERI, Paolo	MESA BIOTECHNIC CITY Text panel	30 x 40 1/2"
B-10			
26 B-11	SOLERI, Paolo	MESA BIOTECHNIC CITY (Plan) Photo panel	30 x 54 1/2"
B-11			
27 B-12	SOLERI, Paolo	MESA BIOTECHNIC CITY (Cross section drawing - Entrance & Temples) Photo panel	30 x 102"
28 B-13	SOLERI, Paolo	MESA BIOTECHNIC CITY (Cross section drawing - Shrine & Museum) Photo panel	30 x 96"
B-13			
29 B-14	KORDA, Vincent	STAGE SET--THINGS TO COME Text panel	72 x 36"
30 B-15	KORDA, Vincent	STAGE SET--THINGS TO COME Photo panel	40 x 54"
31 B-16	KORDA, Vincent	STAGE SET--THINGS TO COME Photo panel	72 x 60" 78

The Museum of Modern Art Archives, NY	Collection:	Series.Folder:
	MoMA Exhs.	670.30

VISIONARY ARCHITECTURE

Check List

page 3.

32 C-1	DOESBURG, Theo VAN	GROUP OF SKYSCRAPERS Photo & text panel	72 x 48"
33 C-2	FINSTERLIN, Hermann	IDEAL BUILDING Photo & Text panel	72 x 48"
34 C-3	KIKUTAKE, Kiyonori	MARINE CITY Text panel	72 x 30"
35 C-4	KIKUTAKE, Kiyonori	MARINE CITY Photo panel	72 x 67"
36 C-5	LISSITZKY, El	DER WOLKENBÜGEL Photo panel	72 x 58"
37 C-6	WEBB, Michael	OFFICE BUILDING (Side Elevation) Photo panel	72 x 111"
38 C-7	WEBB, Michael	OFFICE BUILDING Text panel	72 x 24"
39 C-8	WEBB, Michael	OFFICE BUILDING (End Elevation) Photo panel	72 x 46"
40 C-9	KATAVOLOS, William	CHEMICAL ARCHITECTURE Text panel	72 x 30"
41 C-10	KATAVOLOS, William	CHEMICAL ARCHITECTURE Photo panel	72 x 78"
42 C-11	SOLERI, Paolo	THEOLOGICAL CENTER OF BIO- TECHNIC CITY. Text panel	72 x 24"
43 C-12	SOLERI, Paolo	THEOLOGICAL CENTER OF BIO- TECHNIC CITY. Photo panel	72 x 45 1/2"
44 C-13	SOLERI, Paolo	THEOLOGICAL CENTER OF BIO- TECHNIC CITY. Photo panel	72 x 60"
45 C-14	FULLER, Buckminster	PARTIAL ENCLOSURE OF MAN- HATTAN ISLAND. Text panel	24 x 13"
46 C-15	FULLER, Buckminster	PARTIAL ENCLOSURE OF MAN- HATTAN ISLAND. Photo panel	72 x 43"
47 C-16	KAHN, Louis	CENTER CITY Photo panel	72 x 114"
48 C-17	KAHN, Louis	CENTER CITY Text panel	72 x 36"
49 C-18-18	KAHN, Louis	CITY TOWER Text panel	72 x 24"

The Museum of Modern Art Archives, NY	Collection:	Series.Folder:
	MoMA Exhs.	670.30

TERMINARY ARCHITECTURE

Check List

page 4.

50 C-19	KAHN, Louis	CITY TOWER Photo panel	72 x 52" 105
51 D-1 D1	TAUT, Bruno	ALPINE ARCHITECTURE Text panel	30 x 29"
52 D-2 D2	TAUT, Bruno	ALPINE ARCHITECTURE Photo panel	30 1/2 x 24 1/2"
53 D-3	TAUT, Bruno	To be added (drawing) Photo panel	30 x 24" 30 x 38"
54 D-4	TAUT, Bruno	ALPINE ARCHITECTURE Photo panel	30 x 25 1/2"
55 D-5	TAUT, Bruno	ALPINE ARCHITECTURE Photo panel	30 x 27"
56 D-6	TAUT, Bruno	ALPINE ARCHITECTURE Photo panel	30 x 25"
57 D-7	TAUT, Bruno	ALPINE ARCHITECTURE Photo panel	30 x 25"
58 D-8	TAUT, Bruno	ALPINE ARCHITECTURE Photo panel (Having two narrow-photos)	30 x 37 1/2"
59 E-1	WRIGHT, Frank Lloyd	MILE HIGH SKYSCRAPER Text panel (view toward din. rm.)	72 x 38"
60 E-2	WRIGHT, Frank Lloyd	MILE HIGH SKYSCRAPER Photo panel	72 x 8 3/4"
61 E-3	WRIGHT, Frank Lloyd	MILE HIGH SKYSCRAPER Photo panel	72 x 6 7/8"
62 E-4	WRIGHT, Frank Lloyd	MILE HIGH SKYSCRAPER Photo panel (narrow-photos)	72 x 7 1/4"
63 E-5 E-5	WRIGHT, Frank Lloyd	MILE HIGH SKYSCRAPER Photo panel (narrow-photos)	59 x 36"
64 E-6	WRIGHT, Frank Lloyd	A CIVIC CENTER FOR PITTSBURGH. Text panel	28 3/4 x 27"
65 E-7	WRIGHT, Frank Lloyd	A CIVIC CENTER FOR PITTSBURGH. Photo panel(sec.)	63 x 268"
66 E-8 E-8	WRIGHT, Frank Lloyd	A CIVIC CENTER FOR PITTSBURGH. Photo panel(aerial)	63 x 140"
E-9	WRIGHT, F. L.	CIVIC CENTER photo panel aerial perspective	40 x 45"

The Museum of Modern Art Archives, NY	Collection:	Series.Folder:
	MoMA Exhs.	670.30

VISIONARY ARCHITECTURE

Check List

page 5.

67 51	KIESLER, Frederick	ENDLESS HOUSE AND ROAD Photo panel. Photo & text panel	72 x 36" 105
68 52	KIESLER, Frederick	CITY IN SPACE Photo and text panel	72 x 48"
69 53	KIESLER, Frederick	ENDLESS HOUSE WITH BRIDGE Text panel-Arthur Presler	24 x 28"
70 54	KIESLER, Frederick	ENDLESS HOUSE WITH BRIDGE (Section drawing) Photo panel	24 x 34"
71 55	KIESLER, Frederick	ENDLESS HOUSE (Front elevations 2nd scheme (1)) Photo panel	24 x 34"
72 56	KIESLER, Frederick	ENDLESS HOUSE (West Elevations) Photo panel	24 x 34"
73 57	KIESLER, Frederick	ENDLESS HOUSE Photo panel	72 x 108"
74 58	KIESLER, Frederick	ENDLESS HOUSE (Living Rm-Barrows-photo) Photo panel	40 x 50"
75 59	KIESLER, Frederick	ENDLESS HOUSE (view toward din. rm.) Photo panel	40 x 41"
76 60	KIESLER, Frederick	ENDLESS HOUSE (Barrows-photo) Photo panel	24 x 30"
77 61	KIESLER, Frederick	ENDLESS HOUSE (View fr bedrm.-Barrows-) Photo panel	18 x 26 1/2"
78 62	KIESLER, Frederick	ENDLESS HOUSE (Barrows-photo) Photo panel	40 x 61"
79 63	KUROKAWA, Noriaki	AGRICULTURAL CITY Photo & Text panel	72 x 53"
80 64	LE CORBUSIER	COMBINED ROAD AND BUILDING FOR RIO DE JANEIRO. Text panel	72 x 40"
81 65	LE CORBUSIER	COMBINED ROAD AND BUILDING FOR RIO DE JANEIRO. Photo panel	72 x 46"

The Museum of Modern Art Archives, NY	Collection:	Series.Folder:
	MoMA Exhs.	670.30

CONARY ARCHITECTURE

Check List

Page 6.

82 G-4	LE CORBUSIER	COMBINED BUILDING AND ROAD FOR ALGIERS. Photo & text panel	72 x 89"
83 G-5	NELSON, Paul	SUSPENDED HOUSE Text panel	72 x 128"
84 G-6	SOLEPI, Paolo	LONG SPAN CONCRETE BRIDGE Photo & text panel	35 x 92"
85 G-7	SOLEPI, Paolo	LONG SPAN CONCRETE BRIDGE Photo panel	35 x 92"
86 G-8 G-8	FITZGIBBON & SIDES	BRIDGE CITY Text panel	34 1/2 x 17 1/2"
87 G-9	FITZGIBBON & SIDES	BRIDGE CITY (Plan & Elevation) Photo panel	34 1/2 x 27"
88 G-10	FITZGIBBON & SIDES	BRIDGE CITY Photo panel	72 x 72"
89 G-11	FITZGIBBON & SIDES	BRIDGE CITY (group of Apt. Bldgs) Photo panel	30 x 37 1/2"
90 G-12	FITZGIBBON & SIDES	BRIDGE CITY (General view) Photo panel	72 x 72"
91 G-13 G-13	MALCOMSON, Reginald	METRO LINEAR CITY Text panel	30 x 30"
92 G-14 G-14	MALCOMSON, Reginald	METRO LINEAR CITY (Plans) Photo panel	40 x 33"
93 G-15 out	MALCOMSON, Reginald	METRO LINEAR CITY (Plan) Photo panel	40 x 50"
94 G-16	MALCOMSON, Reginald	METRO LINEAR CITY (Cross section) Photo panel	40 x 24"
95 G-17 G-17	MALCOMSON, Reginald	METRO LINEAR CITY (Drawing of buildings) Photo panel	72 x 128" 24 x 26

B-16

D-3

The Museum of Modern Art Archives, NY	Collection:	Series.Folder:
	MoMA Exhs.	670.30

PRINTS TO MAKE

F 1 Kessler "Endless House" - large ~~neg~~ interior
72 x ~~103~~¹⁰⁷ - Compo has neg.

F12 Kessler - "City in Space" 72 x 59"
Compo has neg - dimensions to follow.

F13A - Kessler text panel. 72 x 14

F 14 Kessler text panel. 72 x 36
A. $15\frac{3}{4}$ x 3'-0" Compo has neg.
B. 21 x 3'-0" Compo has neg (needs rework.)
C. x 3'-0" text to follow.

F 15 Kessler. 72 x 36
A. Theater project. ³²
16" x 3'-0" Compo has neg.

B. Place de la Concord
16" x 3'-0" Compo has neg.

C. text x 3'-0" to come.

B-16. Korda. "Things to come"
72 x ~~53~~⁵³ Compo has neg.

D-3. Taut. "Alpine architecture."
30 x ~~38~~³⁸ Compo has neg.

FOR STUDY PURPOSES ONLY. NOT FOR REPRODUCTION.

The Museum of Modern Art Archives, NY	Collection:	Series.Folder:
	MoMA Exhs.	670.30

Mr. Jay Doblin

January 13, 1961

the fabrication of the replacements. It is our plan to forward the
exhibition to you from New York on January 13, 1961. It may be in your hands by the 15th.

January 13, 1961

Sincerely,

Mr. Jay Doblin
Institute of Design of
Illinois Institute of Technology
Technology Center
Chicago 16, Illinois

Arthur A. Mooney

Dear Mr. Doblin:

According to our telephone conversation of this afternoon,
I am enclosing the list of panel dimensions and their sequence of
hanging for the exhibition Visionary Architecture. These and the
enclosed 17 photographs of the New York installation should allow
your designer to proceed at once with his installation.

The following variations have been made upon the New York
show. Two text panels replace the original 5 panels used in the
introduction; two panels replace Kiesler's 4 unique drawings; eight
panels replace murals and models in the original version.

With the replacements having been determined, the production
costs of these, the motor transportation of the entire exhibition
from New York to Chicago and return and other costs we shall be able
to provide the show to you at a flat fee of \$3,000.00. The initial
costs of the photographs alone came to \$7,200.00. The fee makes no
provision for models since Arthur Drexler has indicated his un-
willingness for these to be included. The Mies model now in New York
continues on view into the period of your opening and Arthur does not
feel its character falls within the concept of his show.

Our publicity department has today furnished Miss Kogan with
a series of background releases on the show and a selection of photo-
graphs of the subjects included.

I am counting upon receiving your confirmation of acceptance
of the show by Monday if possible in order that we may proceed with

The Museum of Modern Art Archives, NY	Collection:	Series.Folder:
	MoMA Exhs.	670.30

Check list January 13, 1961

Exhibition: VISIONARY ARCHITECTURE
 Mr. Jay Doblin -2- January 13, 1961

Contents: 25 Panels Dimensions:

the fabrication of the replacements. It is our plan to forward the exhibition to you from New York on February first in order that it may be in your hands by the third.

Abbreviations:
 P = Photo

Sincerely,

Cat. No.	Architect	Dimensions: height precedes width	Type of panel
		Porter A. McCray	
A-1	Intro. Text	36 x 48 in.	T
A-2	Intro. Text	36 x 48 in.	T
A-3	Portrait	36 x 48 in.	P
A-4	Enclosures: incl	36 x 32 in.	T
A-5	list of panel dimensions	36 x 27 in.	P
A-6	17 photographs	36 x 32 in.	P
A-7	Pilarets	36 x 27 in.	T
A-8	Sant' Elia	36 x 36 in.	P
A-9	Sant' Elia	36 x 36 in.	T
A-10	Piranesi	24 x 27 1/2 in.	P
A-11	Piranesi	15 x 24 in.	T & P
A-12	Wulles	36 x 60 in.	P
A-13	Wulles	36 x 60 in.	T
A-14	Ferriss	36 x 29 in.	P
A-15	Ferriss	36 x 30 in.	T & P
		cc: Mr. Drexler Mr. McCray Miss Frost	
	Unknown Architect	51 x 36 in.	Visionary Architecture
B-1	Sciucista	72 x 96 in.	P
B-2	Interinsel	72 x 96 in.	P
B-3	Pedrig	72 x 54 in.	T
B-4	Pedrig	72 x 132 in.	P
B-5	Pedrig	72 x 54 in.	T
B-6	Pedrig	72 x 108 in.	P
B-7	Mass	72 x 54 in.	T & P
B-8	Mass	72 x 96 in.	P
B-9	Solari	30 x 40 1/2 in.	T
B-10	Solari	30 x 54 1/2 in.	P
B-11	Solari	30 x 144 in.	P & P
B-12	Solari	30 x 36 in.	P
B-13	Scrisa	72 x 36 in.	T
B-14	Ferris	60 x 54 in.	P
B-15	Landa	72 x 96 in.	P

The Museum of Modern Art Archives, NY	Collection:	Series.Folder:
	MoMA Exhs.	670.30

Check List

January 13, 1960

Exhibition: VISIONARY ARCHITECTURE

Contents:

95 PanelsDimensions:

60 Photo Panels

34 Text Panels

11 Text and Photo Panels

All dimensions are in inches
with height preceding width.Abbreviations:

T = Text

P = Photo

<u>Cat. No.</u>	<u>Architect</u>	<u>Dimensions: height precedes width</u>	<u>Type of panel</u>
A-1	Intro. Text	36 x 48 in.	T
A-2	Intro. Text	36 x 48 in.	T
A-3	DaVinci	36 x 48 in.	P
A-4	Da Vinci	36 x 32 in.	T
A-5	Da Vinci	36 x 27 in.	P
A-6	Filarete	36 x 32 in.	P
A-7	Filarete	36 x 27 in.	T
A-8	Sant' Elia	36 x 35 in.	P
A-9	Sant' Elia	36 x 36 in.	T
A-10	Piranesi	36 x 27 1/2 in.	P
A-11	Piranesi	36 x 24 in.	T & P
A-12	Boullée	36 x 60 in.	P
A-13	Boullée	36 x 30 in.	T
A-14	Ferriss	36 x 29 1/2 in.	P
A-15	Ferriss	36 x 30 in.	T & P
B-1	Unknown Architect	51 x 36 in.	T & P
B-2	Entwistle	72 x 95 in.	P
B-3	Entwistle	72 x 50 in.	P
B-4	Poelzig	72 x 54 in.	T
B-5	Poelzig	72 x 132 in.	P
B-6	Poelzig	72 x 54 in.	T
B-7	Poelzig	72 x 108 in.	P
B-8	Mazet	72 x 54 in.	T & P
B-9	Mazet	72 x 96 in.	P
B-10	Soleri	30 x 40 1/2 in.	T
B-11	Soleri	30 x 54 1/2 in.	P
B-12	Soleri	30 x 102 in.	P
B-13	Soleri	30 x 96 in.	P
B-14	Korda	72 x 36 in.	T
B-15	Korda	40 x 54 in.	P
B-16	Korda	72 x 60 in.	P

The Museum of Modern Art Archives, NY	Collection:	Series.Folder:
	MoMA Exhs.	670.30

Exhibition: VISIONARY ARCHITECTURE

Check List p. 2

<u>Cat. No.</u>	<u>Architect</u>	<u>Dimensions: height precedes width</u>	<u>Type of Panel</u>
C-1	Doesburg	72 x 48 in.	T & P
C-2	Finsterlin	72 x 48 in.	T & P
C-3	Kikutake	72 x 30 in.	T
C-4	Kikutake	72 x 67 in. in.	P
C-5	Issitzky	72 x 58 in.	P
C-6	Webb	72 x 111 in.	P
C-7	Webb	72 x 24 in.	T & P
C-8	Webb	72 x 46 in.	P
C-9	Katavolos	72 x 30 in.	T
C-10	Katavolos	78 x 78 in.	P & P
C-11	Soleri	72 x 24 in.	T
C-12	Soleri	72 x 45 1/2 in.	P & P
C-13	Soleri	72 x 60 in.	P
C-14	Fuller <i>Oben & Side</i>	24 x 13 in. in.	T
C-15	Fuller <i>Oben & Side</i>	72 x 43 in.	P
C-16	Kahn <i>Oben & Side</i>	72 x 114 in.	P
C-17	Kahn <i>Oben & Side</i>	72 x 36 in. in.	T
C-18	Kahn <i>Oben & Side</i>	72 x 24 in.	T
C-19	Kahn <i>Oben & Side</i>	72 x 52 in.	P
C-20	Kahn <i>Oben & Side</i>	40 x 31 in.	P
D-1	Taut <i>Oben & Side</i>	30 x 29 in.	T
D-2	Taut <i>Oben & Side</i>	30 x 24 1/2 in.	P
D-3	Taut <i>Oben & Side</i>	30 x 24 in.	P
D-4	Taut	30 x 25 1/2 in.	P
D-5	Taut	30 x 27 in.	P
D-6	Taut	30 x 25 in.	P
D-7	Taut	TOTAL 30 x 25 in. <i>ending Feet</i>	P
D-8	Taut	30 x 37 1/2 in.	P
E-1	Wright	72 x 38 in.	T
E-2	Wright	72 x 8 1/2 in.	P
E-3	Wright	72 x 6 1/2 in.	P
E-4	Wright	72 x 7 1/4 in.	P
E-5	Wright	258 x 36 in.	P
E-6	Wright	28 x 27 in.	T
E-7	Wright	63 x 268 in.	P
E-8	Wright	63 x 140 in.	P
F-1	Kiesler	72 x 118 in.	P
F-2	Kiesler	72 x 48 in.	T & P
F-3	Kiesler	24 x 28 in.	T
F-4	Kiesler	24 x 34 in.	P
F-5	Kiesler	24 x 34 in.	P
F-6	Kiesler	24 x 34 in.	P
F-7	Kiesler	72 x 118 in.	T & P

The Museum of Modern Art Archives, NY	Collection:	Series.Folder:
	MoMA Exhs.	670.30

Exhibition: VISIONARY ARCHITECTURE

Check List p. 3

January 20, 1960

Cat. No.	Architect	Dimensions: Height precedes width	Type of Panel
F-8	Kiesler	40 x 50 in.	P
F-9	Kiesler	40 x 41 in.	P
F-10	Kiesler	24 x 30 in.	P
F-11	Kiesler	18 x 26 1/2 in.	P
F-12	Kiesler	40 x 61 in.	P
G-1	Kurokawa	72 x 53 in.	T & P
G-2	Corbusier	72 x 40 in.	T
G-3	Corbusier	72 x 268 in.	P
G-4	Corbusier	72 x 89 in.	T & P
G-5	Nelson	72 x 118 in.	P
G-6	Soleri	35 x 92 in.	T & P
G-7	Soleri	35 x 92 in.	P
G-8	Fitzgibbon & Side	34 x 17 1/2 in.	T
G-9	Fitzgibbon & Side	36 x 24 in.	P
G-10	Fitzgibbon & Side	72 x 72 in.	P
G-11	Fitzgibbon & Side	30 x 37 1/2 in.	P
G-12	Fitzgibbon & Side	72 x 72 in.	P
G-13	Malcomson	30 x 30 in.	T
G-14	Malcomson	40 x 33 in.	P
G-15	Malcomson	40 x 50 in.	P
G-16	Malcomson	40 x 24 in.	P
G-17	Malcomson	72 x 118 in.	P

TOTAL: 492 Running Feet

FOR STUDY PURPOSES ONLY. NOT FOR REPRODUCTION.

The Museum of Modern Art Archives, NY	Collection:	Series.Folder:
	MoMA Exhs.	670.30

January 20, 1960

Dublin
Institute of Technology
Chicago, Illinois

DREXLER REQUESTS ELIMINATION PANELS F2 F3 F6 F 11 KIESLER. 05 MALCOMSON
1 UNIDENTIFIED TAUT. ADDITIONS 3 ~~panels~~ KIESLER PANELS. 2 MALCOMSON
1 NELSON. 1 LISSITZKY. THESE AND TAUT SPECIFICATIONS TO FOLLOW MONDAY

McCray
Modernart

[Faint handwritten notes and lists on the yellow paper, including names like 'Lissitzky', 'Kiesler', 'Nelson', and 'Malcomson', and dimensions like '72 x 36' and '36 x 24'. A circled '615' is visible on the right side.]

The Museum of Modern Art Archives, NY	Collection:	Series/Folder:
	MoMA Exhs.	670.30

VISIONARY PANELS to come from
COMPO

A1, A2 Text panels.

B-16 KORDA - Things to come 6' x 5'

^{xy}
D-3 TAUT Alpine Arch 30" x 24"

___? Lissitzky Text & photo panel 72" x ? to come.

^{can be}
~~F3~~ Kiesler - City in Space 72" x ___?

F3 Kiesler - Text & model photos. 72" x 36"

___? Kiesler. Theater Place de la Concord 72" x 36"

___? Nelson Rose photo panel 72" x ___

G 9. Fitzgibbon Bridge City
2 Sides Plan & elevations 36 x 24

G 12 - " General View 72 x 72

___? Malcomson photo of model 50 x ___?

___? " " " 50 x ___?

FOR STUDY PURPOSES ONLY. NOT FOR REPRODUCTION.

The Museum of Modern Art Archives, NY	Collection:	Series.Folder:
	MoMA Exhs.	670.30

2

1

3

48

$26\frac{1}{2}$

$21\frac{1}{4}$

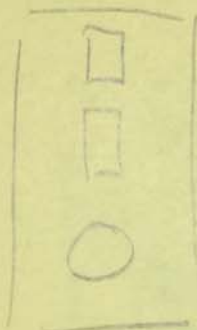

23

$\frac{5}{18}$

30

$15\frac{1}{2}$

$14\frac{1}{2}$

FOR STUDY PURPOSES ONLY. NOT FOR REPRODUCTION.

The Museum of Modern Art Archives, NY	Collection:	Series.Folder:
	MoMA Exhs.	670.30

Lusitzky Text

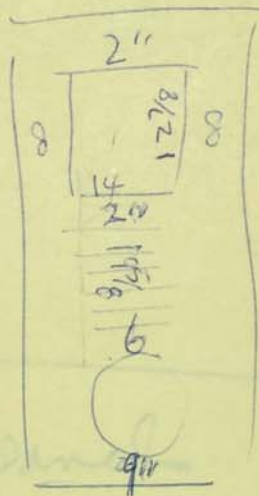

$\frac{2''}{12\frac{3}{8}}$
 $\frac{2}{19\frac{5}{8}}$ text
 $\frac{6''}{20''}$
 $\frac{9}{9}$

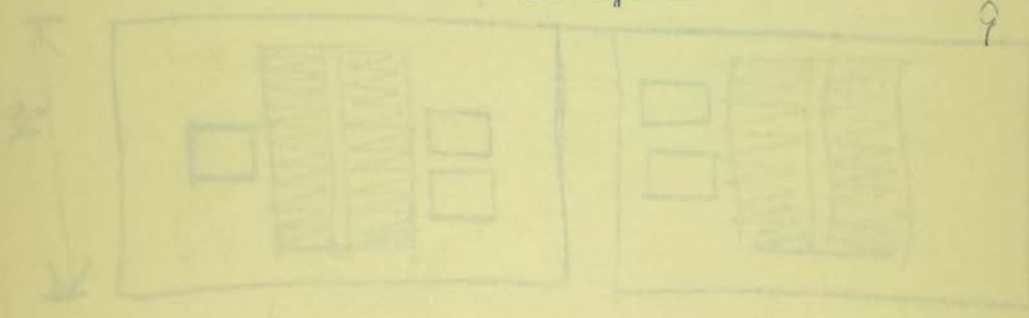

FOR STUDY PURPOSES ONLY. NOT FOR REPRODUCTION.

The Museum of Modern Art Archives, NY	Collection:	Series.Folder:
	MoMA Exhs.	670.30

SENT TO COMPO



B 16 6' x width as file

F 1 6' x width as file

Mendelsohn A1a
factory -
Mies Skyscraper A1b
Goodman (2) A1c
A1d.
Hilberseimer A2a

Text panels

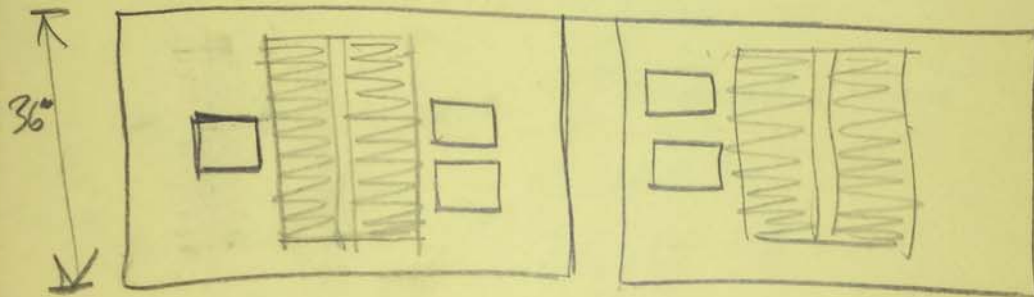

The Museum of Modern Art Archives, NY	Collection:	Series.Folder:
	MoMA Exhs.	670.30

SENT TO COMPO

18-1

KORDA - B 16 6' x width as falls

KIESLER - F 1 Big Interior 6' x width as falls.

[Faint handwritten notes and bleed-through from the reverse side of the page, including names like 'Malcomson', 'View of model', and 'Detail of model']

The Museum of Modern Art Archives, NY	Collection:	Series.Folder:
	MoMA Exhs.	670.30

SENT TO COMPO

118-1

KORDA - B 16 6' x width as falls

KIESLER - F 1 [Big Interior] 6' x width as falls.

The Museum of Modern Art Archives, NY	Collection:	Series/Folder:
	MoMA Exhs.	670.30

A1-A2 Text panels.
to come. 36 x -

G 12. Fitzgibbon & Sides
Bridge City Jan view.
72 x 72 make copy neg.

G 18. Malcomson. "Metrolinear City"
View of model. 50" x 52" make copy neg.

G 19 Malcomson "Metrolinear City"
Detail of model. 50" x 63" make copy neg.

G 20 PAUL Nelson. "Suspended House" 72 x 36

Note

now

G 5A-

A. photo of model. 26" x 3'0" have neg.

B. interior of model 24 1/2" x 3'0"

C. + 21 1/2" paper. → 2-8 x 10 photos mtd. make copy negs on both.

C. exterior

D. interior

G-9. Fitzgibbon & Sides
Bridge City - plan & elevation.
36 x 24 make copy neg.

~~(36 x 28 exact copying)~~

should be 34 1/2 x 27

The Museum of Modern Art Archives, NY	Collection:	Series Folder:
	MoMA Exhs.	670.30

Nelson

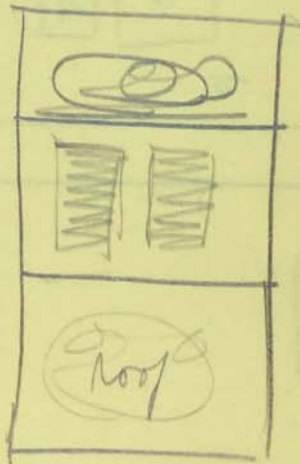
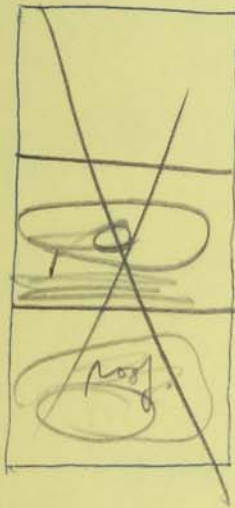
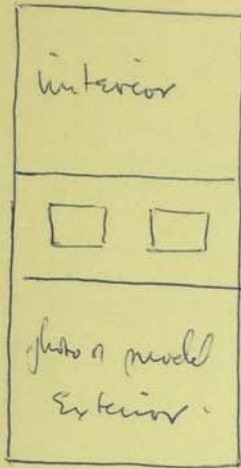

Kiesler

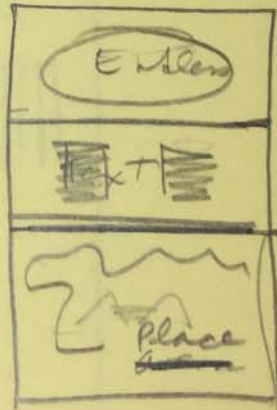

FOR STUDY PURPOSES ONLY. NOT FOR REPRODUCTION.

The Museum of Modern Art Archives, NY	Collection:	Series.Folder:
	MoMA Exhs.	670.30

← 36" →

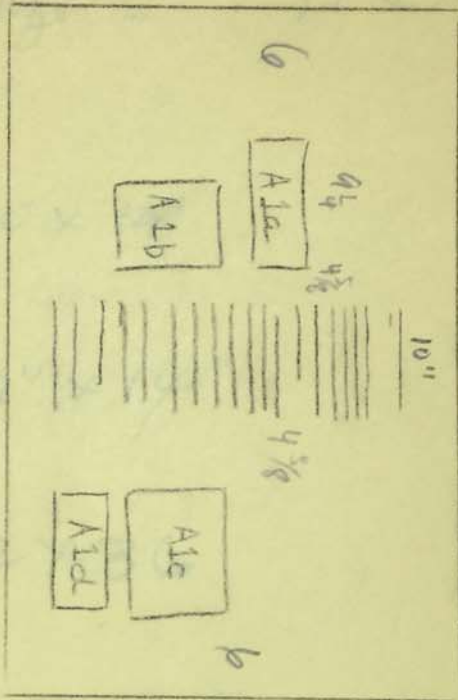

← 48" →

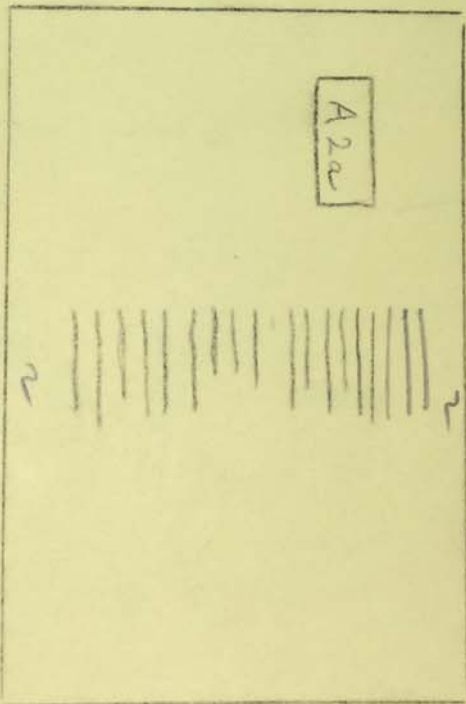

K1-A2 Main floor labels

F 1
D 1
F 13A
F 15
F 19
C 5A

The Museum of Modern Art Archives, NY	Collection:	Series.Folder:
	MoMA Exhs.	670.30

F 1 - final size - 72 x 105" 36
19

D 2 - D - 30" x 14"

7
34 35 1/2
16
19

F 13A - 72" x 14"

9 1/2
9 1/2
11 1/4

F 15 72 x 36

D 44
16

F 14

D 20 32
40

C 5A

D 20

u

~~25 1/2~~
6 1/2
25 1/2
13 1/2
15 1/2

The Museum of Modern Art Archives, NY	Collection:	Series.Folder:
	MoMA Exhs.	670.30

NEW TAUT PANEL #'S.

old.	photo key #.	new
D-1	- Text panel.	D-1
D 2	photo A.	D 2
D 4	B	D 3
D 5	C	D 4.
<u>inter size.</u>	D.	D 5
D 8	E	D 6
D 7	F	D 7
D 8	G.	D 8
D 6		

FOR STUDY PURPOSES ONLY. NOT FOR REPRODUCTION.

The Museum of Modern Art Archives, NY	Collection:	Series.Folder:
	MoMA Exhs.	670.30

Check List

Text panel (Also has photo of THE ART GALLERY) January 17, 1960

Exhibition: Visionary Architecture

Contents: 95 Panels

Dimensions:

60 Photo Panels

All dimensions are in inches with height preceding width.

24 Text Panels

11 Text and Photo Panels

Cat. No.:	Architect:	Subject and date:	Size:	Pkg. No
1- A-1	POLLICCI, Hans	Introductory text	36 x 48"	
2- A-2		Introductory text	36 x 48"	
3- A-3	DAVINCI, Leonardo	IDEAL CITY Photo panel	36 x 48"	
4- A-4	DAVINCI, Leonardo	IDEAL CITY Text panel	36 x 32"	
5- A-5	DAVINCI, Leonardo	IDEAL CITY Photo panel	36 x 27"	
6- A-6	FILARETE	SKYSCRAPER Photo panel	36 x 32"	
7- A-7	FILARETE	Text panel	36 x 27"	
8- A-8	SANT' ELIA, ANTONIO	DESIGNS FOR THE CITY OF THE FUTURE. Photo panel	36 x 35"	
9- A-9	SANT' ELIA, Antonio	Text panel	36 x 36"	
10- A-10	PIRANESI, Giovanni Batista	ACADEMY AND CIVIC CENTER Photo panel	36 x 27 1/2"	
11- A-11	PIRANESI	Text panel (also has photo of PALATIAL INTERIOR)	36 x 24"	
12- A-12	BOULLEE, Etienne-Louis	CENOTAPH FOR ISAAC NEWTON Photo panel	36 x 60"	
13- A-13	BOULLEE	Text panel (also photo of GROUP OF CENOTAPHS)	36 x 30"	
14- A-14	FERRISS, Hugh	THE METROPOLIS OF TOMORROW View looking down from terrace. Photo panel	36 x 29 1/2"	

The Museum of Modern Art Archives, NY	Collection:	Series.Folder:
	MoMA Exhs.	670.30

VISIONARY ARCHITECTURE

Check List

page 2.

15-	A-15	FERRISS, Hugh	Text panel (Also has photo of THE ART CENTER)	36 x 30"
16-	B-1	Unknown	MOUNTAIN CITY Text and photo panel	51 x 36"
17-	B-2	ENTWISTLE, Clive	CIVIC CENTER and CRYSTAL PALACE. Photo panel	72 x 95"
18-	B-3	ENTWISTLE, Clive	METROPOLITAN CATHEDRAL OF CHRIST THE KING. Photo panel	72 x 50"
19-	B-4	POELZIG, Hans	FESTIVAL HALL, Salzburg Text panel	72 x 54"
20-	B-5	POELZIG, Hans	FESTIVAL HALL, Salzburg Photo panel	72 x 132"
21-	B-6	POELZIG, Hans	FRIENDSHIP HOUSE, Istambul Text panel	72 x 54"
22-	B-7	POELZIG, Hans	FRIENDSHIP HOUSE, Istambul Photo panel	72 x 108"
23-	B-8	MAZET, Jean-Claude	IDEAL CITY Text and small photos panel	72 x 54"
24-	B-9	MAZET, Jean-Claude	IDEAL CITY Photo panel	72 x 96"
25-	B-10	SOLERI, Paolo	MESA BIOTECHNIC CITY Text panel	30 x 40 1/2"
26-	B-11	SOLERI, Paolo	MESA BIOTECHNIC CITY (Plan) Photo panel	30 x 54 1/2"
27-	B-12	SOLERI, Paolo	MESA BIOTECHNIC CITY (Cross section drawing - Entrance & Temples) Photo panel	30 x 102"
28-	B-13	SOLERI, Paolo	MESA BIOTECHNIC CITY (Cross section drawing - Shrine & Museum) Photo panel	30 x 96"
29-	B-14	KORDA, Vincent	STAGE SET--THINGS TO COME Text panel	72 x 36"
30-	B-15	KORDA, Vincent	STAGE SET--THINGS TO COME Photo panel	40 x 54"
31-	B-16	KORDA, Vincent	STAGE SET--THINGS TO COME Photo panel	72 x 60"

The Museum of Modern Art Archives, NY	Collection:	Series.Folder:
	MoMA Exhs.	670.30

VISIONARY ARCHITECTURE		Check List	page 3.
32 -	C-1	DOESBURG, Theo VAN GROUP OF SKYSCRAPERS Photo & text panel	72 x 48"
33 -	C-2	FINSTERLIN, Hermann IDEAL BUILDING Photo & Text panel	72 x 48"
34 -	C-3	KIKUTAKE, Kiyonori MARINE CITY Text panel	72 x 30"
35 -	C-4	KIKUTAKE, Kiyonori MARINE CITY Photo panel	72 x 67"
36 -	C-5 C-5A	LISSITZKY, El Lissitzky - DER WOLKENBÜGEL Photo panel	72 x 58" 1/2" 72 x 30"
37 -	C-6	WEBB, Michael OFFICE BUILDING (Side Elevation) Photo panel	72 x 111"
38 -	C-7	WEBB, Michael OFFICE BUILDING Text panel	72 x 24"
39 -	C-8	WEBB, Michael OFFICE BUILDING (End Elevation) Photo panel	72 x 46" 30 x 37 1/2"
40 -	C-9	KATAVOLOS, William CHEMICAL ARCHITECTURE Text panel	72 x 30"
41 -	G-10	KATAVOLOS, William CHEMICAL ARCHITECTURE Photo panel	78 x 78"
42 -	C-11	SOLERI, Paolo THEOLOGICAL CENTER OF BIO- TECHNIC CITY. Text panel	72 x 24"
43 -	C-12	SOLERI, Paolo THEOLOGICAL CENTER OF BIO- TECHNIC CITY. Photo panel	72 x 45 1/2" 72 x 7 1/2"
44 -	C-13	SOLERI, Paolo THEOLOGICAL CENTER OF BIO- TECHNIC CITY. Photo panel	72 x 60" 36 x 36"
45 -	C-14	FULLER, Buckminster PARTIAL ENCLOSURE OF MAN- HATTAN ISLAND. Text panel	24 x 13"
46 -	C-15	FULLER, Buckminster PARTIAL ENCLOSURE OF MAN- HATTAN ISLAND. Photo panel	28 3/4 x 27"
47 -	C-16	KAHN, Louis CENTER CITY Photo panel	72 x 114"
48 -	C-17	KAHN, Louis CENTER CITY Text panel	72 x 36"
49 -	C-18	KAHN, Louis CITY TOWER Text panel	72 x 24"

The Museum of Modern Art Archives, NY	Collection:	Series.Folder:
	MoMA Exhs.	670.30

VISIONARY ARCHITECTURE		Check List	page 3.
32 -	C-1	DOESBURG, Theo VAN GROUP OF SKYSCRAPERS Photo & text panel	72 x 48"
33 -	C-2	FINSTERLIN, Hermann IDEAL BUILDING Photo & Text panel	72 x 48"
34 -	C-3	KIKUTAKE, Kiyonori MARINE CITY Text panel	72 x 30" 2h 1/2"
35 -	C-4	KIKUTAKE, Kiyonori MARINE CITY Photo panel	72 x 67"
36 -	C-5 C-5A	LISSITZKY, El Lissitzky - DER WOLKENBÜGEL Photo panel	72 x 58" 1/2" 72 x 30"
37 -	C-6	WEBB, Michael OFFICE BUILDING (Side Elevation) Photo panel	72 x 111"
38 -	C-7	WEBB, Michael OFFICE BUILDING Text panel	72 x 24"
39 -	C-8	WEBB, Michael OFFICE BUILDING (End Elevation) Photo panel	72 x 46" 30 x 37 1/2"
40 -	C-9	KATAVOLOS, William CHEMICAL ARCHITECTURE Text panel	72 x 30"
41 -	G-10	KATAVOLOS, William CHEMICAL ARCHITECTURE Photo panel	72 x 30" 78 x 78"
42 -	C-11	SOLERI, Paolo THEOLOGICAL CENTER OF BIO- TECHNIC CITY. Text panel	72 x 24" 72 x 6 7/8"
43 -	C-12	SOLERI, Paolo THEOLOGICAL CENTER OF BIO- TECHNIC CITY. Photo panel	72 x 45 1/2" 72 x 7 1/8"
44 -	C-13	SOLERI, Paolo THEOLOGICAL CENTER OF BIO- TECHNIC CITY. Photo panel	72 x 60" 359 x 36"
45 -	C-14	FULLER, Buckminster PARTIAL ENCLOSURE OF MAN- HATTAN ISLAND. Text panel	24 x 13" 28 3/4 x 27"
46 -	C-15	FULLER, Buckminster PARTIAL ENCLOSURE OF MAN- HATTAN ISLAND. Photo panel	72 x 43" 63 x 36"
47 -	C-16	KAHN, Louis CENTER CITY Photo panel	72 x 114" 63 x 36"
48 -	C-17	KAHN, Louis CENTER CITY Text panel	72 x 36"
49 -	C-18	KAHN, Louis CITY TOWER Text panel	72 x 24"

The Museum of Modern Art Archives, NY	Collection:	Series.Folder:
	MoMA Exhs.	670.30

VISIONARY ARCHITECTURE

Check List

page 4.

50-	C-19	KAHN, Louis	CITY TOWER Photo panel	72 x 52"
51-	D-1	TAUT, Bruno	ALPINE ARCHITECTURE Text panel	30 x 29"
52-	D-2	TAUT, Bruno	ALPINE ARCHITECTURE Photo panel	30 1/2 x 24 1/2"
53-	D-3	TAUT, Bruno	To be added (waiting)	30 x 24"
54-	D-4	TAUT, Bruno	ALPINE ARCHITECTURE Photo panel	30 x 25 1/2"
55-	D-5	TAUT, Bruno	ALPINE ARCHITECTURE Photo panel	30 x 27"
56-	D-6	TAUT, Bruno	ALPINE ARCHITECTURE Photo panel	30 x 25"
57-	D-7	TAUT, Bruno	ALPINE ARCHITECTURE Photo panel	30 x 25"
58-	D-8	TAUT, Bruno	ALPINE ARCHITECTURE Photo panel	30 x 37 1/2"
59-	E-1	WRIGHT, Frank Lloyd	MILE HIGH SKYSCRAPER Text panel	72 x 38"
60-	E-2	WRIGHT, Frank Lloyd	MILE HIGH SKYSCRAPER Photo panel	72 x 8 3/4"
61-	E-3	WRIGHT, Frank Lloyd	MILE HIGH SKYSCRAPER Photo panel	72 x 6 7/8"
62-	E-4	WRIGHT, Frank Lloyd	MILE HIGH SKYSCRAPER Photo panel	72 x 7 1/4"
63-	E-5	WRIGHT, Frank Lloyd	MILE HIGH SKYSCRAPER Photo panel	75 x 36"
64-	E-6	WRIGHT, Frank Lloyd	A CIVIC CENTER FOR PITTSBURGH. Text panel	28 3/4 x 27"
65-	E-7	WRIGHT, Frank Lloyd	A CIVIC CENTER FOR PITTSBURGH. Photo panel(sec.)	63 x 268"
66-	E-8	WRIGHT, Frank Lloyd	A CIVIC CENTER FOR PITTSBURGH. Photo panel(aerial)	63 x 140"

The Museum of Modern Art Archives, NY	Collection:	Series.Folder:
	MoMA Exhs.	670.30

VISIONARY ARCHITECTURE

Check List

page 5.

67-	F-1	KIESLER, Frederick	ENDLESS HOUSE <i>large interior</i> Photo panel	72 x 48"
68-	F-2	KIESLER, Frederick	CITY IN SPACE Photo and text panel	72 x 48"
69-	F-3	KIESLER, Frederick	ENDLESS HOUSE <i>WHITE BRIDGE</i> Text panel-Arthur Drexler	24 x 28"
70-	F-4	KIESLER, Frederick	ENDLESS HOUSE <i>WHITE BRIDGE</i> (Section drawing) Photo panel	24 x 34"
71-	F-5	KIESLER, Frederick	ENDLESS HOUSE (Front elevations 2nd scheme (1)) Photo panel	24 x 34"
72-	F-6	KIESLER, Frederick	ENDLESS HOUSE (West Elevations) Photo panel	24 x 34"
73-	F-7	KIESLER, Frederick	ENDLESS HOUSE Photo panel (w. Ridge)	72 x 108"
74-	F-8	KIESLER, Frederick	ENDLESS HOUSE (Living Rm-Barrows-photo) Photo panel	40 x 50"
75-	F-9	KIESLER, Frederick	ENDLESS HOUSE (view toward din. rm.) Photo panel	40 x 41"
76-	F-10	KIESLER, Frederick	ENDLESS HOUSE (Barrows-photo) Photo panel	24 x 30"
77-	F-11	KIESLER, Frederick	ENDLESS HOUSE (View fr bedrm.-Barrows) Photo panel	18 x 26 1/2"
78-	F-12	KIESLER, Frederick	ENDLESS HOUSE (Barrows-photo) Photo panel	40 x 61"
79-	G-1	KUROKAWA, Noriaki	AGRICULTURAL CITY Photo & Text panel	72 x 53"
80-	G-2	LE CORBUSIER	COMBINED ROAD AND BUILDING FOR RIO DE JANEIRO. Text panel	72 x 40"
81-	G-3	LE CORBUSIER	COMBINED ROAD AND BUILDING FOR RIO DE JANEIRO. Photo panel	72 x 268"

37 1/2 x 28

The Museum of Modern Art Archives, NY	Collection:	Series.Folder:
	MoMA Exhs.	670.30

VISIONARY ARCHITECTURE

Check List

Page 6.

82-	G-4	LE CORBUSIER	COMBINED BUILDING AND ROAD FOR ALGIERS. Photo & text panel	72 x 89"	
83-	G-5	NELSON, Paul	SUSPENDED HOUSE Text panel	72 x 118"	
84-	G-6	SOLERI, Paolo	LONG SPAN CONCRETE BRIDGE Photo & text panel	35 x 92"	
85-	G-7	SOLERI, Paolo	LONG SPAN CONCRETE BRIDGE Photo panel	35 x 92"	
86-	G-8	FITZGIBBON & SIDES	BRIDGE CITY Text panel	34 1/2 x 17 1/2"	
87-	G-9	FITZGIBBON & SIDES	BRIDGE CITY (Plan & Elevation) Photo panel	36 x 24"	check new dimension
88-	G-10	FITZGIBBON & SIDES	BRIDGE CITY Photo panel	72 x 72"	
89-	G-11	FITZGIBBON & SIDES	BRIDGE CITY (group of Apt. Bldgs) Photo panel	30 x 37 1/2"	
90-	G-12	FITZGIBBON & SIDES	BRIDGE CITY (General view) Photo panel	72 x 72"	
91-	G-13	MALCOMSON, Reginald	METRO LINEAR CITY Text panel	30 x 30"	
92-	G-14	MALCOMSON, Reginald	METRO LINEAR CITY (Plans) Photo panel	40 x 33"	
93-	G-15	MALCOMSON, Reginald	METRO LINEAR CITY (Plan) Photo panel	40 x 50"	cancel
94-	G-16	MALCOMSON, Reginald	METRO LINEAR CITY (Cross section) Photo panel	40 x 24"	
95-	G-17	MALCOMSON, Reginald	METRO LINEAR CITY (Drawing of buildings) Photo panel	72 x 108"	

The Museum of Modern Art Archives, NY	Collection:	Series.Folder:
	MoMA Exhs.	670.30

Victory Panels to Elmhurst
Mendelssohn #1 ^{A1} a

Mies - #6 ^{A1} b

Goodman -
bldg along river #3 ^{A1} c
bldg around site #4 ^{A1} d.

Halberstamer #5 ^{A2} a

Elm P 2, 3

The Museum of Modern Art Archives, NY	Collection:	Series.Folder:
	MoMA Exhs.	670.30

Visionary Panels to Eliminate

? - BRUNO TAUT.

F 6 Plans & Elevations (1)

F 11 Fuzzy pale photo

} Kiesler.

~~F 15~~ Malcomson.

Elim F 2, 3

see
new sizes
