

## CONDITIONS OF USE FOR THIS PDF

The images contained within this PDF may be used for private study, scholarship, and research only. They may not be published in print, posted on the internet, or exhibited. They may not be donated, sold, or otherwise transferred to another individual or repository without the written permission of The Museum of Modern Art Archives.

When publication is intended, publication-quality images must be obtained from SCALA Group, the Museum's agent for licensing and distribution of images to outside publishers and researchers.

If you wish to quote any of this material in a publication, an application for permission to publish must be submitted to the MoMA Archives. This stipulation also applies to dissertations and theses. All references to materials should cite the archival collection and folder, and acknowledge "The Museum of Modern Art Archives, New York."

Whether publishing an image or quoting text, you are responsible for obtaining any consents or permissions which may be necessary in connection with any use of the archival materials, including, without limitation, any necessary authorizations from the copyright holder thereof or from any individual depicted therein.

In requesting and accepting this reproduction, you are agreeing to indemnify and hold harmless The Museum of Modern Art, its agents and employees against all claims, demands, costs and expenses incurred by copyright infringement or any other legal or regulatory cause of action arising from the use of this material.

### **NOTICE: WARNING CONCERNING COPYRIGHT RESTRICTIONS**

The copyright law of the United States (Title 17, United States Code) governs the making of photocopies or other reproductions of copyrighted material. Under certain conditions specified in the law, libraries and archives are authorized to furnish a photocopy or other reproduction. One of these specified conditions is that the photocopy or reproduction is not to be "used for any purpose other than private study, scholarship, or research." If a user makes a request for, or later uses, a photocopy or reproduction for purposes in excess of "fair use," that user may be liable for copyright infringement.

FOR STUDY PURPOSES ONLY. NOT FOR REPRODUCTION.

The Museum of Modern Art Archives, NY	Collection:	Series.Folder:
	MoMA Exhs.	1623.15

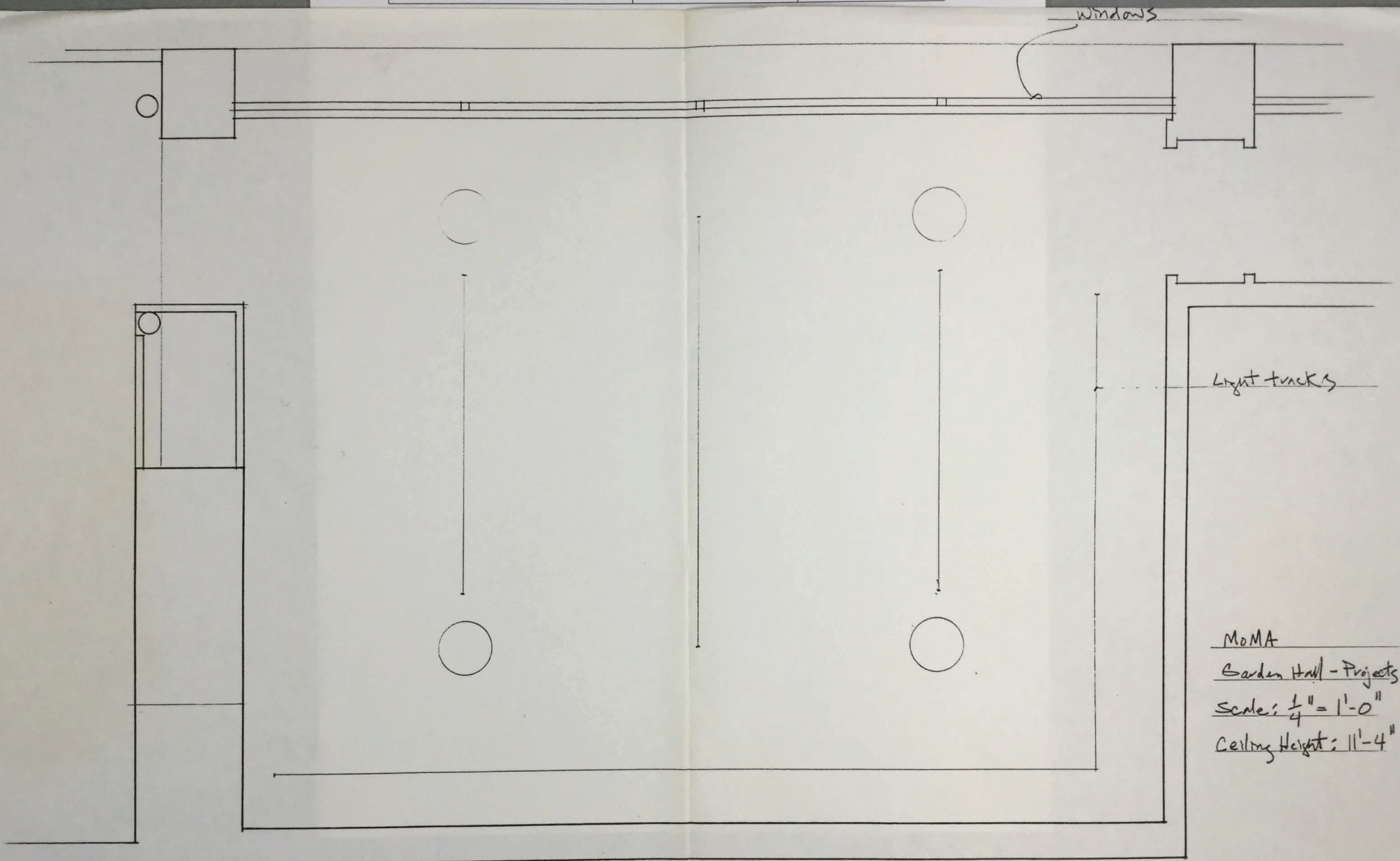

MoMA  
Garden Hall - Projects  
Scale:  $\frac{1}{4}" = 1'-0"$   
Ceiling Height: 11'-4"

FOR STUDY PURPOSES ONLY. NOT FOR REPRODUCTION.

The Museum of Modern Art Archives, NY	Collection:	Series.Folder:
	MoMA Exhs.	1623.15

South wall of Projects Gallery

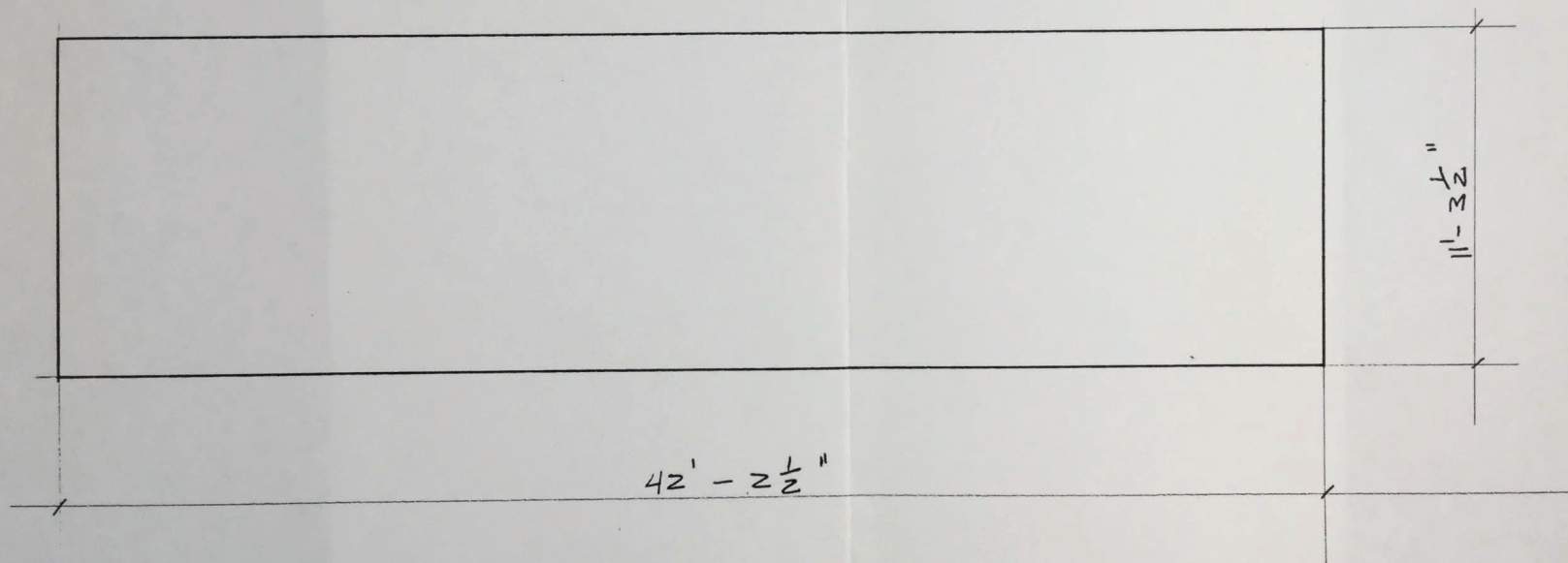

**FOR STUDY PURPOSES ONLY. NOT FOR REPRODUCTION.**

The Museum of Modern Art Archives, NY	Collection:	Series.Folder:
	MoMA Exhs.	1623.15

## The Museum of Modern Art • Exhibition Production Schedule

Title..... **Projects: Felix Gonzalez-Torres / 2596**

Location.....**Garden Hall Gallery**

[illegible]

Notes:

1. Dismantling of Allegories exhibition to begin at 6 PM.  
Work should be kept to a minimum during the Tapies Press Preview starting at 11 AM on Wed, May 6.
2. Demolition and clean-up to be complete by 11 AM.
3. Billboard to be installed by outside contractor in the afternoon of May 13th.
4. Opening Reception: 6-8 PM

FOR STUDY PURPOSES ONLY. NOT FOR REPRODUCTION.

The Museum of Modern Art Archives, NY	Collection:	Series, Folder:
	MOMA Exhs.	1623.15



FOR STUDY PURPOSES ONLY. NOT FOR REPRODUCTION.

The Museum of Modern Art Archives, NY	Collection:	Series/Folder:
	MoMA Exhs.	1623.15

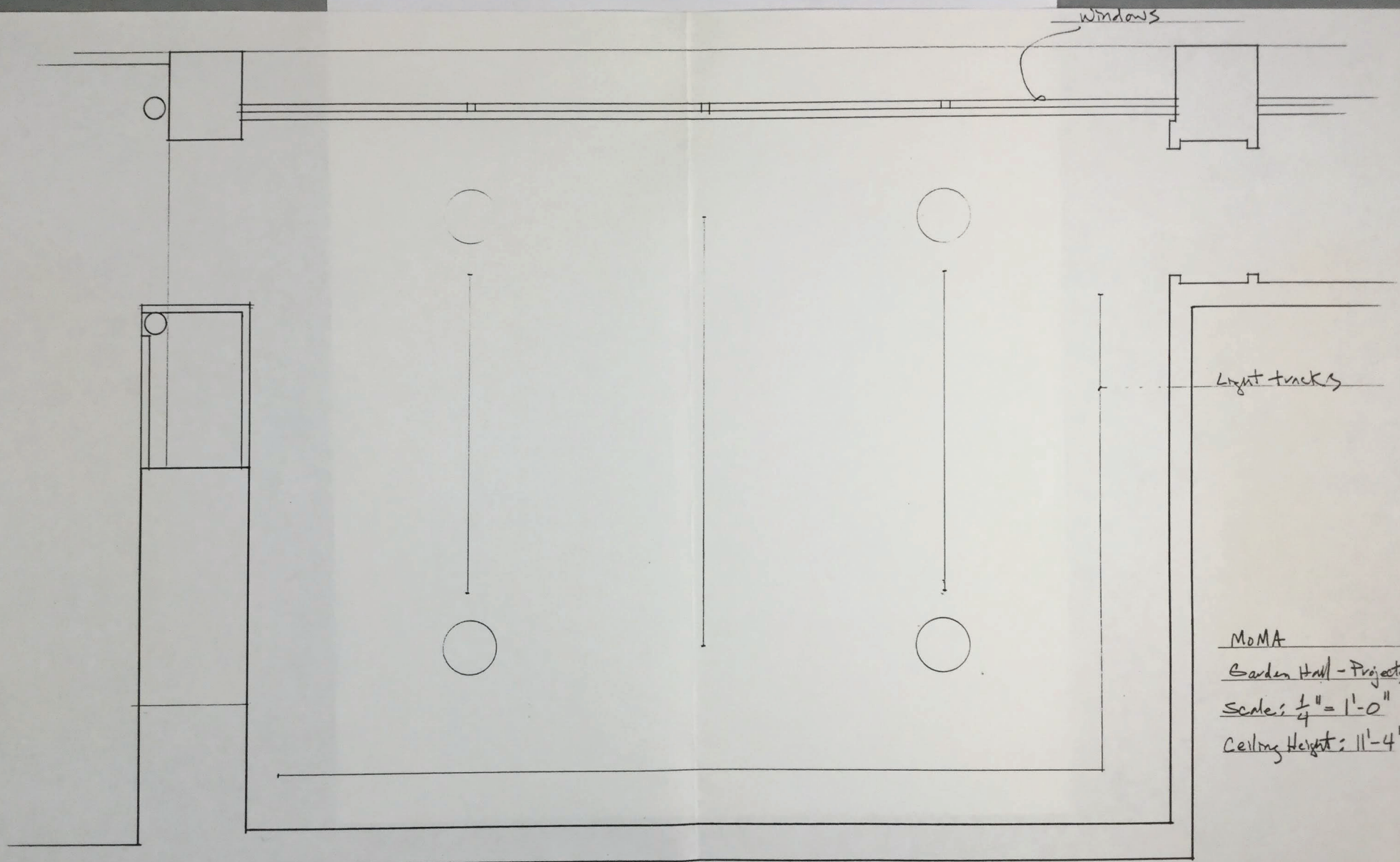

MoMA  
Garden Hall - Projects  
Scale:  $\frac{1}{4}'' = 1'-0''$   
Ceiling Height: 11'-4''

FOR STUDY PURPOSES ONLY. NOT FOR REPRODUCTION.

The Museum of Modern Art Archives, NY	Collection:	Series.Folder:
	MoMA Exhs.	1623.15

South wall of Projects Gallery

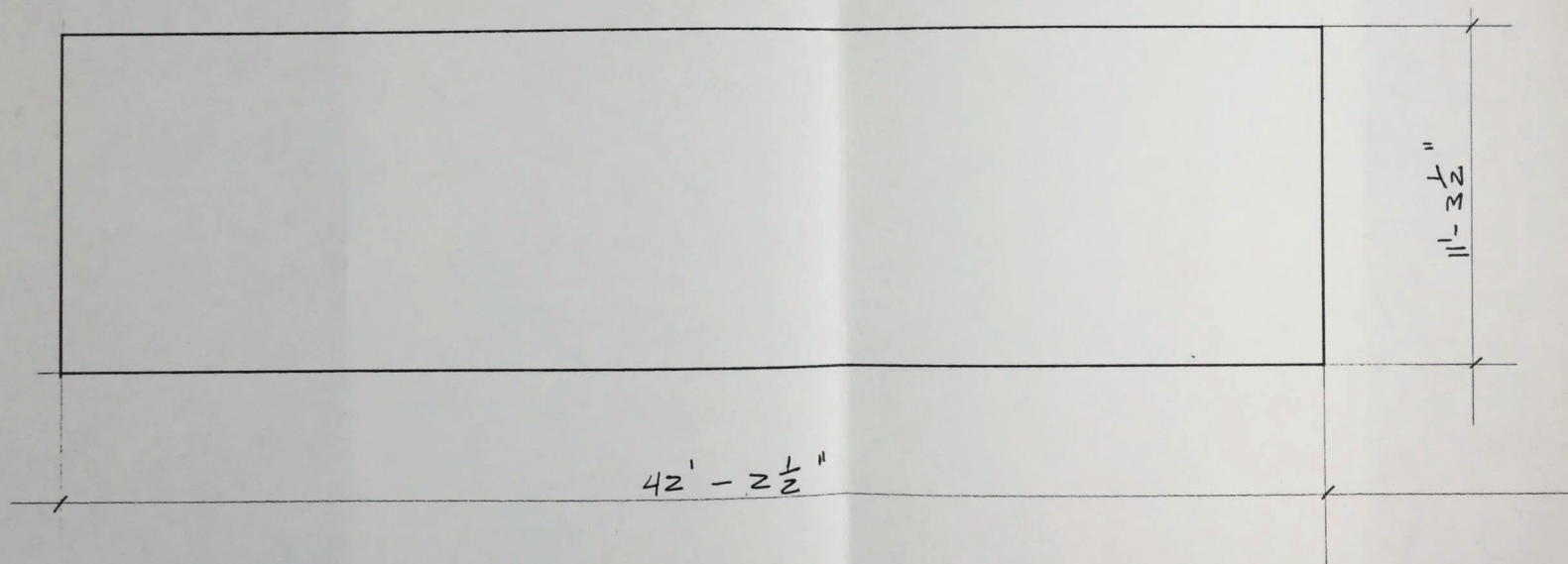

The Museum of Modern Art Archives, NY	Collection:	Series.Folder:
	MoMA Exhs.	1623.15

[notes from F.G.-P.] 3.27.92

artist will be available week of May 11<sup>th</sup>

might want different white, could  
he see paint chips (bone white,  
liked color in Day w/out art)

liked lighting for Day w/out art  
garden

wants it to look like a room

will place on scale drawing

brochure box in gallery

(other benches around like Hank's bench)

doesn't have to be perfect, not art

The Museum of Modern Art Archives, NY	Collection:	Series.Folder:
	MoMA Exhs.	1623.15

[notes from L.G.-P.] 3.27.92

artist will be available week of May 11<sup>th</sup>

might want different white, could  
he see painted chips (bone white,  
liked color in Day w/out art)

liked lighting for Day w/out art  
garden

wants it to look like a room

will place on scale drawing

brochure box in gallery

(other benches around like Mau's bench)

doesn't have to be perfect, not art

The Museum of Modern Art Archives, NY	Collection:	Series/Folder:
	MoMA Exhs.	1623.15

Jerry Neuner x 425 (spoke with John Schwenke) 3.18.92

Tom Dehler (#275") 2 men/half day  
 seems like they could do it  
 likely to be some trimming, right side +  
 bottom side  
 sizing on wall first (clean unprotected  
 edge on white wall)  
 paper does stretch, based on amt. of  
 ink in different areas  
 regular time/hours  
 artist, printer - what is overlap,  
 trimming, industrial format +  
 art space  
 technicians - diary / maybe, for #275 we won't have  
 (paperhanger \$3000<sup>00</sup>) ask for better <sup>best</sup> new a lot of say  
 depends on image - where are things  
 not aligning  
 how perfect does it have to be?  
 can F&T be there for install?  
 will have to place on scale  
 drawing of wall  
 then size that area of wall  
 prep. surface  
 we could draw bench line